

THICK DOOR HINGE - SOFT CLOSE

Special Features

- Available in Full Overlay, Half Overlay & Inset.
- Soft Close mechanism prevents shutter from banging.
- Max. Opening : 95°.
- Max. Shutter size : 34" x 22" (850mm x 550mm) for 2 Hinges.
- Shutter Thickness : 18mm to 40mm.
- Shutter Cavity : Ø40mm, 14 deep, Cavity from edge as shown in Fig. 1



Specifications

Code Nos.	Model	'L' mm	Finish
HTD1-SC	Full Overlay	37.0	NP
HTD2-SC	Half Overlay	37.0	
HTD3-SC	Inset	37+S	

S=Thickness of shutter

Fitting Instructions

1. Drill out the cavity in the shutter as per the dimensions in Fig. 1.
2. Fit the cap into the shutter cavity and screw on the hinge at right angle to the edge of the shutter.
3. Mark holes in the cabinet for mounting plate as per Fig. 2 and screw on the mounting plate.
4. Now, align the shutter with the cabinet and click-on to the mounting plate. Any play or gap in cabinet can be adjusted in the bracket.
5. By loosening the bracket screws, the shutter can slide horizontally and also be pivoted for varying pressure.

D	K	3	4	5	6	7	8	9	10	11	12	13
Overlay		18	19	20	21	22	23	24	25	26	27	28
Half Overlay		9	10	11	12	13	14	15	16	17	18	19
Inset		-3	-4	-5	-6	-7	-8	-9	-10	-11	-12	-13

FULL OVERLAY

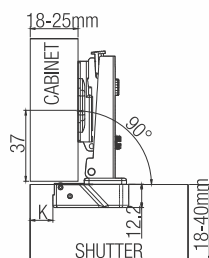

HALF OVERLAY

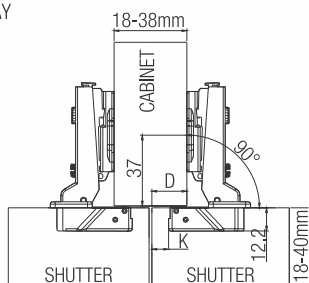

INSET

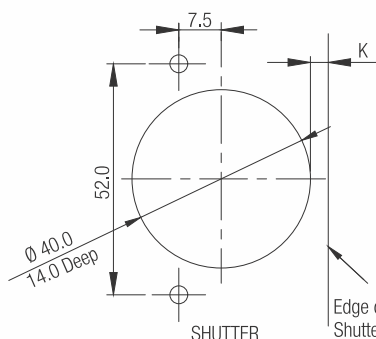
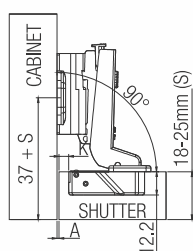

Fig.1

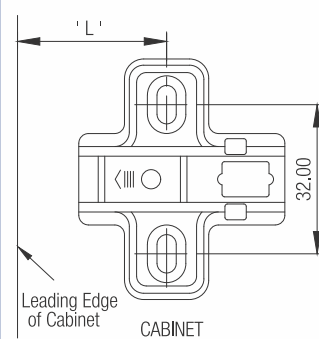
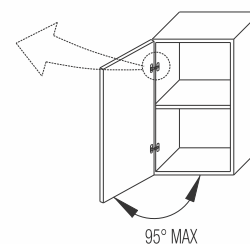
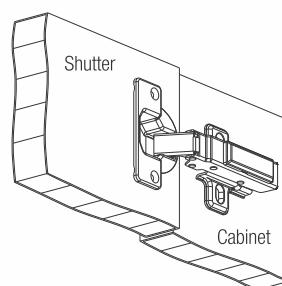

Fig.2



Caution

For efficiency and durability.

- To avoid damage to hinge, do not force the door to exceed 95°.
- Do not apply paint or polish.
- Hinges must be parallel.
- The hinge must not be hammered.