

Special Features

- First housing made of STEEL
- Linear cam profile for smooth tightening and excellence dowel pull-up
- Half turnlocking with no gap between panels.



EBCO GENERAL
HARDWARE



Design Reg. No: 309775/
Application No- 309776

Item	Code Nos.	A	B	C	D	E	F
Steelfix Housing	SF12-ZW	9,5	6,0	12,0	10	6,0	6,0
	SF16-ZW/NP	11,5	8,0	16,0	12	8,0	8,0
	SF16-V	11,95	8,0	16,0	12	8,0	8,0
	SF18-ZW	12,5	9,0	18,0	13	9,0	9,0
	SF18-V	13,15	9,0	18,0	13,5	9,0	9,0

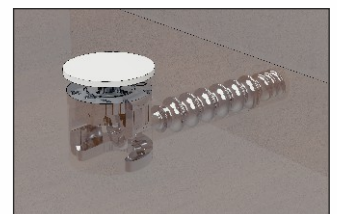

Plastic cap available in white, brown, black, Silver, anthracite & beige to Cover the housing.



Item	Code No.
Cap for Steelfix	STC1
	STC1-V

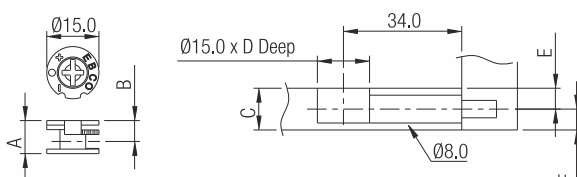



Item	Code Nos.	A	B	C	D	E	F
Mini Fix Housing	MF12	9.8	6.0	12.0	10	6.0	6.0
	MF16	11.8	8.0	16.0	12	8.0	8.0
	MF16-I-N	11.8	8.0	16.0	12	8.0	8.0
	MF18	13.8	9.0	18.0	14	9.0	9.0
	MF18-I-N	13.8	9.0	18.0	13.5	9.0	9.0
	MF25	17.5	12.5	25.0	17.5	12.5	12.5

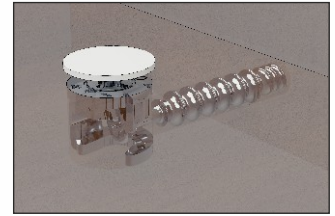

Item	Code No.
Cap for Mini fix	MFC1
	MFC2

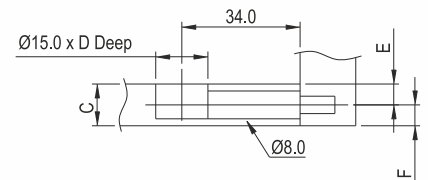
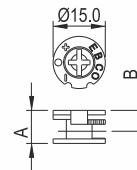

Item	Code Nos.	'A' mm	'B' mm	Finish
Dowels	DP620	Ø6	20.0	Wooden
	DP625	Ø6	25.0	
	DP630	Ø6	30.0	
	DP635	Ø6	35.0	
	DP830	Ø8	30.0	
	DP835	Ø8	35.0	
	DP840	Ø8	40.0	

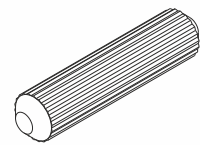

TYPICAL PROPERTIES

Shear Strength	60 N/mm ²
Compressive Strength	103 N/mm ²



Item	Code No.
Eco screw-7mmDia	MFES7-I

Board THK A(mm)	B(mm)	C(mm)
12	6	10
16	8	12
18	9	13
25	12.5	17.5



Design Reg. No: 200042

Item	Code No.
7mmDia Screw(I)	MFS7-I



Item	Code No.
7mmDia Screw25(I)	MFS725-I

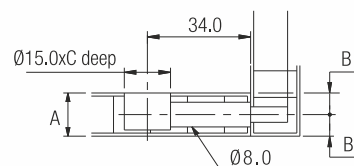

Item	Code No.
7mm Dia Rotor Screw(I)	MFR7-I



Item	Code No.
M6 Screw - Eco	MFESM6-I2



Item	Code No.
M6 Screw (I)	MFMSM6-I2



Item	Code No.
M6 Screw - 25 (I)	MFMS625-I



Design Reg. No: 200043

Item	Code No.
M6 Rotor Screw (I)	MFRM6-I2

Board THK A (mm)	B (mm)	C (mm)
12	6	10
16	8	12
18	9	13
25	12.5	17.5

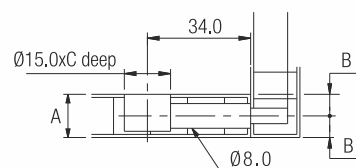
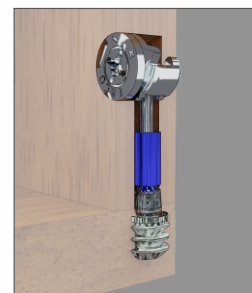

Item	Code No.	A	B
M6 Dowel - Ø10	MFD610	11	10



Item	Code No.	A	B
Dowel Expando-611	MFDE611-I	11	10



Item	Code No.	A	B
M6 Dowel - Ø8	MFD608	10	08



Item	Code No.	A	B
M6 Dowel - Ø10 (I)	MFD610-2	11	10

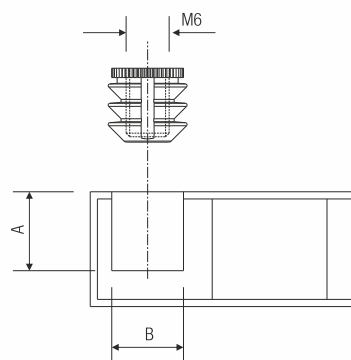

Assembly:

Step 1

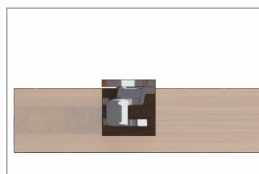

Step 2

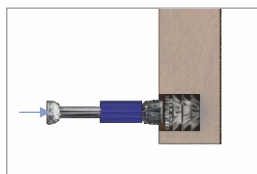

Step 3

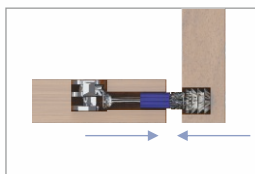

Step 4

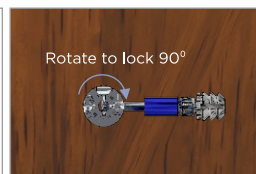

Step 5

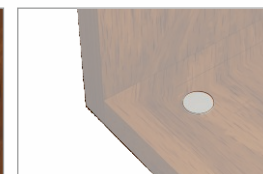

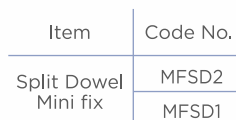

Board THK A (mm)	B (mm)	C (mm)
12	6	10
16	8	12
18	9	13

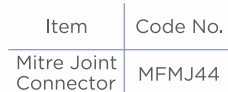
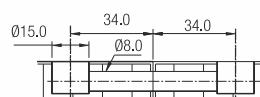
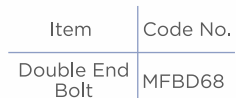
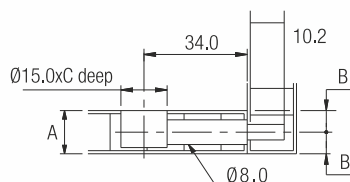
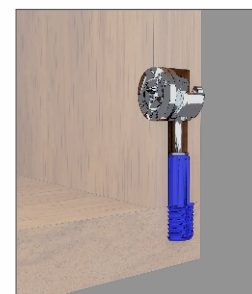

Drilling Diagram for Mitre Joint Connector

Mitre Angle	Board Thickness 'A' (mm)		
	12	16	18
	Inset Distance (mm)		
45°	50.0	52.0	54.0
50°	49.0	50.7	51.6
55°	48.2	49.6	50.3
60°	47.5	48.6	49.2
65°	46.8	47.7	48.2
67.5°	46.5	47.3	47.7
70°	46.2	46.9	47.3

Mitre Angle	Board Thickness 'A' (mm)		
	12	16	18
	Inset Distance (mm)		
75°	45,6	46,1	46,4
80°	45,0	45,4	45,6
85°	44,5	44,7	44,8
90°	44	44	44
'B'	6,0	8,0	9,0
'C'	10,0	12,0	14,0

