

ROLL TOP PRO - VERTICAL

Special Features

- Designed to give complete opening in cabinets.
- Great alternative to traditional hinged or sliding doors.
- This new Roll top Pro series comes with an advanced spring loaded cartridge for easy operation and counter weight balancing as well as increase in life cycle.
- Easy to install & offer a wide range of different solutions with a complete series of accessories.
- Available in various finishes.



Specifications

Code Nos.	Size (mm)	W'1	Finish	Drilling Diagram to refer
RTPV-45130-SL	450(W) x 1300(H)	414	SL	1
RTPV-45130-SF	450(W) x 1300(H)	414	SF	1
RTPV-45130-FG	450(W) x 1300(H)	414	FG	2
RTPV-45130-BL	450(W) x 1300(H)	414	BL	2
RTPV-45135-GW	450(W) x 1350(H)	414	GW	2
RTPV-45130-AT	450(W) x 1300(H)	414	AT	1
RTPV-45130-MC	450(W) x 1300(H)	414	MC	2
RTPV-60130-SL	600(W) x 1300(H)	564	SL	1
RTPV-60130-FW	600(W) x 1300(H)	564	FW	1
RTPV-60130-AT	600(W) x 1300(H)	564	AT	1
RTPV-60130-SF	600(W) x 1300(H)	564	SF	1
RTPV-90130-AT	900(W) x 1300(H)	864	AT	1
RTPV-90130-SL	900(W) x 1300(H)	864	SL	1
RTPV-90130-SF	900(W) x 1300(H)	864	SF	1
RTPV-60130-FG	600(W) x 1300(H)	564	FG	2
RTPV-60135-BL	600(W) x 1350(H)	564	BL	2
RTPV-60135-GW	600(W) x 1350(H)	564	GW	2
RTPV-60130-MC	600(W) x 1300(H)	564	MC	2
RTPV-90130-BL	900(W) x 1300(H)	864	BL	2
RTPV-90130-FG	900(W) x 1300(H)	864	FG	2
RTPV-90135-GW	900(W) x 1350(H)	864	GW	2
RTPV-90130-MC	900(W) x 1300(H)	864	MC	2



Fitting Instructions

1. Insert the Spring mechanism inside the cabinet as shown in Fig.1.
2. Fix the track on left side edge of the cabinet as shown in Fig. 2.
3. Similarly fix the Top track and Right track as shown in Fig. 3 and Fig. 4. respectively.
4. Move the spring mechanism at the top position, front facing outside and draw the rolling shutter through left & right track. Refer Fig. 5, 6, 7.
5. Locate the spring mechanism in its position and screw it as shown in Fig. 8.
6. Attach the end cap at the bottom of the left and right track as shown in Fig. 9.
7. Slide the rolling shutter to ensure smooth working, Fig.10.

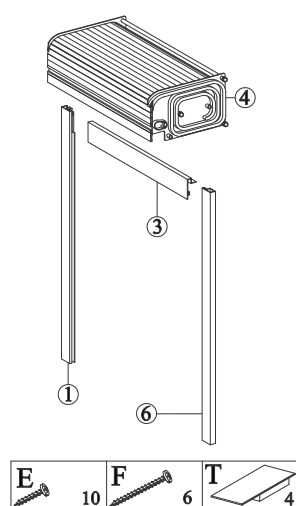

Drilling Diagram - 1 'A' mm
160 Min.

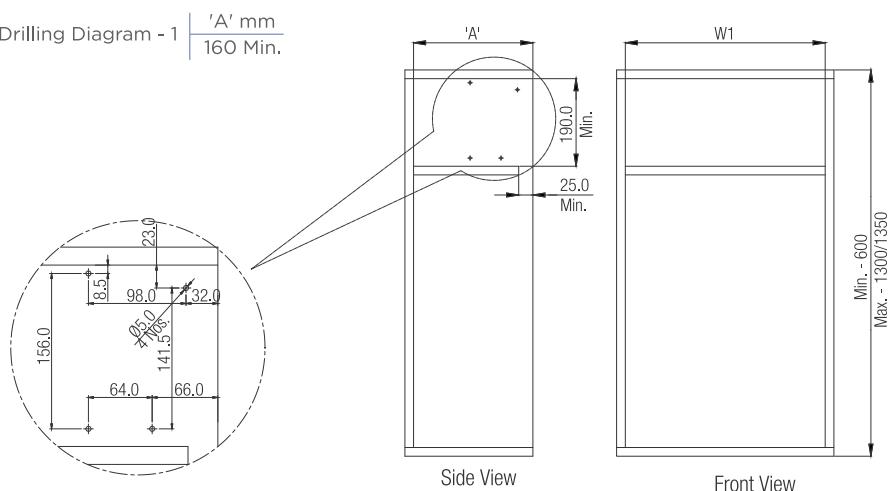

Drilling Diagram - 2 | 'A' mm
300 Min.

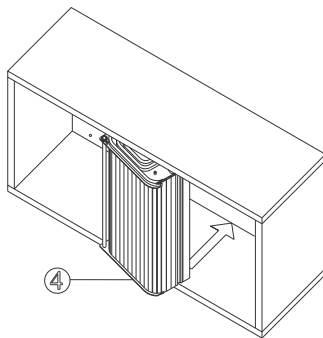
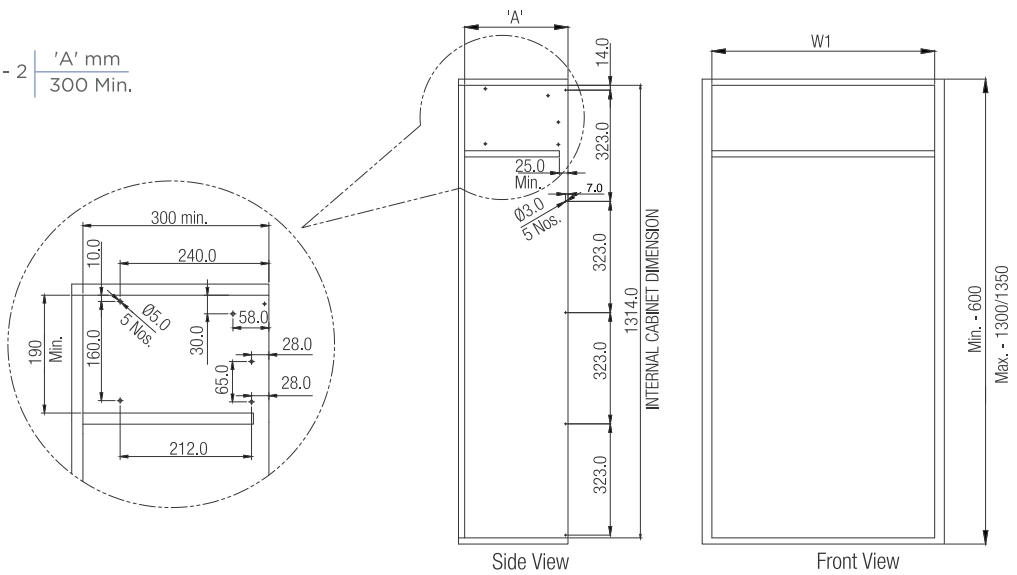

Fig.1

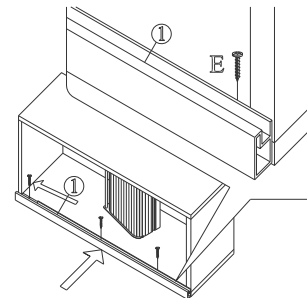

Fig. 2

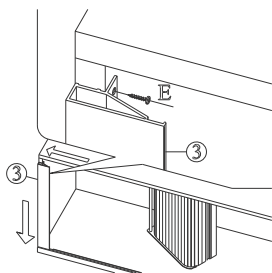

Fig.3

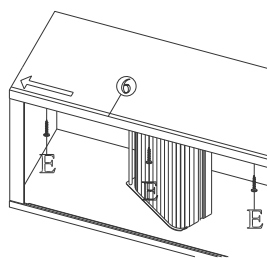

Fig. 4

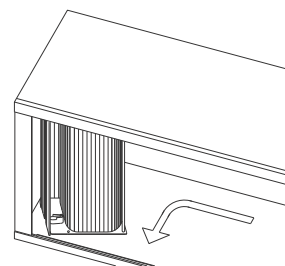

Fig. 5

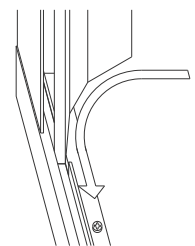

Fig. 6

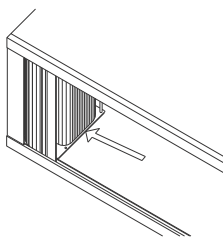

Fig. 7

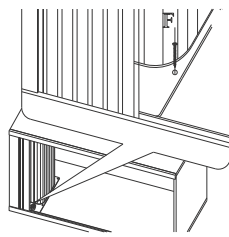

Fig. 8

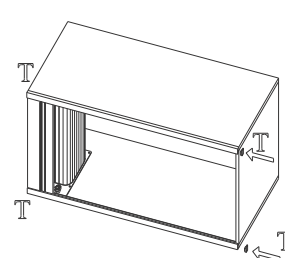

Fig. 9

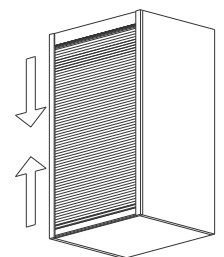

Fig.10