

SMART LIFT PRO 2

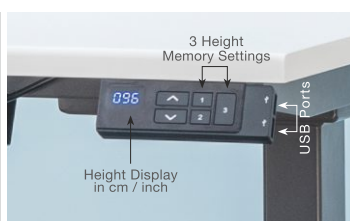

Special Features

- Dual Motor.
- Anti-collision sensors and safety control.
- 3-Stage rectangular legs.
- 3-Height memory setting.
- Height (in cm / inch) Display.
- 2 USB ports for mobile phone charging.
- Width Adjustment: 1075-1800mm.
- Height Adjustment: 640-1290mm.
- Display Height Range : 660-1310mm (Considering Table Top)
- Stroke : 650mm
- Speed : 40mm/sec.
- Max. Load: Static : 200KGS / Dynamic - 120KGS.
- Input Power: 220-230V / 50-60Hz / 2SA
- Noise Level: <50dB(A)
- Table Tops to be purchased separately.



Specifications

Item	Code No.	Size in mm		Finish
		Depth	Width	
Smart Lift Pro 2	SLTLP2-E	-	-	WH/AT
Table Tops for Smart lifts -18mm	SLTT1-75120	750	1200	FW/WN
	SLTT1-75150	750	1500	

Height Memory Setting

1. Adjust the table to desired height using arrow keys (Up/Down).
2. Press 'Up' arrow key with key '1' to save height on key '1'
3. Display flashes 'P1' on saving height
4. Repeat step 1 & 2 to save height on key 2 & 3 respectively.
5. Single tap the key 1 or 2 or 3 with the saved height to use.

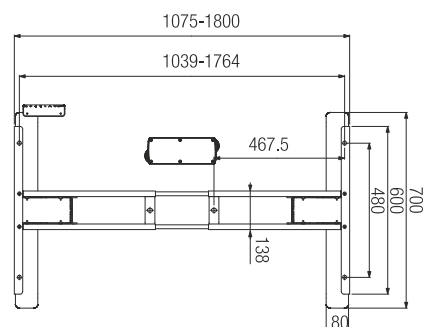
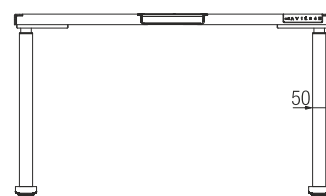
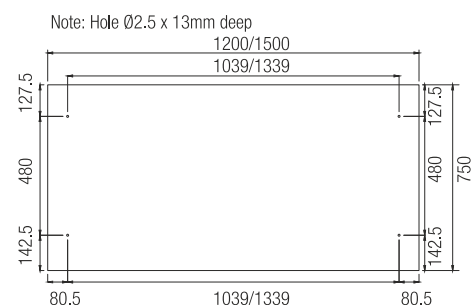
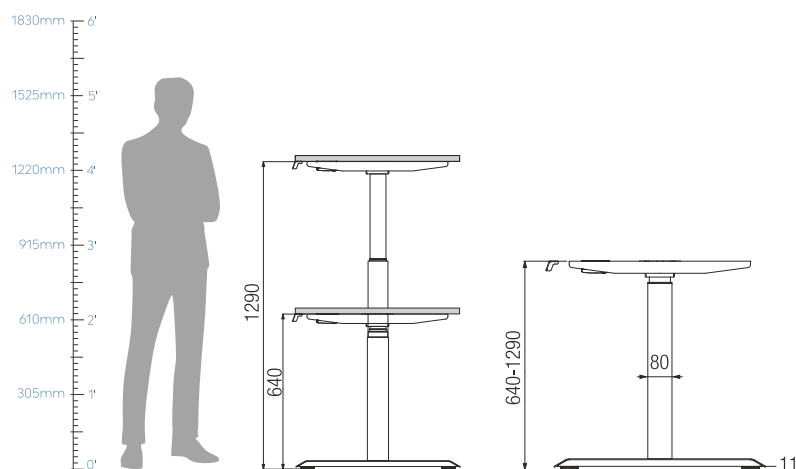

Caution:

Do not power ON the motor unless complete table assembly is done, check all cable connection is correctly connected before powering it 'ON'.



Scan to view fitting instructions