

# COMPUTER MONITOR ARM SINGLE ARM WALL MOUNT

## Special Features

- Ergonomically designed computer monitor arm single screen wall mount with angular adjustment enables comfortable working thereby reducing neck, eye and back strain.
- Rotation of screen from landscape to portrait mode to view documents without scrolling.
- Practical solution for commercial spaces, security offices, health care environments etc.
- Concealed cable management system enables clutter free work desk.
- Suitable for 15" to 27" screen
- Compatible for VESA 75 x 75 & VESA 100 x 100
- Max. Load Capacity: 6kg/arm
- Finish: White Texture/ Anthracite.

## Specifications

Code No.	Finish
CMA-SAWM	WT/AT

## Fitting Instructions

1. Screw the Wall Mount Bracket to wall with the help of screws as shown in Fig.1.
2. Fix Diagonal Arm onto the Bracket with Cap, M6 screw & Conical Spring as shown in Fig.2.
3. Tighten the grub screw shown in Fig.3.
4. Screw the Flat Screen to Mounting plate as shown in Fig.4.
5. Pressure can be adjusted by tightening & loosening the screw as shown in Fig.5.
6. Tighten the screws to adjust the load of Monitor as shown in Fig.6.

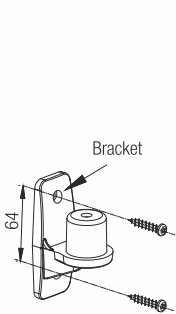
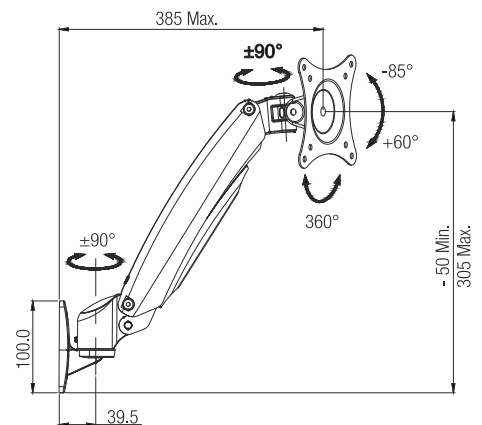

Fig. 1

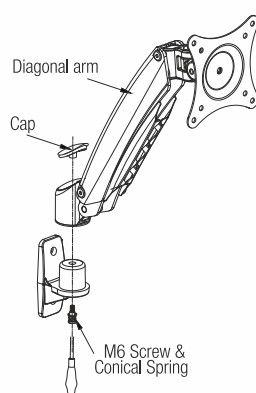

Fig. 2

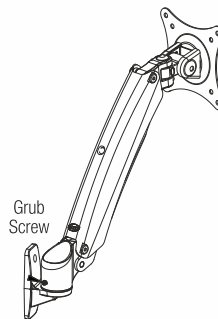

Fig. 3

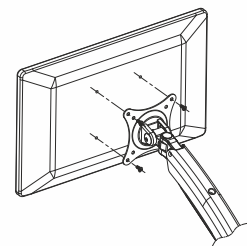

Fig. 4

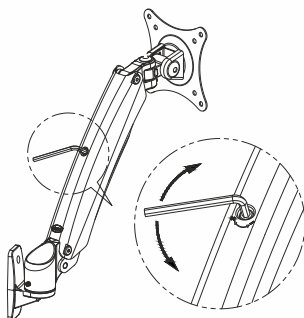

Fig. 5

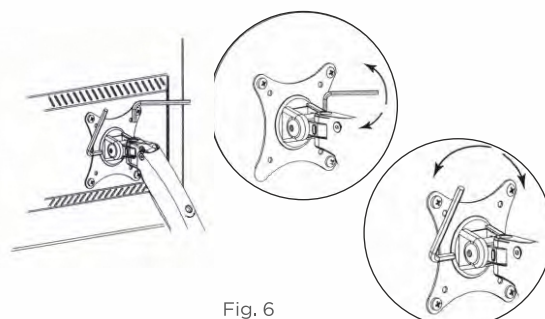

Fig. 6