



# ADJUSTABLE GLASS SHELF SUPPORT



## Special Features

- Elegantly designed to suit modern & traditional decor.
- Adjustable for glass shelves of thickness 6mm to 12mm.
- Screw locking with plastic pad for protection.

## Specifications

Code Nos.	Finish
AGSS 1	SL
AGSS 2	NS



## Fitting Instructions

1. Only suitable for solid walls.
2. Span between supports should not exceed 400 mm (Refer Fig. 1).
3. Shelf should not overhang by more than 100 mm (Refer Fig. 1).
4. Uniform distributed load not to exceed 15 Kgs. (Refer Fig. 1).
5. Loosen the screw below the shelf support (Refer Fig. 2).
6. Fix it on the wall with screws and wall plugs provided (Refer Fig. 3).
7. Place the glass and tighten the screws properly (Refer Fig. 4).

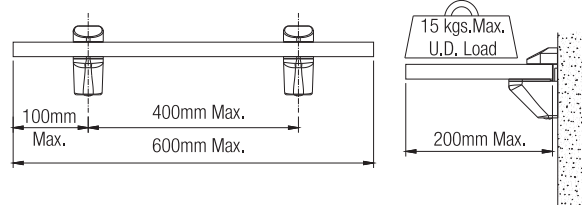
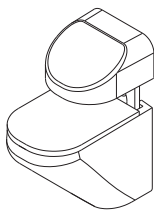

Fig.1

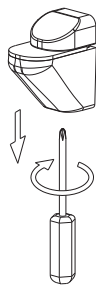

Fig. 2

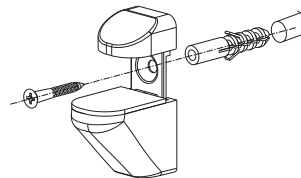

Fig. 3

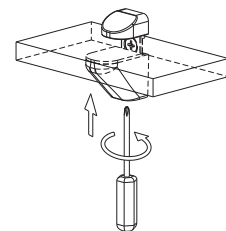

Fig. 4