

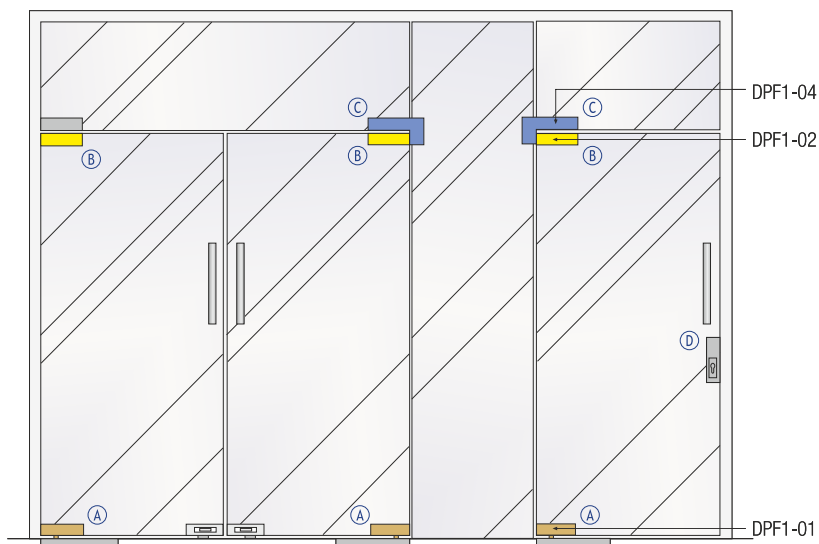





PATCH FITTINGS - SS304

Special Features

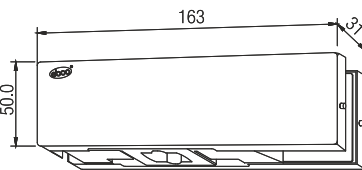
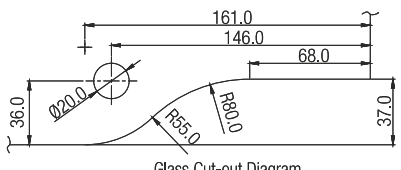
- Specially designed patch fittings for glass doors.
- Widely differing arrangements with top or bottom locking fittings and corner fittings.
- Glass Thickness: 10-12mm
- Material: Aluminium Alloy and Stainless Steel
- Finish: Brushed Steel.

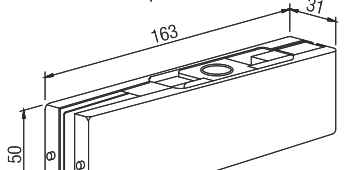
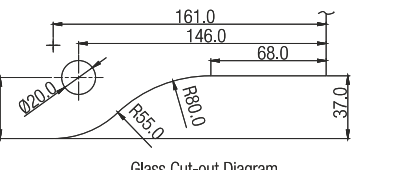

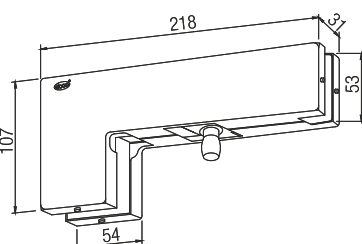
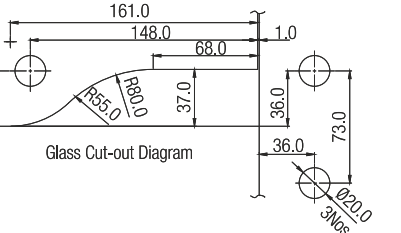
<p>A</p> <p>DPF1-01</p> 	<p>Bottom Corner Patch</p> 	<p>Glass Cut-out Diagram</p>  <p>Glass Cut-out Diagram</p>
<p>B</p> <p>DPF1-02</p> 	<p>Top Corner Patch</p> 	<p>Glass Cut-out Diagram</p>  <p>Glass Cut-out Diagram</p>
<p>C</p> <p>DPF1-04</p> 	<p>Corner 'L' Patch with Pivot</p> 	<p>Glass Cut-out Diagram</p>  <p>Glass Cut-out Diagram</p>

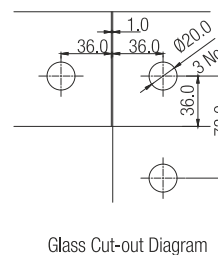
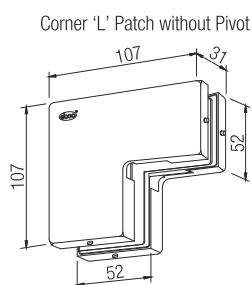
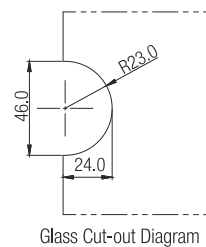
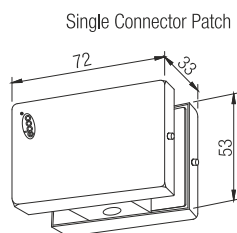
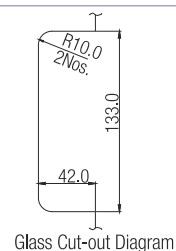
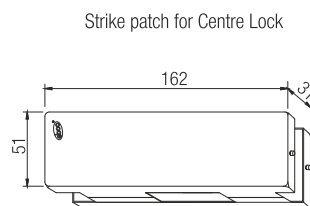
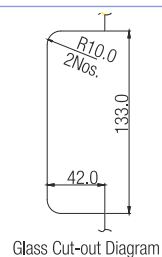
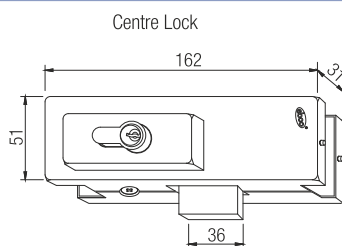

PATCH FITTINGS - SS304

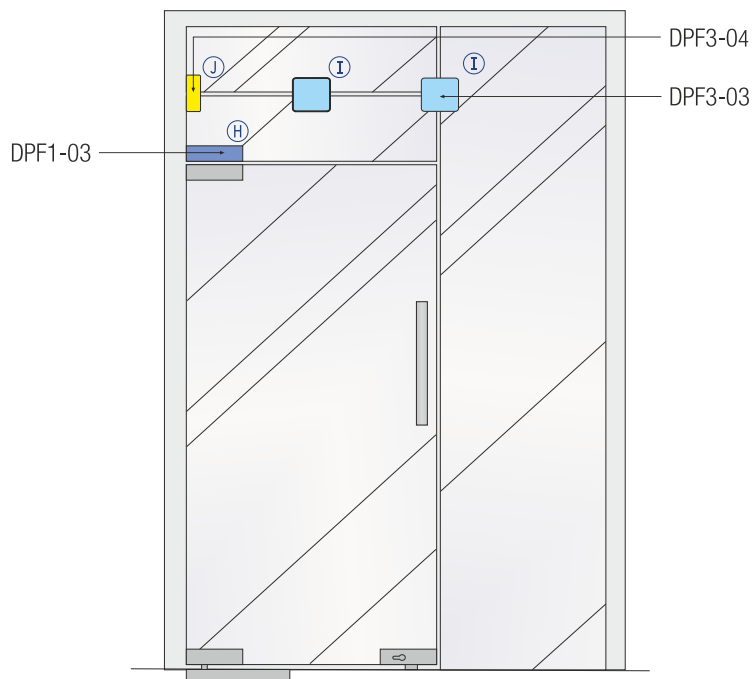

(H)

DPF1-03



Over Panel Patch with Plate

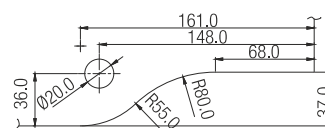
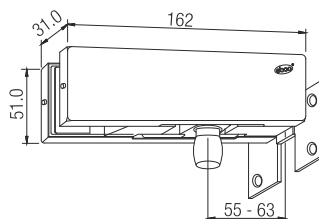

Glass Cut-out Diagram

(I)

DPF3-03



Quad Connector Patch

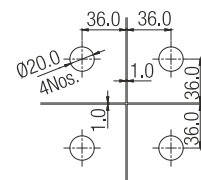
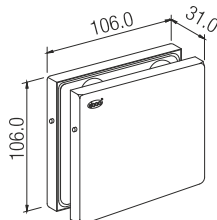

Glass Cut-out Diagram

(J)

DPF3-04



Double Connector Patch

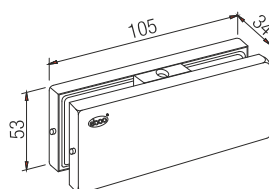

Glass to Glass

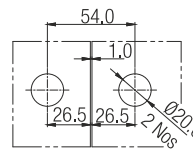

Floor / Wall to Glass

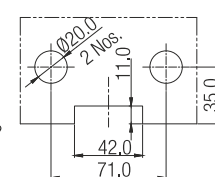

Glass Cut-out Diagram