

KITCHEN WALL HANGING FITTINGS AND ACCESSORIES



Specifications

Items	Code Nos.	Size in mm.	Mount: Bracket / Hook
Kitchen Spice Rack	KWA-S*	350 X 300 X150	Bracket
	KWA-S2*	500 X 300 X 150	Bracket
Kitchen Corner Rack	KWA-C*	280 X 280 X 300	Bracket
Multi Purpose Plate Rack	KWA-M*	600 x 240 x 319	Bracket
Glass Hanging Rack	KGHR-H	235 x 121 x 345	Hook
Dish Lid Rack	KDLR-H	205 x 127 x 375	Hook
Plate Holder	KPH-H	-----	Hook
Ladle Holder	KLH-H	-----	Hook
Pipe Holder Fittings	WHRF1	-----	
S. S. Hook	WHRF2	-----	
S. S. Pipe	WHRF3	610 x 1220 x 1830	

Special Features

- Manufactured out of SS 304.
- For storing all kinds of bottles and jars conveniently on the wall.
- Special rack for corners.
- Special rack for storage of kitchen towels, cling film and aluminium foil.
- Special rack for hanging Glasses.
- Special rack for storing Dish Lids of different sizes.
- Multi purpose plate rack for storing Plates, Cups etc.
- Ladle Holder to store Cutlery items.
- Plate Holder for storing plates on wall.

* Add 'H' to the existing code for Wall Hanging model (Hook type)

Fitting Instructions

1. Drill Ø5.0 (3/16") holes in wall where rail holders are to be fitted and push in plastic plugs (Refer Fig. 1).
2. Fit holder base and screw holder with screw as shown (Refer Fig. 2).
3. Fit rail holder with grub screw as shown (Refer Fig. 3).
4. Fit rail with grub screw and push end cap as shown (Refer Fig. 4).

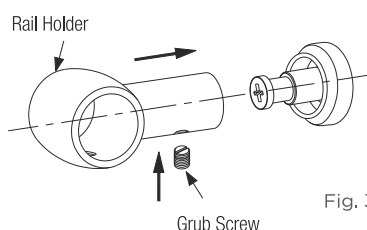

Fig. 3

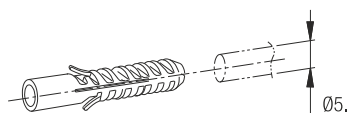

Fig. 1

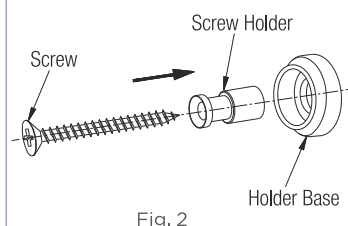

Fig. 2

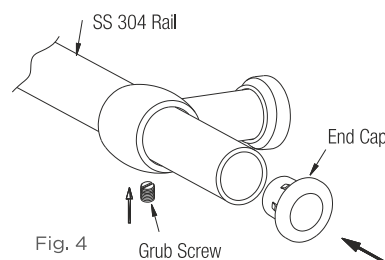
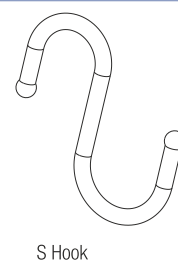

Fig. 4



S Hook