

COMPUTER KEYBOARD TRAY CURVE

Special Features

- Allows your keyboard to be neatly stored underneath your desk and pulled out when required.
- Height can be adjusted with the help of height-adjustable mounting brackets.
- Length: 350mm
- Extension: 240mm
- Comes with a formed pencil tray.
- Moves quietly and smoothly with keyboard slides.
- It has a unique arched hand rest to prevent fatigue while working.
- Special latch provided for locking.
- Maximum Load: 12kgs.



Specifications

Code No.	Finish
KBTC35	BL

Fitting Instructions

1. Minimum horizontal gap required is 550mm.
2. Drill as per drilling diagram as in Fig. 1.
3. Assemble height adjustment brackets on to the slides using M4 screws provided as in Fig. 2.
4. Height adjustment bracket should be adjusted for desired height.
5. Screw the mounting bracket 85mm distance from the front edge of the table and to other end 255mm & 355mm respectively for 350mm & 450mm slides (Refer Fig. 3).

Drilling Diagram

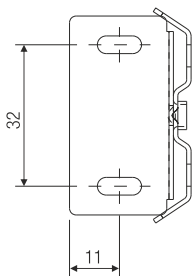

Fig. 1.

Height Adjustment Brackets

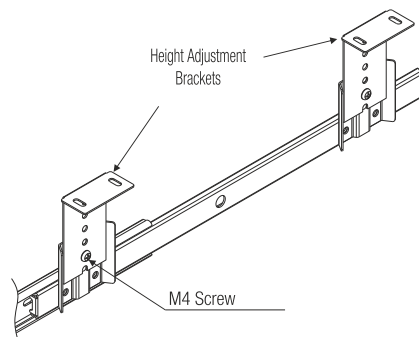

Fig. 2

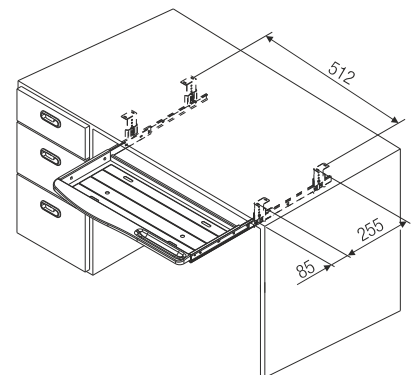
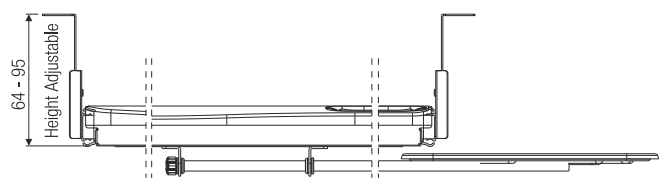
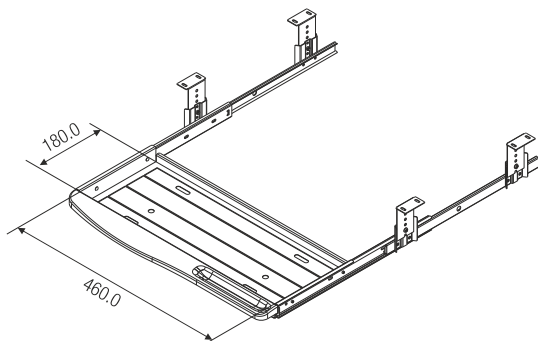

Fig. 3



Front View