

DOUBLE CORNER PULLOUT - ECO 450



Special Features

- Thoughtfully designed for corner cabinets.
- Trays can be pullout individually.
- Customizable height for trays.
- Soft closing damper for smooth functioning.
- Load capacity: 15kg per tray.
- Finish: Anthracite

Specifications

Code Nos.	Size	Finish
E-DCPO2-450R	450 mm	AT
E-DCPO2-450L	450 mm	AT

Fitting Instructions

Before you start

- A.** Check the packing and make sure you have all the parts & fitting listed.
- B.** When you are ready to start, make sure that the right tools at hand, plenty of space and dry area for assembly.

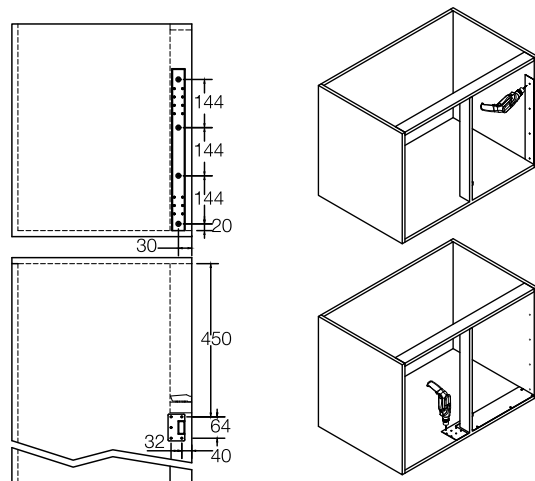
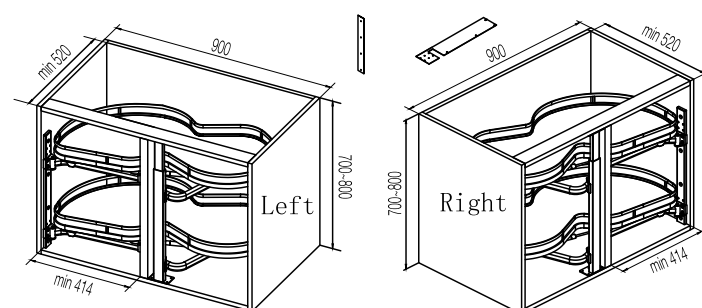

1. Installation Position Illustration.

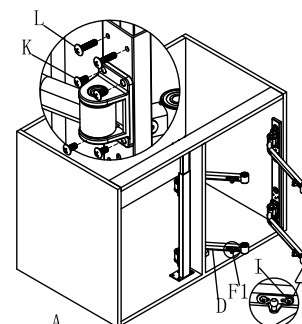

2. Trays Installation.

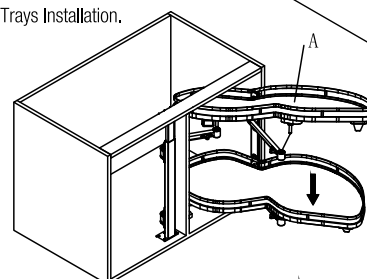

3. Gas Pump Installation.

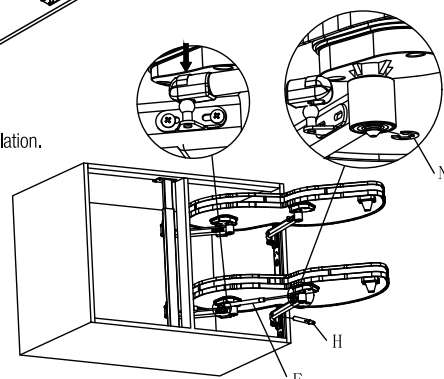

Care & Use

1. Wipe clean with a soft cloth, never use scourers, abrasives or chemical cleaners.

	A	B	C	D	E	F	F1	H	I	K	L	M	N
Parts List													
	Left/Right												
	2 Nos.	1 No.	1 No.	2 Nos.	2 Nos.	2 Nos.	4 Nos.	2 Nos.	8 Nos.	16 Nos.	2 Nos.	14 Nos.	4 Nos.