

# SLIDING DOOR FITTINGS - GLASS 125Kgs

## Special Features

- Ideally designed for glass doors.
- Precision roller system has good load bearing and life.
- Special guides and catches to secure the door.
- Glass thickness - 6 to 10mm.
- Load capability - 125 kgs.

## Specifications

Item	Code Nos.	Glass Thickness	Glass Size (Ft.)	Glass Weight (Kgs)	Max. Load Kgs.	Finish
Sliding Fitting	SDF-125GM	6 mm	8' x 3'	34	125	ZW
		8 mm	8' x 6'	93		
		10 mm	8' x 4.5'	87		
		10 mm	8' x 5'	97		
Aluminium Section (125 Kgs.)	SDF-AS-125M-2	-			2.44 mtrs	AS
	SDF-AS-125M-3	-			3.66 mtrs	AS
Track for Sliding Door Fitting with Fixed Glass	SDF-125-ATG-2	-			2.44 mtrs	AS
	SDF-125-ATG-3	-			3.66 mtrs	AS
Wall Mounting Bracket	SDF-WB	-				ZW
Bottom Guide	SDF-BG12	12 mm	8' x 4'	92		BL



## Fitting Instructions

1. Cut glass door as shown in diagram. Place diagram under glass for marking.
2. Assemble the fittings as shown in diagram (Refer Fig. 2 & 3).
3. Fit the catch in the aluminum section at both ends and adjust the center screw for pressure (Refer Fig. 4).
4. The door is hung on the sliding fitting and flange nut tightened to lock. height adjustment of 12 mm is available. (Refer Fig. 5).
5. Fit the bottom guides on the floor. Bottom guide is to be cut to suit thickness of glass (Refer Fig. 5).

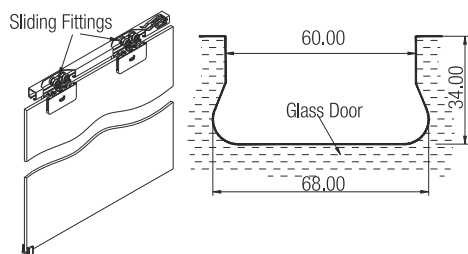

Fig.1

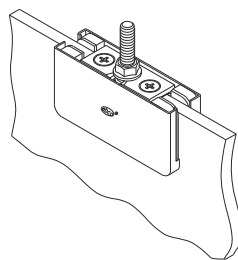

Fig.3

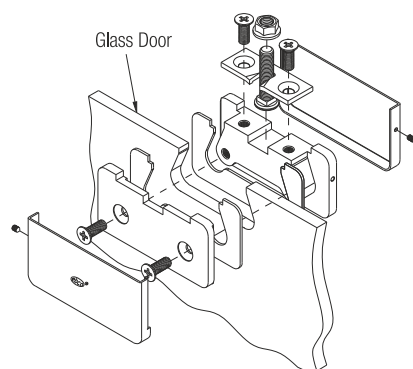

Fig.2

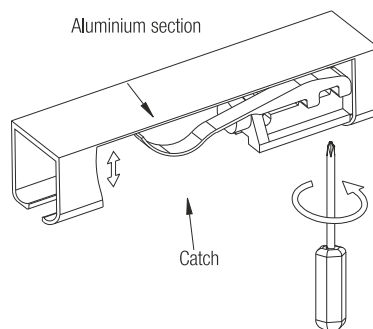

Fig.4

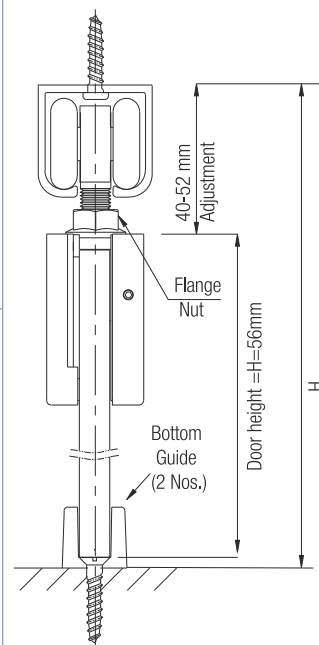
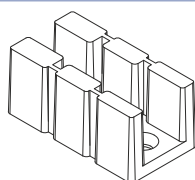
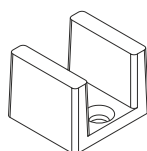

Fig.5



Bottom Guide for 6,8 & 10 mm Glass



SDF 12mm Bottom Guide (SDF-BG12)

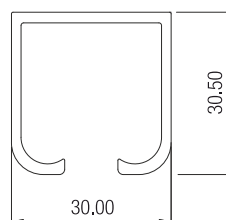

Aluminium Section