

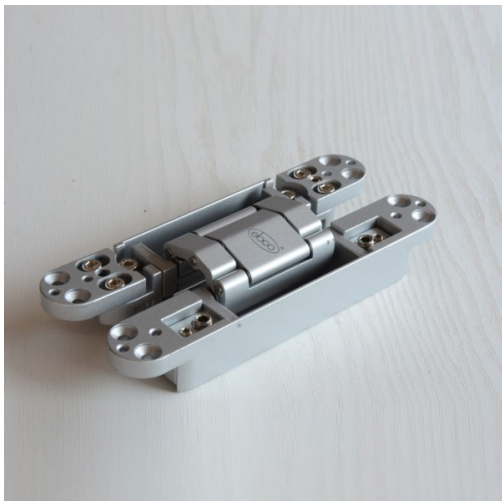

[Home](#) » [Concealed Hinge - 3D 80](#)



Concealed Hinge - 3D 80

- For flush wooden door application.
- 3D dimensional adjustment after installation.
- Max Door Weight with 2 hinges - 80 Kgs.
- Min door thickness - 40 mm
- Max door width - 1000 mm
- Max opening - 180°

Specifications

Model	Model Code	Size	Finish
Concealed Hinge -3D (For minimum Door thickness 40 mm)	CH3D-80	Max.Weight /2 Hinge -80 Kgs Mini. Door Thick - 40 mm Max. door width - 1000 mm Max. opening -180°	Silver

Fitting Instructions

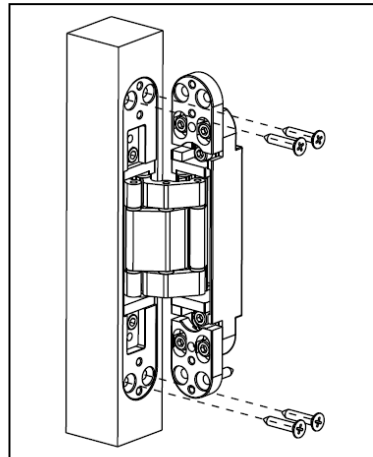
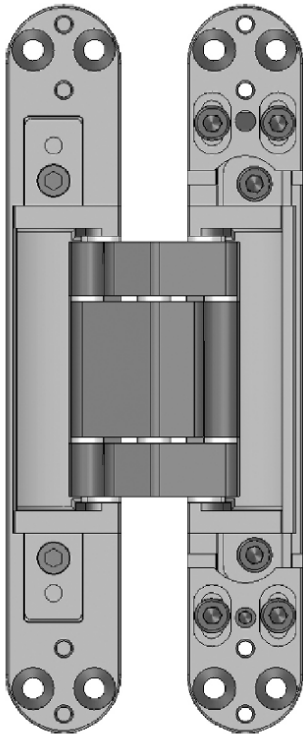

Conduct the routing,
cutter 24 mm Ø ,
collar ring 30 mm Ø ,
screw hinge door part (marked as
door) using 5 mm Ø wood
screws.

Infinitely variable 3D adjustment:
Side and height +/- 3 mm, depth +/- 1 mm
Adjustments made using a 4 mm Allen key

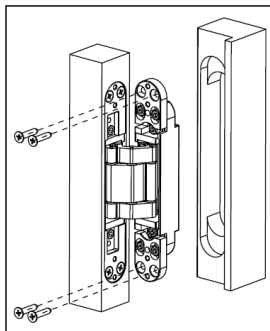

Fasten hinge frame part depending
on the frame type.
If required, please loose slightly
the upper clamping screws for the
height adjustment.
Block frame: Screw with 5 mm Ø
wood screws
For further frame types, see page 2

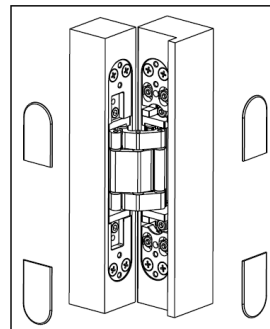

Screw the small cover plates
using the enclosed tapping
screws onto frame and door part.

Double-check the fastening of all clamping and fixing screws after
installation.

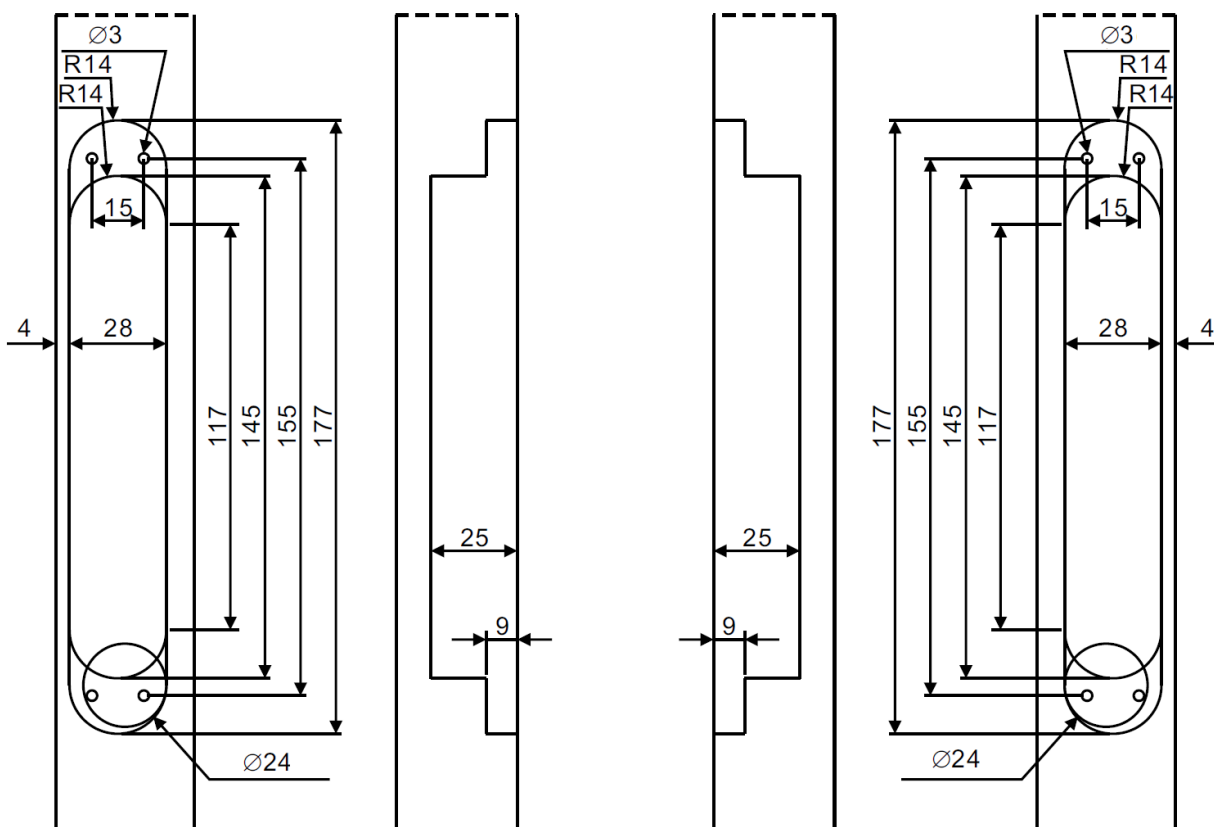

Installation situations of further frame types

Wooden casing frame

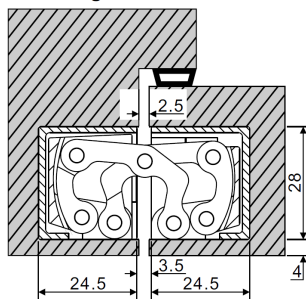

Screw the hinge using the enclosed M 5 screws.
Depending on the frame design, use the small spacer plates.

Steel frame

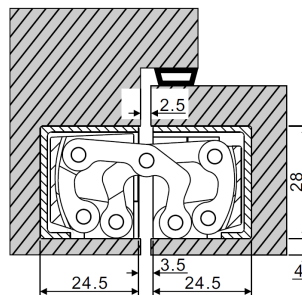

The steel frame must be equipped with a receiver for fastening.

Aluminium frame: with the receiver of the frame manufacturer

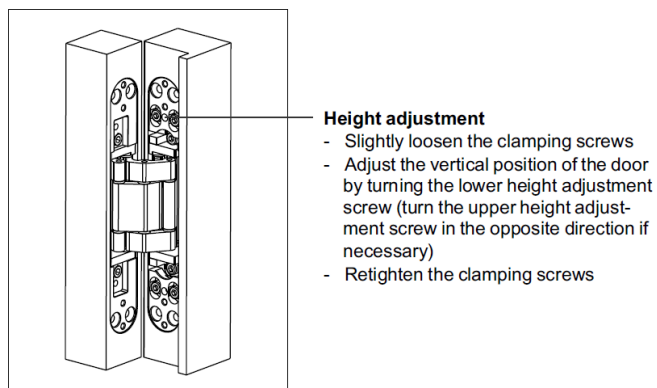
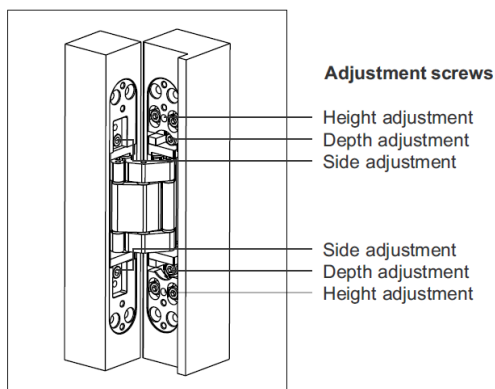

Height adjustment

- Slightly loosen the clamping screws
- Adjust the vertical position of the door by turning the lower height adjustment screw (turn the upper height adjustment screw in the opposite direction if necessary)
- Retighten the clamping screws

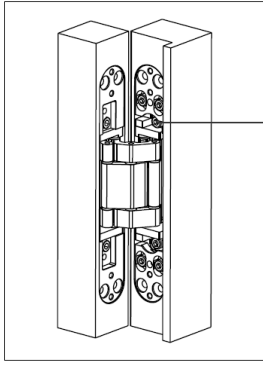

Depth adjustment

- Slightly loosen the fixing screws
- Put the door to the correct compression
- Retighten the clamping screws

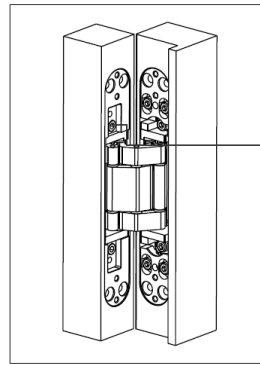

Side adjustment

- Adjust the adjusting spindles using a 4 mm Allen key
- Twist left - towards hinge (max. 3 mm)
- Twist right - towards lock (max. 3 mm)