

# BLOCK CONNECTOR FITTINGS



## Special Features

- Ideal for right angle joint of wooden panels.
- Can be used for solid wood as well as particle board.
- Made of nylon.



## Specifications

Code No.	Finish
BCF1	WH

## Fitting Instructions

1. Drill in vertical board as per Fig. 1.
2. Drill in horizontal board as per Fig. 2.
3. Join both boards at right angles as per Fig. 3.

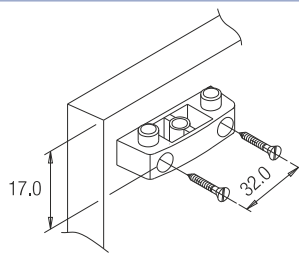

VERTICAL BOARD

Fig 1

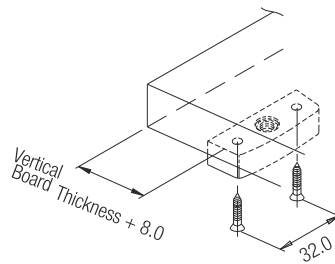

HORIZONTAL BOARD

Fig 2

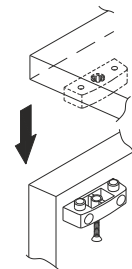

Fig 3