

---

December 2023

# HARDWARE FOR STEEL FURNITURE



## COMPANY PROFILE

Ebco was founded in 1963 as a Tool Room and subsequently diversified into furniture hardware and has ever since become India's leading manufacturer in the industry. Our strengths include a range of core competencies in manufacturing, an ever-widening product range, stringent quality standards, affordable prices and an all-india distribution network.

We have a state of the art design and product development department, which uses the latest 3D design software, CNC Machining Technology, roll forming and sheet metal pressing technology. Our Tool Room capacities have increased significantly which has reduced product development lead time. We have three manufacturing plants and multiple warehousing facilities north of Mumbai in the towns of Vasai and Palghar, Maharashtra. Our products are engineered to perform and our Quality Assurance Laboratory at the Vasai manufacturing plant ensures that we consistently achieve this goal. They regularly conduct rigorous cycle tests, load tests and other checks in accordance with certified international quality norms. Our manufacturing plant at Vasai houses our Design and Development department, Tool Room, Press Shop, Hardening, Phosphating and Assembly departments and has been certified in ISO 9001: 2015 – Quality Management System, ISO 14001: 2015 – Environmental Management System, ISO 45001 : 2018 – Occupational Health & Safety Management System.



**ISO 9001: 2015**  
Quality Management System



**ISO 14001: 2015**  
Environmental Management System



**ISO 45001 : 2018**  
Occupational Health and Safety Management System

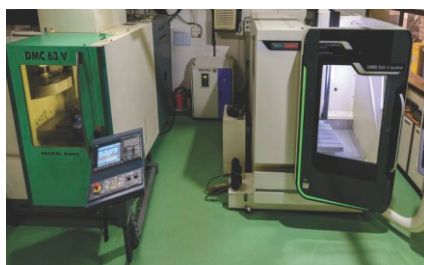

CNC Machines

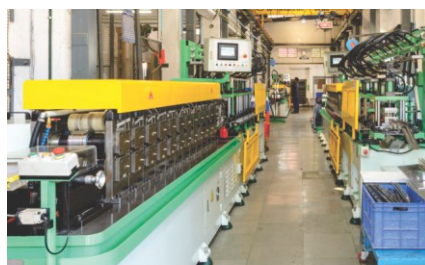

Roll Forming Production Line



Press Shop

## INTRODUCTION

Steel furniture requires specialized hardware that differs from those used for wooden furniture. Typically, using screws is not the preferred method for fixing hardware to steel furniture because the material often lacks sufficient thickness to securely hold the screws in place. If screws are used, they must be accompanied by nuts, which can increase both production time and costs. Therefore, hardware for steel furniture should be designed with features such as lancing or clip systems, allowing for direct clipping onto the furniture. Such designs help in rapid installation, reduce production time. Additionally, the hardware must conform to international standards, passing tests such as salt spray test, load capacity, cycle test, etc.

At ebco, we pay attention to even the smallest details to provide you with the best hardware solution for your furniture. This brochure gives an overview of our unique range of hardware designed specifically for steel furniture, along with other necessary fittings.

## INDEX

### SAFE DRAWERS

- 3 Safe Drawer - Single / Double
- 3 Safe Drawer - Mini

### DRAWER SLIDES

- 3 Steel Furniture Drawer Slide 35Kg
- 3 Ball Bearing Slides for Steel Furniture - 35mm (HT), 30kg (Zipco)
- 4 Ball Bearing Slides - 35mm (HT), 30kg (Zipco)
- 4 Ball Bearing Slides - 36mm (HT), SC (Zipco)
- 4 Concealed Drawer Slide Partial Extension 2 - SC (20kg)

### HINGES

- 4 Euro - Slip On Hinge - SS304 with 4 Hole Mounting Plate
- 5 Slip on Hinge - EURO
- 5 Slip On Hinge - Euro with 4 Hole Mounting Plate (Zipco)
- 5 Euro-Slow Motion Hinge with 4 Hole Mounting Plate (Zipco)
- 5 Euro-Slow Motion Hinge
- 6 Hinge Slow Motion - SS304 with 4 Hole Mounting Plate
- 6 Hinge Slow Motion - 3D
- 6 Short Arm Hinge with 4 Hole Mounting Plate - SS201 (Zipco)
- 6 Short Arm Hinge with 4 Hole Mounting Plate - SS304
- 7 Short Arm Hinge with 4 Hole Mounting Plate
- 7 Short Arm Hinge with 4 Hole Mounting Plate - SC
- 7 Blind Corner Hinge 3D - SC
- 7 270° Hinge
- 7 Inline Hinge
- 8 Cabinet Hinge - Overlay
- 8 Spring Loaded Hinge
- 8 Pivot Glass Hinge 8mm
- 8 Pivot Hinge with spring
- 9 Pivot Hinge - Inset

### GENERAL HARDWARE

- 9 Rivet Nuts
- 9 Plinth Screws
- 9 Ball Head Plinth Screw
- 10 Furn Felt
- 10 Plinth Screw - Round (Zipco)
- 10 Base Plinth
- 10 Base Plinth - 14mm
- 10 Pedestal Castor 28m
- 11 Appliance Castors (Zipco)
- 11-12 Swivel Castors (Zipco)
- 12 Twin Wheel Castor (Zipco)
- 13 Magnetic Catch Ultra Slim

- 13 Ventilation Grill Ø40mm
- 14 Ventilation Grill - Rectangular
- 14 Bumpers
- 14 Sliding Cabinet Shutter Fittings
- 15 Hi Slide 50 Reversible - Soft Close
- 15 Hi Slide 45 Reversible - Soft Close
- 16 Recessed Handle 90mm
- 16 Recessed Handle - Steel Furniture
- 16 Zinc Handle - Q
- 16 Zinc Handle - E
- 16 Tongue Handle

### FURNITURE LOCKS

- 17 Front Multi Drawer Lock (Premium)
- 17 Front Multi Drawer Lock (Secutek)
- 17 Front Multi Drawer Lock (Target)
- 17 Front Multi Drawer Lock (Zipco)
- 17 Square Lock - 22/33mm (Zipco)
- 18 Square Lock Popular (Zipco)
- 18 Square Lock (Premium)
- 18 Square Lock (Secutek)
- 18 Square Lock (Target)
- 18 Pedestal Lock (Premium)
- 19 Pedestal Lock (Secutek)
- 19 Pedestal Lock (Target)
- 19 Cam Lock (Premium)
- 19 Cam Lock (Secutek)
- 19 Cam Lock (Target)
- 19 Cam Lock - Steel Furniture (Secutek)
- 20 Cam Lock - Threaded (Zipco)
- 20 Cam Latch - Steel Furniture (Premium)
- 20 Push Lock (Premium)
- 20 Push Lock (Secutek)
- 20 Push Lock (Target)
- 21 Push & Turn Lock
- 21 Push Latch - Big / Small
- 21 Cupboard Lock (Secutek)
- 21 Cupboard Sliding Lock (Secutek)
- 22 Cupboard Lock for Steel Cabinet - 2 (Premium)
- 22 Cupboard Lock for Steel Cabinet - 3 (Premium)
- 22 4 Digit Combination Lock - Wood (L) / Pedestal (L/R)
- 22 3 Digit Combination Lock - Wood (L) / Pedestal (R)
- 23 4 Digit Combination Lock - Wood (Vertical)
- 23 4 Digit Combination Lock - 2 Point Swing (with rod)
- 23 4 Digit Combination Lock - Wardrobe 2 Point Inset (with rod)
- 23 4 Digit Combination Lock - Steel Cupboard
- 24 Wardrobe Lock 2 Point - Inset (22mm) (Zipco)
- 24 Wardrobe Lock 3 Point (Premium)
- 24 Steel Cabinet Lock cum Handle (set)

## SAFE DRAWER - SINGLE / DOUBLE



Finish : AT

Code Nos.	Size (mm) WxDxH	Load Capacity
SD-TM1	470x300x60	15kgs.
SDM-TM1	470x300x60	15kgs.
SD-TMID	470x300x125	30kgs.
SDM-TMID	470x300x125	30kgs.
SDM-TMCL	470x300x60	15kgs.



**FITTING INSTRUCTIONS**

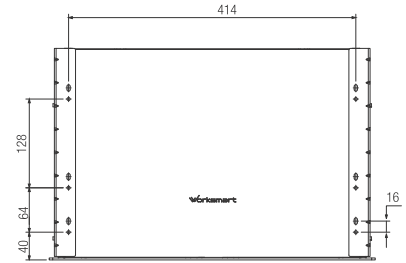

## SAFE DRAWER - MINI



Finish : AT/ WH

Code Nos.	Size (mm) WxDxH	Load Capacity
SMD-SM1	360x270x60	10kgs.
SMD-SMCL	360x270x60	10kgs.
SMD-DM1	360x270x120	20kgs.



**FITTING INSTRUCTIONS**

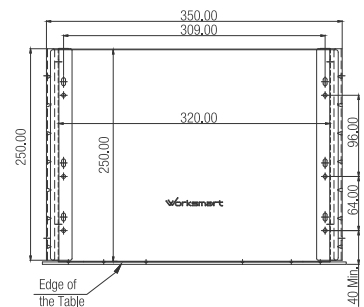

## STEEL FURNITURE DRAWER SLIDE 35 kg

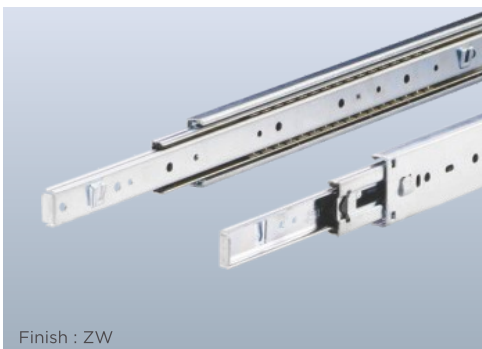

Finish : ZW

Code Nos.	Length (mm)	Extension (mm)	Load Capacity
SFDS40-35	400	430	35kgs
SFDS45-35	450	480	
SFDS50-35	500	530	
SFDS55-35	550	585	



**FITTING INSTRUCTIONS**

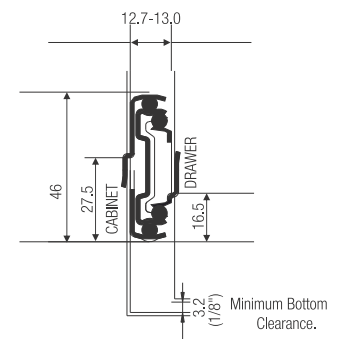

## BALL BEARING SLIDES FOR STEEL FURNITURE - 35mm (HT), 30kg



Finish : ZW

Code Nos.	Length (mm)	Extension (mm)	Load Capacity
2/4 SFDSM 35	350	354	30kgs
2/4 SFDSM 40	400	404	
2/4 SFDSM 45	450	454	



**FITTING INSTRUCTIONS**

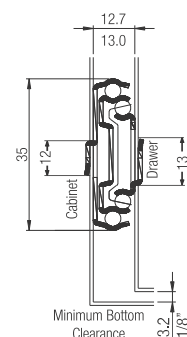

## BALL BEARING SLIDES - 35mm (HT), 30kg

zipco®



Finish : ZW / ZB

Code Nos.	Length (mm)	Extension (mm)	Load Capacity
2/2 STDSM 25	250	254	30kgs
2/2 STDSM 30	300	304	
2/2 STDSM 35	350	354	
2/2 STDSM 40	400	404	
2/2 STDSM 45	450	454	
2/2 STDSM 50	500	504	



FITTING INSTRUCTIONS

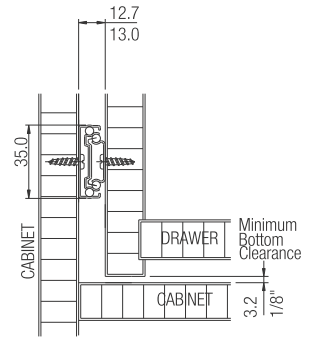

## BALL BEARING SLIDES - 36mm (HT), SOFT CLOSE

zipco®



Finish : ZW

Code Nos.	Length (mm)	Load Capacity
2/5 STDSM 30-SC	300	30kgs
2/5 STDSM 35-SC	350	
2/5 STDSM 40-SC	400	
2/5 STDSM 45-SC	450	
2/5 STDSM 50-SC	500	



FITTING INSTRUCTIONS

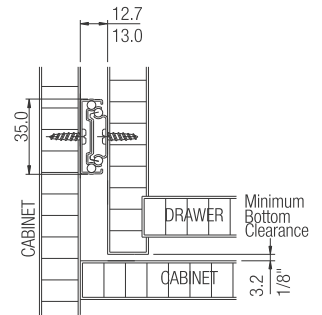

## CONCEALED DRAWER SLIDE PARTIAL EXTENSION 2 - SC (20kg)



Finish : ZW

Code Nos.	Length (mm)	Load Capacity
CDSPE228-SC	285	20Kgs
CDSPE233-SC	335	
CDSPE238-SC	385	
CDSPE243-SC	435	
CDSPE248-SC	485	



FITTING INSTRUCTIONS

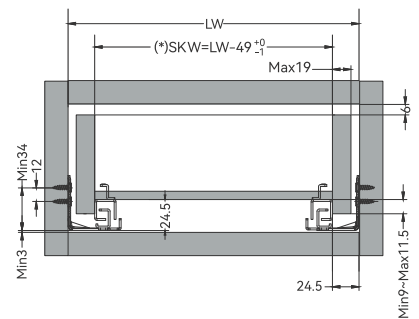

## EURO - SLIP ON HINGE - SS 304 WITH 4 HOLE MOUNTING PLATE



Finish : SS 304

Code Nos.	Model	'A' mm
E-HS1-SS-M1	Full Overlay	37.0
E-HS2-SS-M1	Half Overlay	37.0



FITTING INSTRUCTIONS

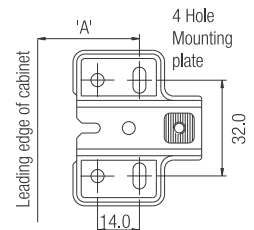
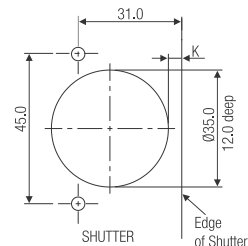

## SLIP ON HINGE - EURO



Finish : NP

Code Nos.	Model	'A' mm
E-HS1	Full Overlay	37.0
E-HS2	Half Overlay	37.0
E-HS3	Inset	37+S
E-HS1M1	Full Overlay	37.0
E-HS2M1	Half Overlay	37.0
E-HS3M1	Inset	37+S
E-HS1M130	Full Overlay	30.0
E-HS2M130	Half Overlay	30.0

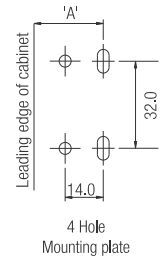
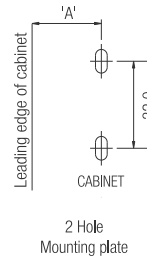
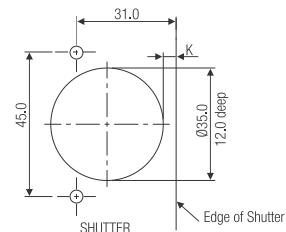

## SLIP ON HINGE - EURO WITH 4 HOLE MOUNTING PLATE



Finish : NP

Code No.	Model	'A' mm
ZE-HS1M1	Overlay	37.0
ZE-HS2M1	Half Overlay	37.0
ZE-HS3M1	Inset	37.0
ZE-HS1M130	Overlay	30.0
ZE-HS2M130	Half Overlay	30.0

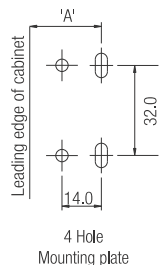
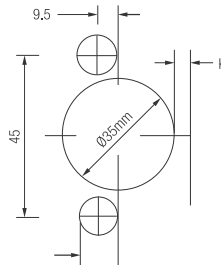

zipco®

## EURO SLOW MOTION HINGE WITH 4 HOLE MOUNTING PLATE



Finish : NP

Code No.	Model	'A' mm
ZE-HSM1-M1	Overlay	37
ZE-HSM2-M1	Half Overlay	
ZE-HSM3-M1	Inset	

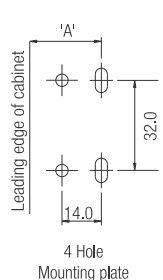
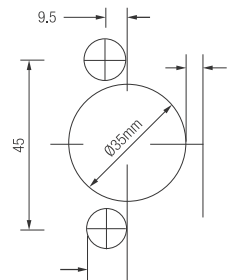

zipco®

## EURO-SLOW MOTION HINGE



Finish : NP

Code Nos.	Model	'A' mm
E-HSM1	Overlay	37.0
E-HSM2	Half Overlay	37.0
E-HSM3	Inset	37+S
E-HSM1-M1	Full Overlay	37.0
E-HSM2-M1	Half Overlay	37.0
E-HSM3-M1	Inset	37+S

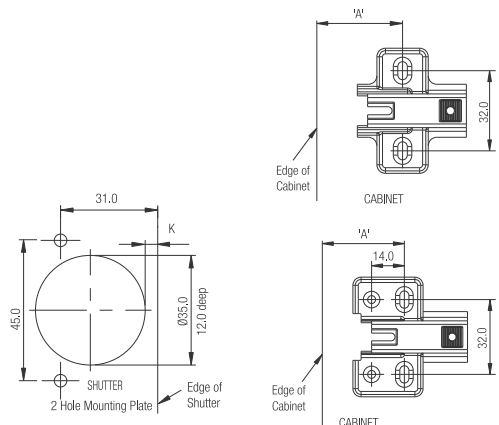

## HINGE SLOW MOTION - SS 304 WITH 4 HOLE MOUNTING PLATE



Code No.	Model	'A' mm
HSM1-M1-SS	Overlay	37.0
HSM2-M1-SS	Half Overlay	37.0
HSM3-M1-SS	Inset	37+S



**FITTING INSTRUCTIONS**

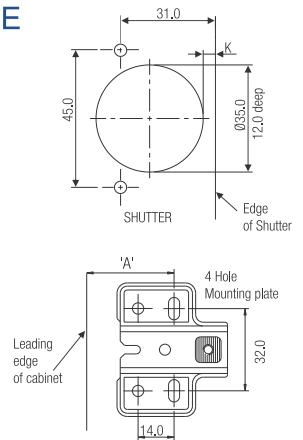

## HINGE SLOW MOTION - 3D



Code Nos.	Model	'A' mm
HSM1-3D	Full Overlay	37
HSM2-3D	Half Overlay	37
HSM3-3D	Inset	37+S



**FITTING INSTRUCTIONS**

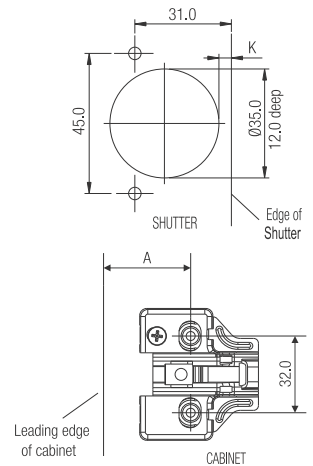

## SHORT ARM HINGE WITH 4 HOLE MOUNTING PLATE - SS201

**zipco**



Code Nos.	Model
ZHSA1-M1-SS	Overlay



**FITTING INSTRUCTIONS**

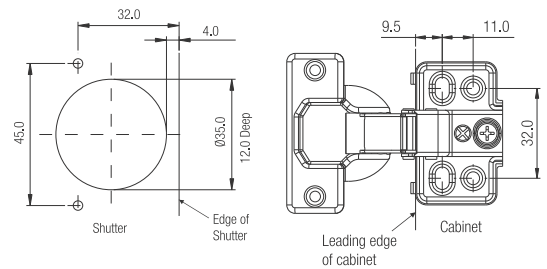

## SHORT ARM HINGE WITH 4 HOLE MOUNTING PLATE - SS304



Code Nos.	Model
HSA1-M1-SS	Full Overlay



**FITTING INSTRUCTIONS**

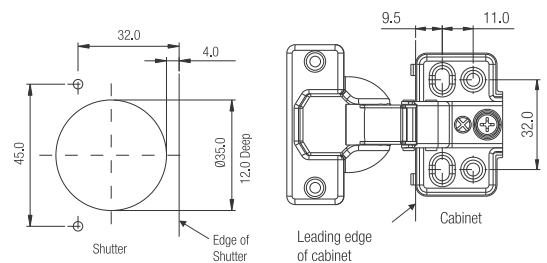



## SHORT ARM HINGE WITH 4 HOLE MOUNTING PLATE

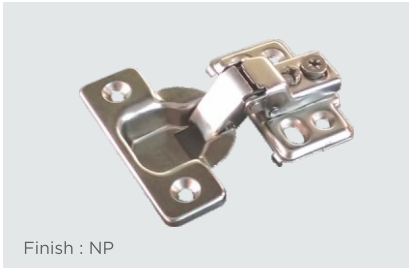

Code No.	Model
HSA1-M1	Full Overlay

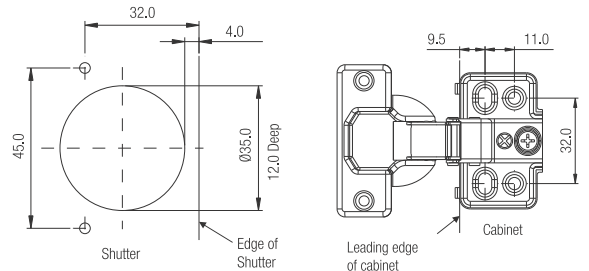

## SHORT ARM HINGE WITH 4 HOLE MOUNTING PLATE - SOFT CLOSE

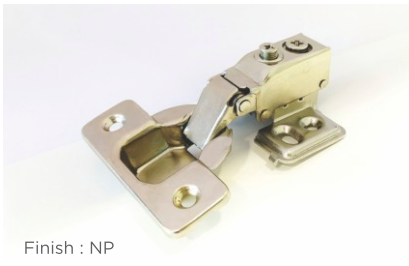

Code No.	Model
HSA1-M1-SC	Full Overlay

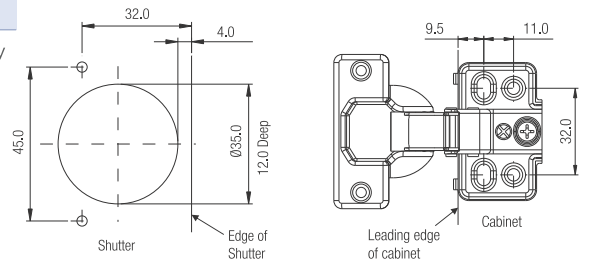

## BLIND CORNER HINGE - 3D - SOFT CLOSE



Code No.
HBC1-3D-SC

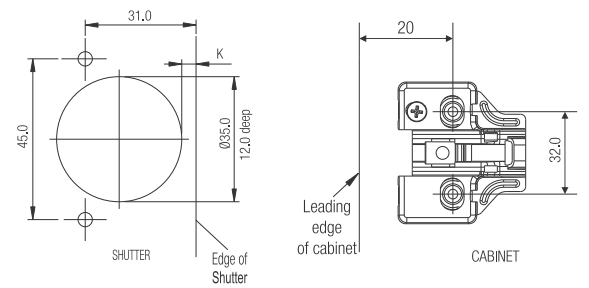

## 270° HINGE

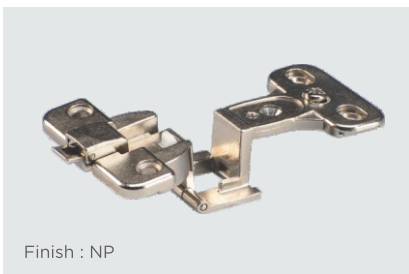

Code No.
H270

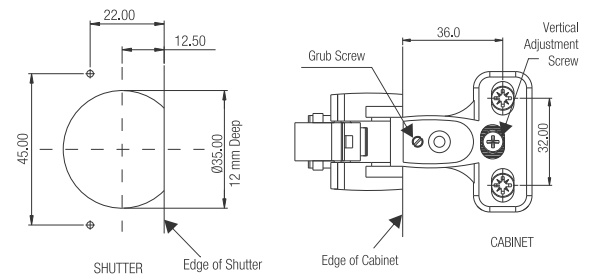

## INLINE HINGE



Code No.
H11

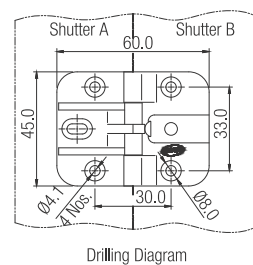

## CABINET HINGE - OVERLAY



Code No.

HCT1



FITTING INSTRUCTIONS

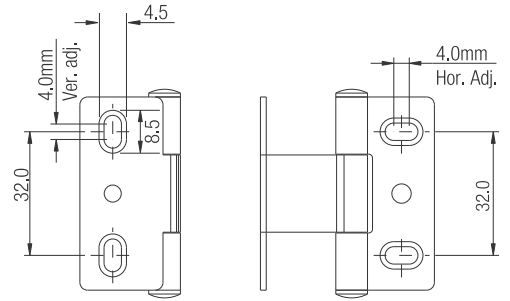

## SPRING LOADED HINGE Design Reg. No: 185407 / 01

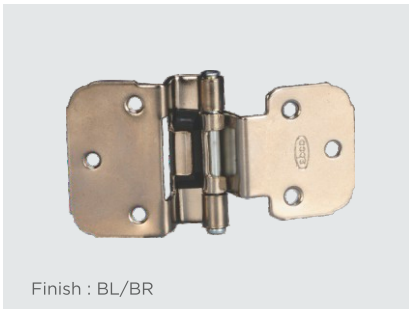

Code No.

HL1PC



FITTING INSTRUCTIONS

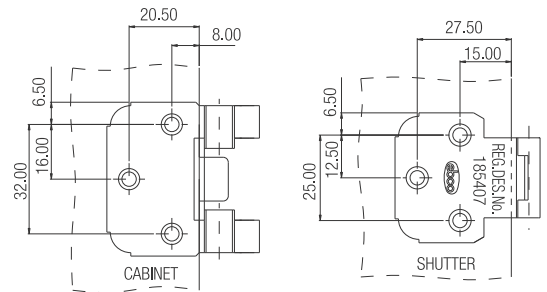

## PIVOT GLASS HINGE 8mm



Code No.

PGH1



FITTING INSTRUCTIONS

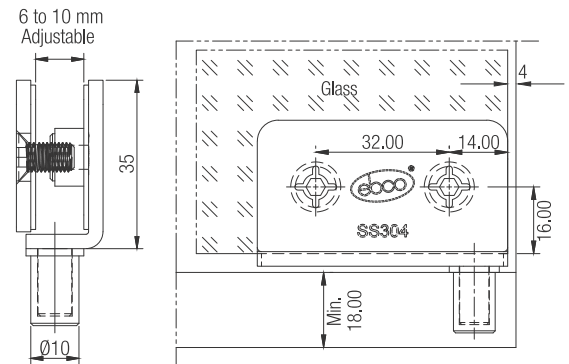

## PIVOT HINGE WITH SPRING



Code No.

HPS1



FITTING INSTRUCTIONS

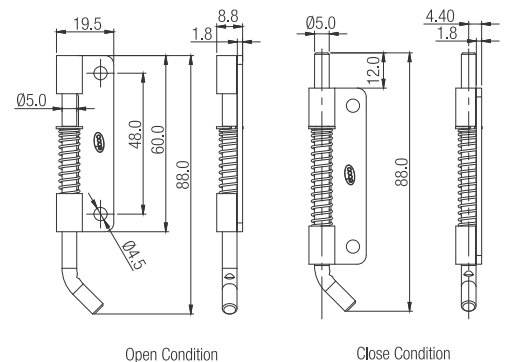

## PIVOT HINGE - INSET



Finish : Raw SS

Code No.	Max. Recommended Size of Window			Max. Load (per set)
	Width	Height	Thickness	
PH-I	450mm	700mm	22mm	2.6 Kgs.

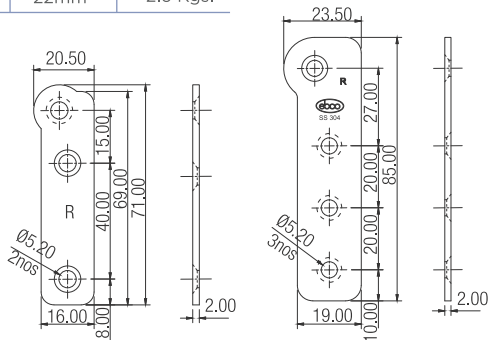

## RIVET NUTS



Finish : ZW

Code Nos.	A	B	C	D	E
RNM816	Ø11.8	M8	16	10	10.45
RNM615	Ø10.70	M6	15	8	9.45
RNM512	Ø8.0	M5	12	5.70	7.15
RNM410	Ø7.4	M4	10.5	6.10	6.20
RNM310	Ø6.0	M3	9	4.50	4.60

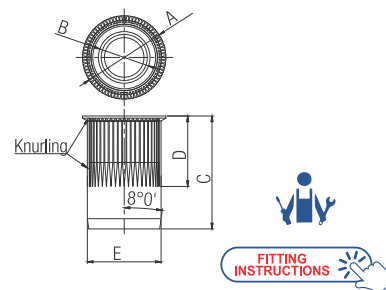

## PLINTH SCREWS



Finish : Plated / Nylon

Code Nos.	'X'	'Y'
PS610	M6	10mm
PS624	M6	24mm
PS640	M6	40mm
PSB624	M6	24mm
PSB824	M8	24mm
PSB1024	M10	24mm
PSB1224	M12	24mm

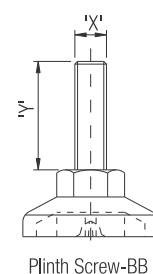
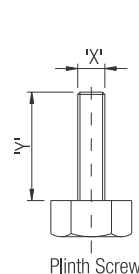

## BALL HEAD PLINTH SCREW



Finish : ZW

Code Nos.	Size (mm)	Load / Piece
BHP840	M8 X 40	800 Kgs.
BHP870	M8 X 70	

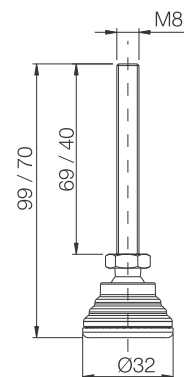

## FURN FELT



Code Nos.	Diameter (mm)
FF22	Ø22
FFE27	Ø27
FF22P	Ø22



**FITTING INSTRUCTIONS**

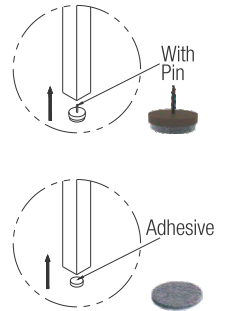
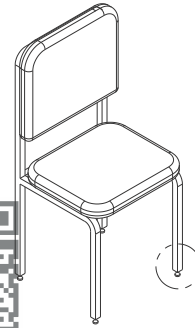

## PLINTH SCREW-ROUND



Finish : Plated / Nylon

Code Nos.	'X'	'Y'
Z-PSR610	M6	10mm
Z-PSR624	M6	24mm
Z-PSR640	M6	40mm
Z-PSR824	M8	24mm



**FITTING INSTRUCTIONS**

**zipco**

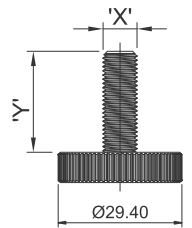

## BASE PLINTH



Finish : BL/WH

Code No.	Load / Piece
BP616	1000 Kgs.



**FITTING INSTRUCTIONS**

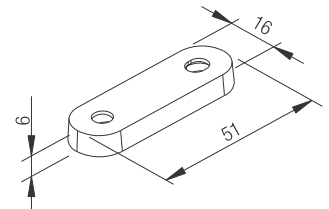

## BASE PLINTH – 14mm



Finish : BL

Code No.	Load / Piece	Finish
BP1418	1200 Kgs.	BL



**FITTING INSTRUCTIONS**

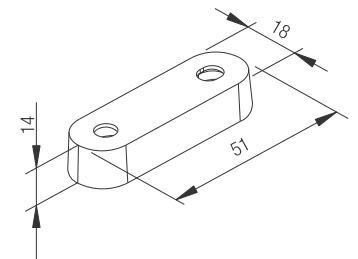

## PEDESTAL CASTOR 28mm



Finish : BL

Code No.	Load / Piece
PC28	500 Kgs.



**FITTING INSTRUCTIONS**

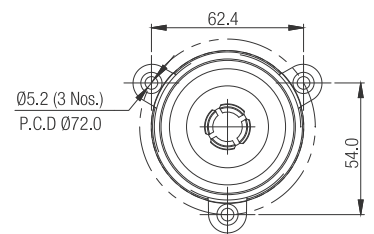

## APPLIANCE CASTORS

zipco®

HARDWARE FOR STEEL FURNITURE



### Appliance Castors (without bearings)

Model	Code Nos.	Wheel Dia. (mm)	Set Height 'A' (mm)	Load per Wheel (Kgs)
Fixed 4-wheel (Nylon)	1/4/FN4C	32	38	50
Fixed 4-wheel (PU)	1/4/FPU4C	34		67
Swivel 4-wheel (Nylon)	1/4/SN4C	32	38	75
Swivel 4-wheel (PU)	1/4/SPU4C	34		100
Fixed 6-wheel (Nylon)	1/4/FN6C	32	44	50
Fixed 6-wheel (PU)	1/4/FPU6C	34		67
Swivel 6-wheel (Nylon)	1/4/SN6C	32	47	75
Swivel 6-wheel (PU)	1/4/SPU6C	34		100

### Appliance Castors (with bearings)

Model	Code Nos.	Wheel Dia. (mm)	Set Height 'A' (mm)	Load per Wheel (Kgs)
Fixed 4-wheel	1/4/FBW4C	32	38	84
Swivel 4-wheel	1/4/SBW4C	32	38	125
Fixed 6-wheel	1/4/FBW6C	32	44	84
Swivel 6-wheel	1/4/SBW6C	32	47	125



**FITTING INSTRUCTIONS**

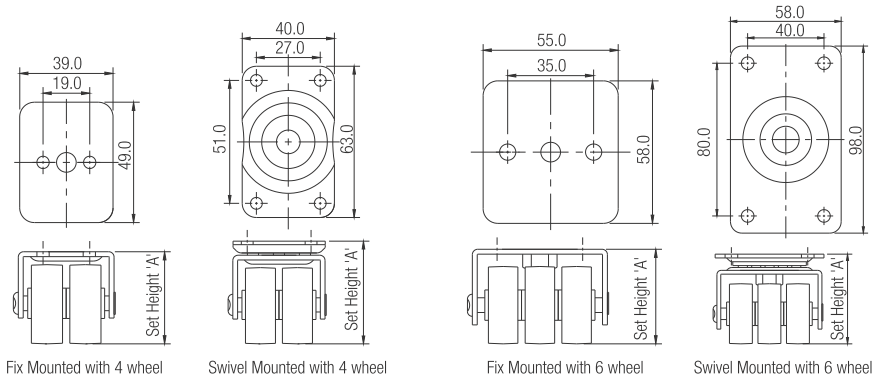

## SWIVEL CASTORS

zipco®



Finish : Fumed

Model	Code Nos.	Wheel Dia. (mm)	Load/Wheel (Kgs.)
Swivel Castor Ø35mm with brake	1/5/P35 PB	Ø35	25
Swivel Castor Ø35mm without brake	1/5/P35 P	Ø35	25
Swivel Castor Ø50mm with brake	1/5/P50 PB	Ø50	35
Swivel Castor Ø50mm without brake	1/5/P50 P	Ø50	35
Swivel Castor Ø75mm with brake	1/5/P75 PB	Ø75	45
Swivel Castor Ø75mm without brake	1/5/P75 P	Ø75	45



**FITTING INSTRUCTIONS**

1/5/P35 P

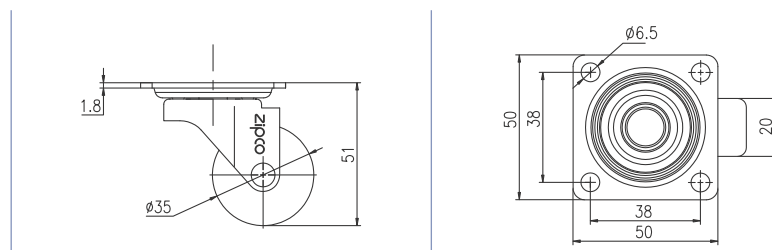

SWIVEL CASTORS

1/5/P35 PB

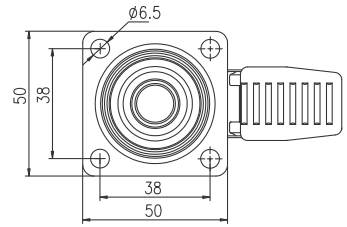
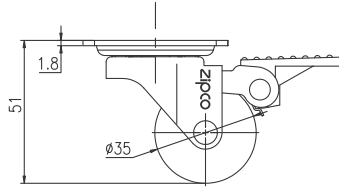

1/5/P50 P

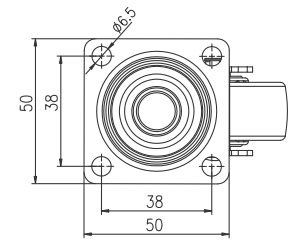
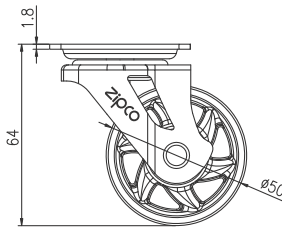

1/5/P50 PB

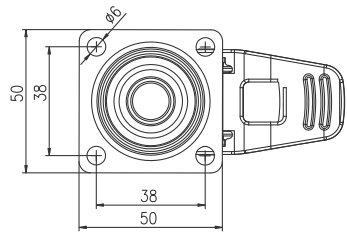
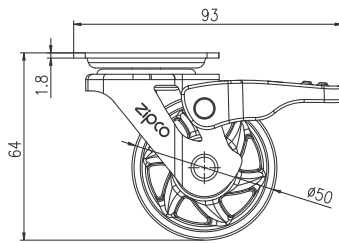

1/5/P75 P

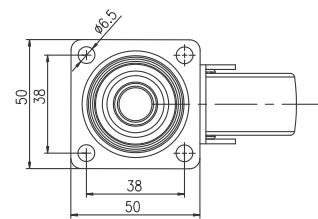
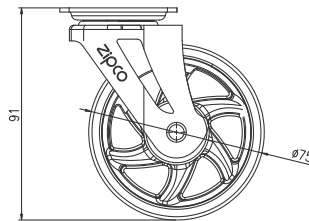

1/5/P75 PB

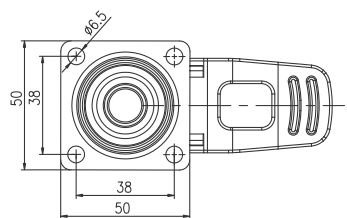
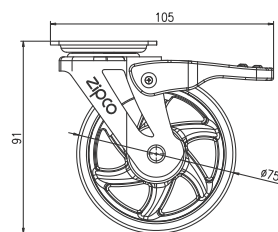

## TWIN WHEEL CASTOR



Item	Code Nos.	Wheel Dia. (mm)	Set Height 'A' (mm)
Twin Wheel (Plate/Thread)	1/1/N40*	40	57 (Plate)
			52 (Thread)
Twin Wheel with brake (Plate/Thread)	1/1/N40B*	40	57 (Plate)
			52 (Thread)
Twin Wheel (Plate/Thread)	1/1/N50*	50	64 (Plate)
			61 (Thread)
Twin Wheel with brake (Plate/Thread)	1/1/N50B*	50	64 (Plate)
			61 (Thread)

\*Add 'P' or 'T' after code for castor with Plate or Thread respectively

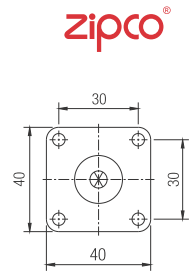

## MAGNETIC CATCH ULTRA SLIM Design Reg. 251830



Item	Code Nos.	Pull Force
Magnetic Catch - Ultra Slim (with screws)	MC-US1	2.25 Kgs.
	MC-US1L	3.25 Kgs.
	MC-US2	5.00 Kgs.
	MC-US2L	5.50 Kgs.
Magnetic Catch - Ultra Slim Magnet Inset (with screws)	MC-I1	2.50 Kgs.
	MC-I1L	2.75 Kgs.

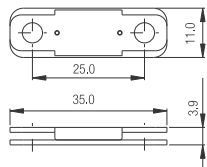

MC-US 1

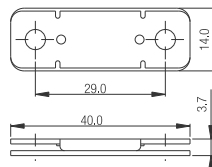

MC-US 2

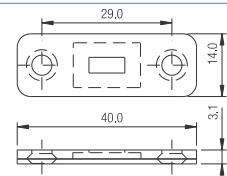

MC-I1

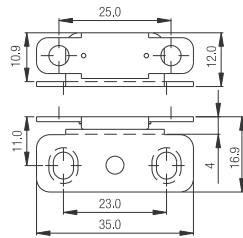

MC-US 1L

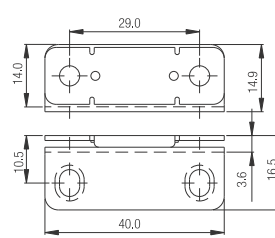

MC-US 2L

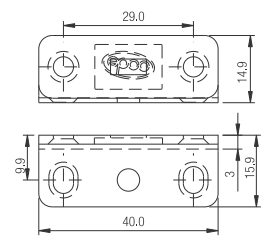

MC-I1

## VENTILATION GRILL DIA 40mm



Code Nos.

VG40

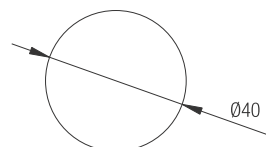

Cutout Dimensions

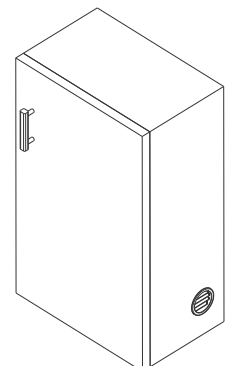

## VENTILATION GRILL - RECTANGULAR



Code Nos.

VG34168



**FITTING INSTRUCTIONS**

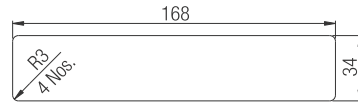

Routing Dimensions

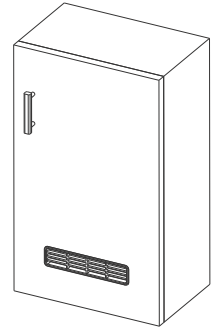

## BUMPERS

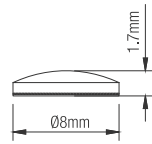

Code No.: BS1-7  
Size: Ø8 x 1.7mm

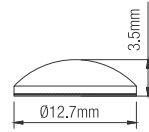

Code No.: BS1-18  
Size: Ø12.7 x 3.5mm

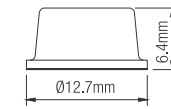

Code No.: BS1-29  
Size: Ø12.7 x 6.4mm

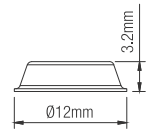

Code No.: BS2-1  
Size: Ø12 x 3.2mm

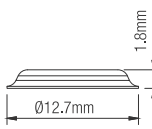

Code No.: BS2-5  
Size: Ø12.7 x 1.8mm

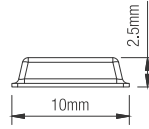

Code No.: BS2-20  
Size: 10 x 2.5mm

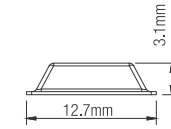

Code No.: BS2-32  
Size: 12.7 x 3.1mm

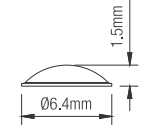

Code No.: BS2-6  
Size: Ø6.4 x 1.5mm

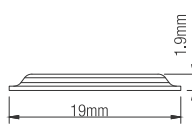

Code No.: BS2-34  
Size: Ø19 x 1.9mm

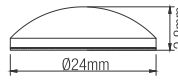

Code No.: BS2-35  
Size: Ø24. x 2.8mm

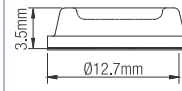

Code No.: BS1-19  
Size: Ø12.7 x 3.5mm

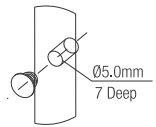

Code No.: CB5  
Size: Ø5 x 7mm deep



**FITTING INSTRUCTIONS**

## SLIDING CABINET SHUTTER FITTING



Item	Code Nos.	Finish
Sliding Cabinet Shutter Fitting	SCF-1	WH / BR
Aluminium Rail 2.44mtr. / 3mtr.	SCF-A1	AS
	SCF-A1-3M	AS
PVC Rail 2.44mtr.	SCFP-1-2	WH/ BR
PVC Rail 3.66mtr.	SCFP-1-3	WH/ BR

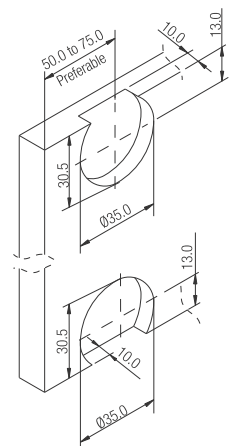
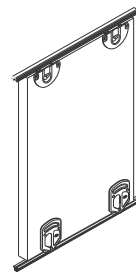

**FITTING INSTRUCTIONS**



## HI SLIDE 50 REVERSIBLE - SOFT CLOSE



Item	Code Nos.	Length (m)	Finish
Hi Slide 50 -Reversible Soft Close - 2 Doors	HS50R-2	-	GR
Hi Slide 50 -Reversible Soft Close - 3 Doors	HS50R-3	-	
Al. Profile Track (2/3 Doors)	HS50R-T2	2.44	AS
	HS50R-T3	3.66	
Al. Profile Track for HS50 PRT	HS50T2D-T2	2.44	
	HS50T2D-T3	3.66	
Al. Profile Track for 25mm shutter	HS50R-25-T2	2.44	
	HS50R-25-T3	3.66	

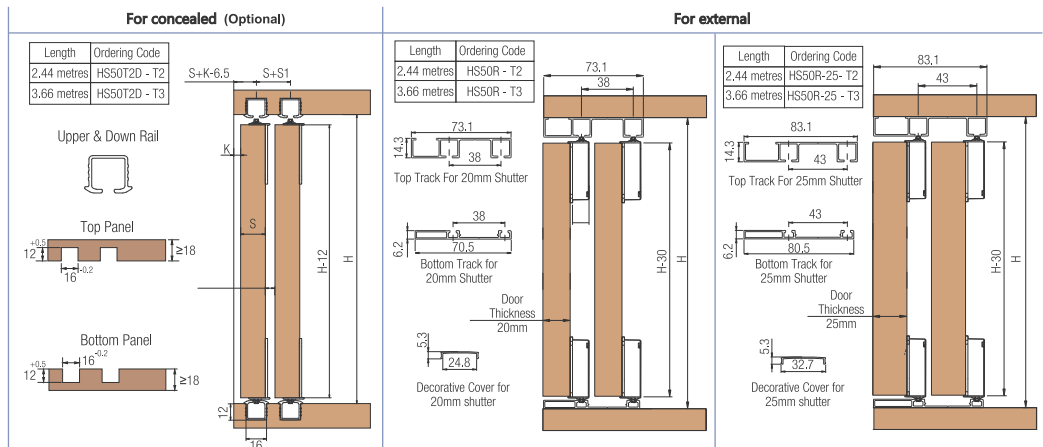

## HI SLIDE 45 REVERSIBLE - SOFT CLOSE



Item	Code Nos.
Hi Slide 45 - Reversible Soft Close - 2 Doors (Complete 2 Door Fittings With Soft Close Attachments)	Z-HS45R-2
Hi Slide 45 - Reversible Soft Close - 3 Doors (Complete 3 Door Fittings With Soft Close Attachments)	Z-HS45R-3
Aluminium Profile Track for Z-HS45R for 2 Doors & 3 Doors (Set of Top & Bottom Tracks with Decorative Cover in 2.44 metres)	Z-HS45R-T2
Aluminium Profile Track for Z-HS45R for 2 Doors & 3 Doors (Set of Top & Bottom Tracks with Decorative Cover in 3.66 metres)	Z-HS45R-T3

Wardrobe size, for Surface Installation  
(W = Cabinet Width = Rail Length)

Length	Internal Code
2.44 metres	Z-HS45R-T2
3.66 metres	Z-HS45R-T3

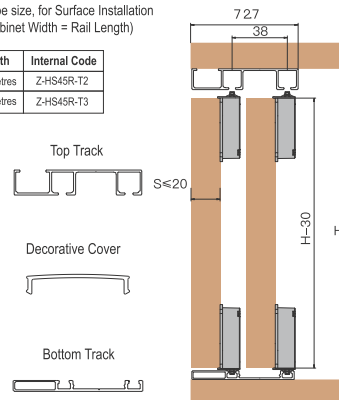

## RECESSED HANDLE 90mm

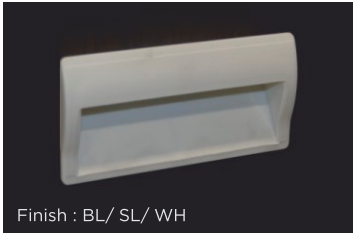

Finish : BL/ SL/ WH

Code No.

RH-90

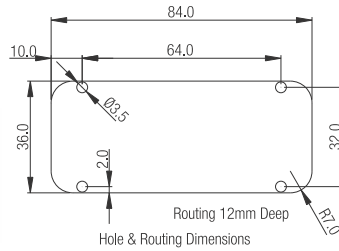

Application for  
Drawer Shutter

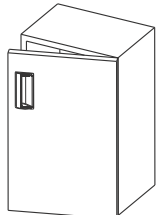

Application for  
Cabinet Shutter

## RECESSED HANDLE - STEEL FURNITURE

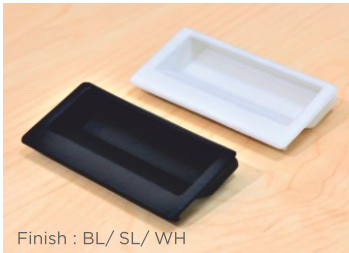

Finish : BL/ SL/ WH

Code No.

RHS - 94

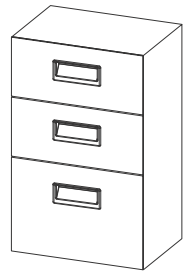
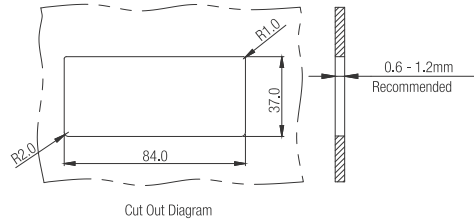

## ZINC HANDLE - Q



Finish : NB

Code Nos.

QZHE-96-NB

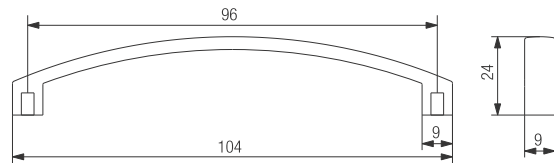

## ZINC HANDLE - E



Finish : NB

Code Nos.

EZHE-96-NB

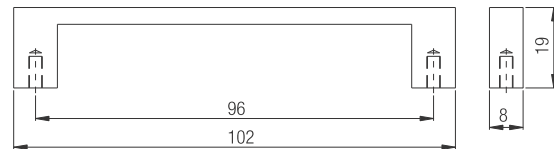

## TONGUE HANDLE



Finish : BL/BR/WM/SL

Code Nos.	'A' in mm	'B' in mm
TOH32-1	50.0	32.0
TOH64-1	82.0	64.0

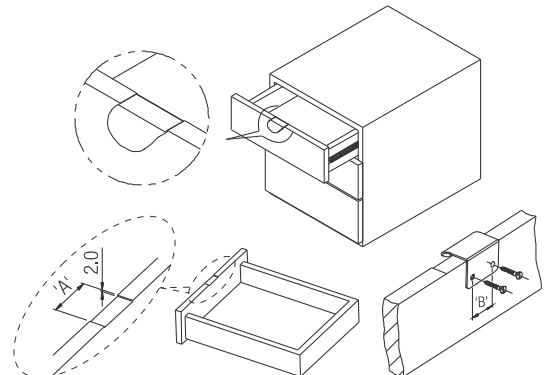

## FRONT MULTI DRAWER LOCK



Code Nos.	Finish
P-FMDL-48-22*	NP
P-FMDL-58-22*	
P-FMDL-58-SF*	
MDLK-P	

\*Add after code K3/K5 for 3/5 keys and FL for Flip Key

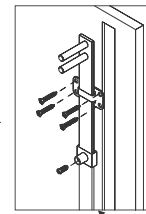
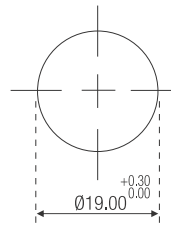

Width -16  
3mm deep

**FITTING INSTRUCTIONS**



**Secutek**  
LOCKS

## FRONT MULTI DRAWER LOCK



Code Nos.	Finish
FMDL48	NP
FMDL58	NP
MDLK-S	NY

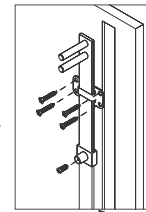
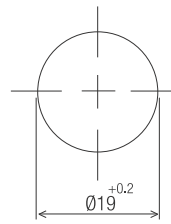

Width -16  
3mm deep

**FITTING INSTRUCTIONS**



## FRONT MULTI DRAWER LOCK



Code Nos.	Finish
E-FMDL48	NP
E-FMDL48-M	
E-FMDL58	
E-FMDL58-M	

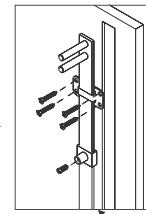
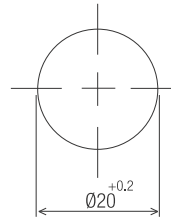

Width -16  
3mm deep

**FITTING INSTRUCTIONS**



**TARGET**  
LOCK

## FRONT MULTI DRAWER LOCK



Code Nos.	Finish
Z-FMDL60	NP

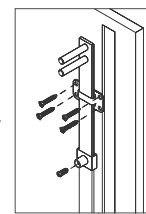
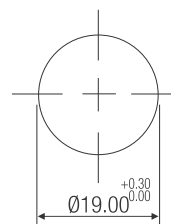

Width -16  
3mm deep

**FITTING INSTRUCTIONS**



**zipco**

## SQUARE LOCK - 22/32mm



Code Nos.	Finish
Z-SQL1-22	NP
Z-SQL1-32	

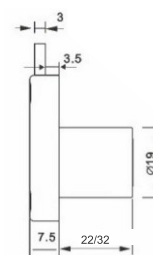
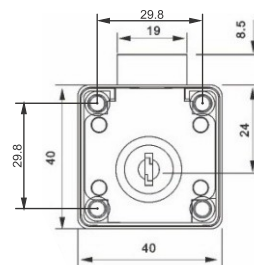

**FITTING INSTRUCTIONS**



**zipco**

## SQUARE LOCK POPULAR



Code Nos.	Finish
Z-SQLP1-22	NP

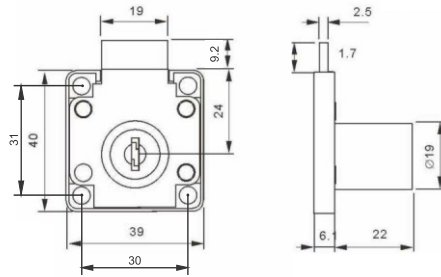

zipco®



## SQUARE LOCK

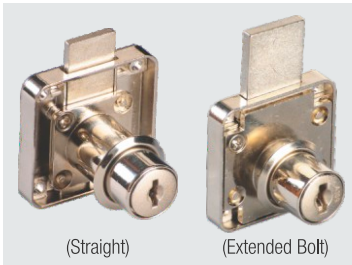

Code Nos.	Finish
P-SQL1-22S*	NP
P-SQL1-22EB*	
P-SQL1-32L/R*	

\*Add after code K3/K5 for 3/5 keys and FL for Flip Key

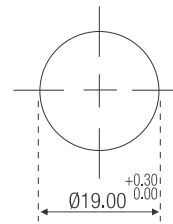

PREMIUM FURNITURE LOCKS



## SQUARE LOCK



Code Nos.	Finish
SQL1-22	NP
SQL1-22-S12	
SQL1-32	
SQL1-22M	
SQL1-22P	

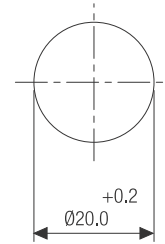

Secutek LOCKS



## SQUARE LOCK



Code Nos.	Finish
E-SQL1-22	NP
E-SQL1-22-M	
E-SQL1-32	
E-SQL1-32-M	

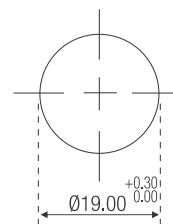

TARGET LOCK



## PEDESTAL LOCK



Code Nos.	Finish
P-MPL2-22*	NP
P-MPL2-SF*	

\*Add after code K3/K5 for 3/5 keys and FL for Flip Key

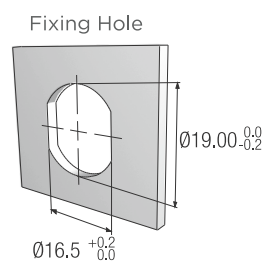

PREMIUM FURNITURE LOCKS



## PEDESTAL LOCK



Code Nos.	Finish
MPL2-22	NP
MPL2-22M	

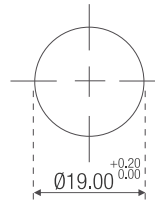

**Seculek**  
LOCKS



FITTING INSTRUCTIONS

## PEDESTAL LOCK



Code Nos.	Finish
E-MPL2-20	NP
E-MPL2-20-M	

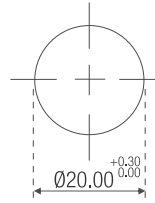

FITTING INSTRUCTIONS

## CAM LOCK

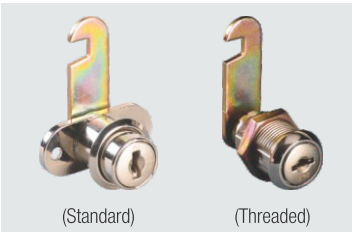

Code Nos.	Finish
P-MCL1-22*	NP
P-MCL2-25*	
P-MCL2-30*	

\*Add after code K3/K5 for 3/5 keys

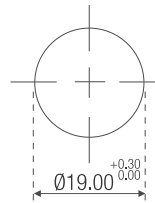

**PREMIUM**  
FURNITURE LOCKS



FITTING INSTRUCTIONS

## CAM LOCK

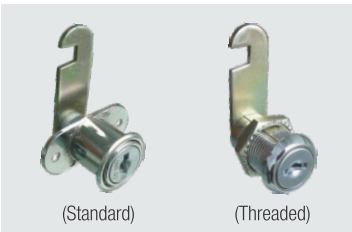

Code Nos.	Finish
MCL1-22	NP
MCL2-16	
MCL2-25	
MCL2-30	

FOR STANDARD

FOR THREADED

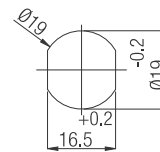
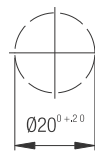

**Seculek**  
LOCKS



FITTING INSTRUCTIONS

## CAM LOCK

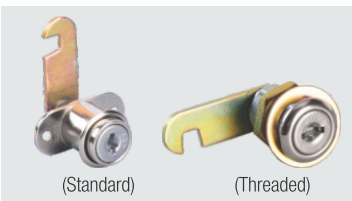

Code Nos.	øA (mm)	Finish
E-MCL1-22	20	NP
E-MCL2-16	23	
E-MCL2-25		
E-MCL2-30		

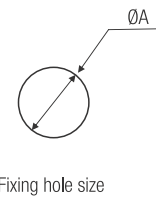

FITTING INSTRUCTIONS

## CAM LOCK - STEEL FURNITURE

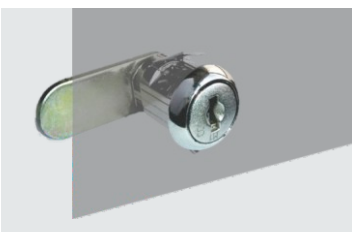

Code Nos.	Finish
MCL20-SF	NP

FOR METAL

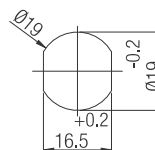

**Seculek**  
LOCKS



FITTING INSTRUCTIONS

### CAM LOCK - THREADED



Code No.	Finish
Z-MCL2-25	NP

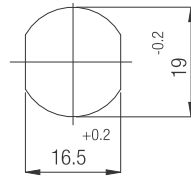

**zipco**



### CAM LATCH - STEEL FURNITURE



Code No.	Finish
CL1-SF	NP

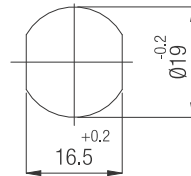

**PREMIUM**  
FURNITURE LOCKS



### PUSH LOCK



Code No.	Finish
P-MPT2-22*	NP

\*Add after code FL for Flip Key

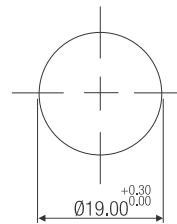

**PREMIUM**  
FURNITURE LOCKS



### PUSH LOCK



Code No.	Finish
MPT1-22	NP

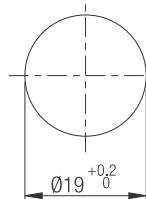

**Secutek**  
LOCKS



### PUSH LOCK



Code No.	Finish
E-MPT1-22	NP

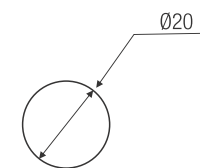

Fixing hole size

**TARGET**  
LOCK



## PUSH & TURN LOCK



Code No.	Finish
P-MPT1-22	NP

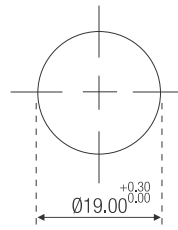

## PUSH LATCH - BIG/SMALL



Code Nos.	Finish
PLB-25-30	SC
PLS-25-30	

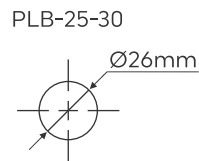
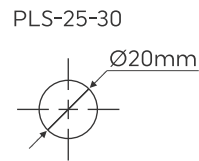

## CUPBOARD LOCK



Code Nos.	Finish
CSQL1	NP
CSQL1LK	

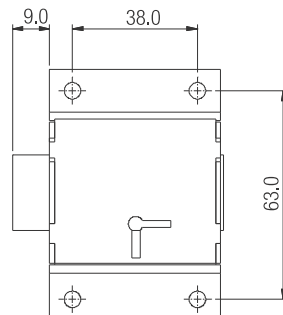

## CUPBOARD SLIDING LOCK



Code Nos.	Finish
CSL1-25-S2	NP

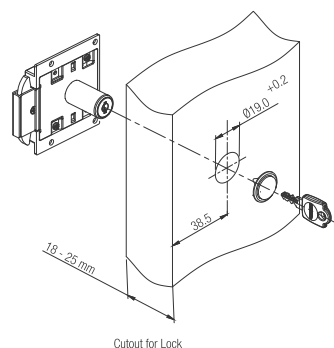

## CUPBOARD LOCK FOR STEEL CABINET - 2

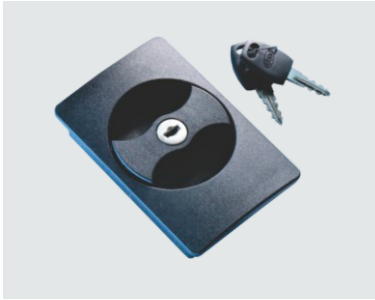

Code Nos.	Finish
CSQL2-SF	BL

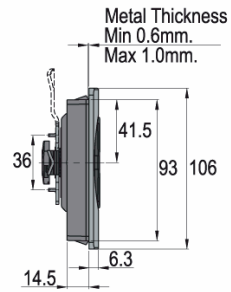

PREMIUM FURNITURE LOCKS



## CUPBOARD LOCK FOR STEEL CABINET - 3



Code No.	Finish
CSQL3-SF	NP

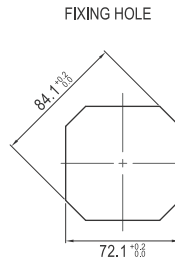

PREMIUM FURNITURE LOCKS



## 4 DIGIT COMBINATION LOCK - WOOD (L) / PEDESTAL (L/R)



Code Nos.	Finish
P-CLW4-18L-WH	WH
P-CLW4-18R-AT	AT
P-CLP4-18L-AT	AT
P-CLP4-18R-AT	

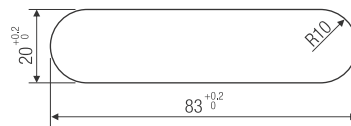

## 3 DIGIT COMBINATION LOCK - WOOD (L) / PEDESTAL (R)

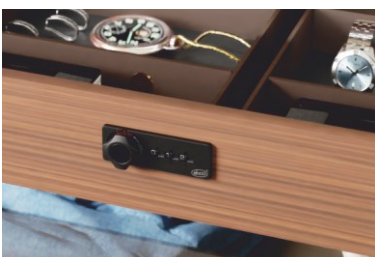

Code Nos.	Finish
P-CLW3-18L-BL	BL
P-CLP3-18R-BL	BL

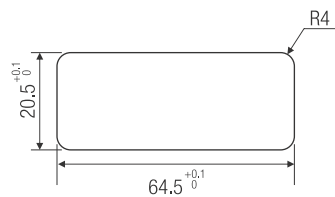



### 4 DIGIT COMBINATION LOCK - WOOD (VERTICAL)



Code Nos.	Finish
P-CLWV418-L-AT	AT
P-CLWV418-R-AT	

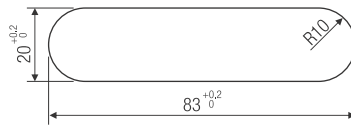

### 4 DIGIT COMBINATION LOCK - 2 POINT SWING ( WITH ROD)



Code Nos.	Rod Height	Finish
P-CLWL2S-20	2.5mtrs	BL

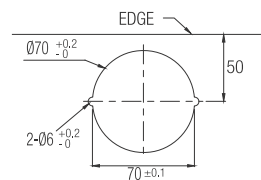

### 4 DIGIT COMBINATION LOCK - WARDROBE 2 POINT INSET (WITH ROD)



Code Nos.	Rod Height	Finish
P-CLWL2-20	2.5mtrs	BL

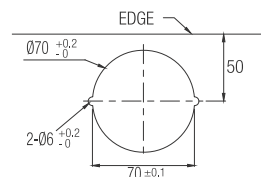

### 4 DIGIT COMBINATION LOCK - STEEL CUPBOARD



Code No.	Finish
P-CLSC - 4	BL

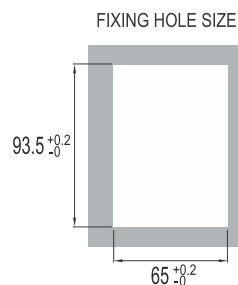

### WARDROBE LOCK 2 POINT - INSET (22mm)

zipco®



Code No.	Finish
Z-WL-2-22-I	ZW

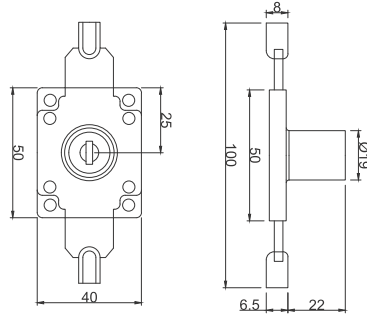

### WARDROBE LOCK - 3 POINT

PREMIUM  
FURNITURE LOCKS



Code No.	Finish
P-WL3-22-20	NP

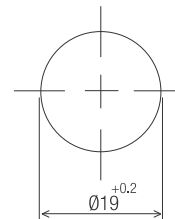

### STEEL CABINET LOCK CUM HANDLE (SET)



Code Nos.	Metal Thickness	Finish
P-SL1	0,6-0,9mm	BL
P-SH1		

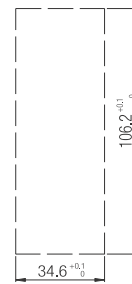

FIXING DETAILS  
t = 0.6 - 0.9 mm.







**EBCO Pvt. Ltd**

402-403, 502, Hyde Park, Saki Vihar Road, Andheri (E), Mumbai 400072, INDIA.

Reach us at [info@ebco.in](mailto:info@ebco.in) or call [+91-22-6783 7777](tel:+91-22-67837777) | Toll free [1800 120 1122](tel:18001201122) | Web [ebco.in](http://ebco.in)

