



*Simplifying **lives.***

HARDWARE SOLUTIONS



DRAWER SLIDES AND HINGES



GENERAL HARDWARE



JOINERY FITTINGS & SCREWS



FURNITURE LOCKS



RETAIL DISPLAY SYSTEMS



WINDOW, DOOR & GLASS HARDWARE



ISO 9001: 2015
Quality
Management
System



ISO 14001: 2015
Environmental
Management
System



BS OHSAS 18001: 2007
Occupational
Health and
Safety Management
System

SINCE 1963

MANUFACTURING QUALITY
PRODUCTS, PROTECTING
THE ENVIRONMENT AND
NURTURING OUR PEOPLE
HAVE ALWAYS BEEN OUR
PRIORITIES.



2015



2010



2004



1996



1987



1969

Over 50 Years of Continuous Innovation.

Ebco began its journey in 1963 as a Tool Room and has since become India's leading manufacturer in the Hardware Fittings industry. Our latest range of Intelligent Home & Office Hardware Fittings is just another step towards making the lives of millions simpler with Worksmart and Livsmart.



INTELLIGENT HARDWARE FOR HOMES



ERGONOMIC HARDWARE FOR OFFICES

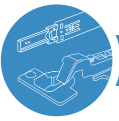

DRAWER SLIDES AND HINGES

DRAWER SLIDES

01

PREMIUM SLEEK TELESCOPIC SLIDES - SOFT CLOSE



WIDEST RANGE:

- Over 600 variations.
- Load Capacity from 10kg to 125kgs.
- Lengths from 200mm to 900mm.

ADVANCED TECHNOLOGY:

- Available in Regular, Soft-Close, Push-Open & Push + Soft mechanisms.

CYCLE TESTED:

- As per BIFMA & FIRA norms

03

FULL PANEL DRAWER SLIDE



07

SLEEK TELESCOPIC DRAWER SLIDE - 45KG (SS304)



04

FULL PANEL QUICK FIT



08

STEEL FURNITURE DRAWER SLIDE



02

BOTTOM MOUNTING DRAWER SLIDE



05

SLEEK TELESCOPIC DRAWER SLIDE - 35KG



09

SLEEK TELESCOPIC DRAWER SLIDE (I) 35 - SOFT CLOSE



06

SLEEK TELESCOPIC DRAWER SLIDE (I) 35/45 KG



10

SLEEK TELESCOPIC DRAWER SLIDE SS 304 SOFT CLOSE



01 - Size (L): 300, 350, 400, 450, 500, 550, 600 mm. Load Capacity: 45kgs Finish: Zinc White. **02** - Size: 300, 350, 400, 450, 500, 550, 600mm. Load Capacity: 20kgs Finish: Ivory, Brown & Black. **03** - Size (H): 54mm (L): 300-500mm. Size (H): 86 & 125mm (L): 300-550mm. Size (H): 150mm (L): 350-500mm. Capacity: 25kgs. Finish: Ivory **04** - Size (H): 54, 86, 125mm (D): 400, 450mm (W): 400, 450mm Load Capacity: 25 kgs Finish: Ivory. **05** - Size (L): 350, 400, 450, 500, Load capacity : 35 Kgs. Finish: Zinc White **06** - Size (L): 250, 300, 350, 400, 450, 500, 550, 600, 750, 900 mm. STDS (I) 35 also available in 200mm. Load Capacity: 35Kgs/45Kgs Finish: Zinc White/Black **07** - Size (L): 400, 450, 500, 550mm Load Capacity: 45kgs Finish: Stainless Steel **08** - Size (L): 400, 450, 500, 550mm. Load Capacity: 35kgs. Finish: Zinc White **09** - Size (L): 300, 350, 400, 450, 500, 550, 600 mm Load Capacity: 35kgs Finish: Zinc White **10** - Size (L): 400, 450, 500mm. Load Capacity: 45kgs Finish: Stainless Steel

CONCEALED DRAWER SLIDE SLIM - 2

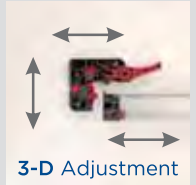

FEATURES

- Highly stable and uses minimal space below the drawer (27mm clearance).
- Available with fascia bracket for wooden drawers and without fascia bracket for kitchens baskets.
- Full extension with soft close and tool free assembly and removal of drawers.
- Unique 3D adjustable clip for perfect alignment.
- Load Capacity- 35kgs.

Load Capacity - 35 Kgs



11 - Size (L): 400,450,500 mm
Load Capacity: 45kgs. **Finish:** Zinc White.

12 - Size (L): 450, 500, 600, 750, 900 mm. **Load Capacity:** 90kgs. **Finish:** Zinc White.

13 - Size (L): 450, 500, 550, 600, 750, 900 mm. **Load Capacity:** 125kgs. **Finish:** Zinc White.

14 - Computer Keyboard Slide Size (L): 350, 450. **Load Capacity:** 35kgs. **Finish:** Zinc White/Black.

Computer Keyboard Slide Eco & (I) Series - Size (L): 350 mm. **Load Capacity:** 12kgs. **Finish:** Zinc White/Black.

15 - Size (L): 250mm. **Load Capacity:** 12kgs. **Finish:** Black.

16 - Size (L): 200, 400mm **Load Capacity:** 10kgs **Finish:** Zinc White/Black

17 - Size (L): 200, 300, 375, 420 mm. **Load Capacity:** 12kgs. **Finish:** Zinc White/Black.

11

PREMIUM SLEEK TELESCOPIC SLIDE - PUSH OPEN



13

HEAVY DUTY DRAWER SLIDE - 125KG



15

COMPUTER KEYBOARD SLIDE WITH FULL EXTENSION



12

HEAVY DUTY DRAWER SLIDE - 90KG



14

COMPUTER KEYBOARD SLIDE / COMPUTER KEYBOARD SLIDE ECO & (I) SERIES



16

MINI TELESCOPIC DRAWER SLIDE



17

TWO WAY SLIDE



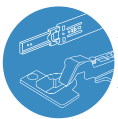

DRAWER SLIDES AND HINGES

HINGES

01 HINGE SLOW MOTION - 3D

WIDEST RANGE:

- Over 250 variations for Wooden, Glass, Aluminium Shutters & special applications.
- For shutter thickness from 4mm to 40mm.

ADVANCED TECHNOLOGY:

- Option of Auto Close, Soft Close & Push Open
- Special hinges for special applications and opening angle.

CYCLE TESTED:

- As per BIFMA & FIRA norms



07

EURO SLO-MOTION HINGE SS304 / EURO SLO-MOTION HINGE SS304 WITH 4-HOLE MOUNTING PLATE



12

FOLDING DOOR HINGE



08

HINGE SLO-MOTION - SS304 (with 4 Hole Mounting Plate)



13

FOLDING DOOR HINGE (I)



02

SLIP ON HINGE - EURO



03

CLICK ON HINGE (I)



04

EURO SLIP-ON HINGE - SS 304 / EURO SLIP-ON HINGE-SS 304 WITH 4-HOLE MOUNTING PLATE



09

HINGE SLO-MOTION



14

BLIND CORNER HINGE - EURO



01 - Max Opening: 105°. Shutter Size: 34" x 22" (850mm x 550mm) for 2 hinges. Shutter Thickness: 16 to 19mm. Shutter Cavity: Ø35mm, 12mm deep, 4mm from edge

02 - Max opening: 105°. Shutter size: 34" x 22" (850mm x 550mm) for 2 hinges. Shutter Thickness: 16mm to 19mm. Shutter cavity: Ø35mm, 12mm deep, 4mm from edge. Available in 4 hole mounting plate.. **03** - Max

Opening: 105°. Shutter Size: 34" x 22" (850mm x 550mm). Shutter Thickness: 16 to 19mm. Shutter Cavity: Ø35mm, 12mm deep, 4mm from edge. **04** - Max Opening: 105°. Shutter Size: 34" x 22" (850mm x 550mm). Shutter Thickness: 16 to 19mm. Shutter Cavity: Ø35mm, 12mm deep, 4mm from edge

05 - Unique built in damping system allows the shutter to close in slow motion without banging. Available in Full overlay, Half overlay and Inset. Finish: Nickel Plated & Anthracite

06 - Max Opening: 105°. Shutter Size: 34" x 22" (850mm x 550mm). Shutter Thickness: 16 to 19mm. Shutter Cavity: Ø35mm, 12mm deep, 4mm from edge. Available in 4 hole mounting plate. **07** - Max Opening: 105°. Shutter Size: 34" x 22" (850mm x 550mm). Shutter Thickness: 16 to 19mm. Shutter Cavity: Ø35mm, 12mm

deep, 4mm from edge. **08** - Max. opening: 105°. Shutter size: 34" x 22" (850 mm x 550 mm) for 2 hinges. Shutter thickness: 16 to 19mm. Shutter cavity: Ø35mm, 12mm deep, cavity 4mm from edge.. **09** - Max Opening: 105°. Shutter Size: 34" x 22" (850mm x 550mm). Shutter Thickness: 16 to 19mm. Shutter Cavity: Ø35mm, 12mm deep, 4mm from edge. **10** - Max. Opening: 105°. Shutter Size: 34" x 22" (850mm x 550mm) for 2 hinges. Shutter Thickness : 16mm to 19mm. Shutter cavity: Ø35mm,

12mm deep, 4mm from edge. **11** - Max Opening: 100°. Shutter Size: 24" x 18" (600mm x 450mm). Shutter Thickness: 12 to 18mm. Shutter Cavity: Ø26mm, 10mm deep, 4mm from edge. **12** - Max Opening: 180°. Shutter Thickness: 15 to 23mm. **13** - Max Opening: 180°. Shutter Thickness: 16 to 26mm. **14** - Max Opening: 105°. Shutter Size: 34" x 22" (850mm x 550mm). Shutter Thickness: 16 to 19mm. **15** - Max Opening: 100°. Shutter Size: 34" x 22" (850mm x 550mm). Shutter Thickness: 16 to 19 mm. **16** - Max Opening: 105°. Shutter Size: 34" x 22" (850mm x 550mm). Shutter Thickness: 16 to 19 mm.

05 - Unique built in damping system allows the shutter to close in slow motion without banging. Available in Full overlay, Half overlay and Inset. Finish: Nickel Plated & Anthracite

06 - Max Opening: 105°. Shutter Size: 34" x 22" (850mm x 550mm). Shutter Thickness: 16 to 19mm. Shutter Cavity: Ø35mm, 12mm deep, 4mm from edge. Available in 4 hole mounting plate. **07** - Max Opening: 105°. Shutter Size: 34" x 22" (850mm x 550mm). Shutter Thickness: 16 to 19mm. Shutter Cavity: Ø35mm, 12mm

deep, 4mm from edge. **08** - Max. opening: 105°. Shutter size: 34" x 22" (850 mm x 550 mm) for 2 hinges. Shutter thickness: 16 to 19mm. Shutter cavity: Ø35mm, 12mm deep, cavity 4mm from edge.. **09** - Max Opening: 105°. Shutter Size: 34" x 22" (850mm x 550mm). Shutter Thickness: 16 to 19mm. Shutter Cavity: Ø35mm, 12mm deep, 4mm from edge. **10** - Max. Opening: 105°. Shutter Size: 34" x 22" (850mm x 550mm) for 2 hinges. Shutter Thickness : 16mm to 19mm. Shutter cavity: Ø35mm,

05

E SOFT LINEAR HINGE - 3D



10

HINGE PUSH OPEN



15

BLIND CORNER HINGE - SOFT CLOSE



06

EURO SLO-MOTION HINGE



11

MINI HINGE



16

45° CROSS CORNER HINGE - EURO



HINGES



PIVOT HINGE WITH SPRING (FOR STEEL FURNITURE)



- Ideal for steel cabinet.
- Spring loaded latch mechanism for long lasting uses.
- Easy to use.

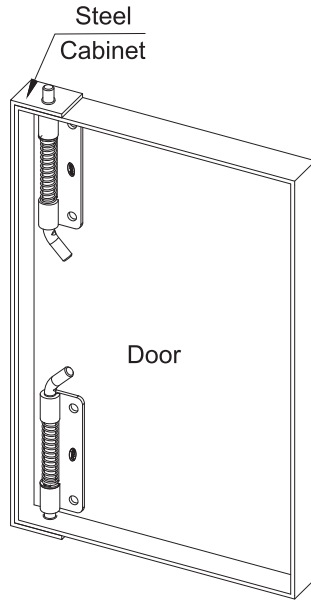

SPECIALITY HINGES

24

CRANKED HINGE



29

GLASS DOOR HINGE (SOFT CLOSE) - Ø 35



25

SPRING LOADED HINGE



30

270° HINGE



17

PIVOT HINGE



18

165° HINGE (I)



21

THICK DOOR HINGE - SOFT CLOSE



26

INLINE HINGE



HINGE ACCESSORIES



DOWEL FOR HINGE - EURO



Ø 35MM COVER

25 - Max Opening: 180°. Finish: Nickel plated, White Mat, Black, Brown, Anthracite

26 - • Ideal for folding shutters • Spring loaded with adjustment. • Used in walk in closets.

27 - Shutter Size: 800mm x 350mm. Shutter Thickness: 4 to 6mm. Shutter Cavity: No cavity required.

28 - Max. opening : 100°. Shutter size : 600mm x 350mm. Shutter Thickness: 4 to 6mm. Shutter cavity : Ø26mm, 4mm from edge.

29 - Max. opening : 105°. Shutter size: 600mm x 400mm. Shutter Thickness: 4 to 6mm. Shutter cavity : Ø35mm, 4mm from edge.

30 - Max. opening : 270°. Shutter size : 34" x 22" (850mm x 550mm). Shutter Thickness: 16 to 19mm. Shutter cavity: Ø35mm, 12mm deep.

CABINET HINGE



- Basic hinge for multiple applications
- Designed for Overlay Shutters of 18mm or less 180° opening angle.
- Horizontal & Vertical adjustments provided.

19

165° HINGE - SOFT CLOSE



22

SHORT ARM HINGE WITH 4 HOLE MOUNTING PLATE



27

GLASS HINGE - INSET



20

THICK DOOR HINGE



23

SHORT ARM HINGE WITH 4 HOLE MOUNTING PLATE -SS304



28

GLASS DOOR HINGE - Ø 26



17 - Max Load: 6 Kgs/set Finish: SS 304. **18** - Max Opening: 165°. Shutter Size: 85" x 24" (2135mm x 600mm). Shutter Thickness: 16 to 26 mm. Shutter Cavity: Ø35mm, 12mm deep, 4mm from edge. **19** - Max Opening: 165°. Shutter Size: 85" x 24" (2135mm x 600mm). Shutter Thickness: 16 to 26 mm. **20** - Max Opening: 100°. Shutter Size: 34" x 22" (850mm x 550mm). Shutter Thickness: 18 to 30mm. Shutter Cavity: Ø40mm, 14mm deep, 4mm from edge. **21** - Max Opening: 95°. Shutter Size: 34" x 22" (850mm x 550mm). Shutter Thickness: 18 to 30mm. Shutter Cavity: Ø40mm, 14mm deep, 4mm from edge. **22** - Max Opening: 100°. Shutter Size: 34" x 22" (850mm x 550mm) for 2 hinges. Shutter Thickness: 16 to 19mm. Shutter Cavity: Ø35mm, 14mm deep, 4mm from edge. **23** - Max Opening: 100°. Shutter Size: 34" x 22" (850mm x 550mm) for 2 hinges. Shutter Thickness: 16 to 19mm. Shutter Cavity: Ø35mm, 14mm deep, 4mm from edge. **24** - Max Opening: 180°. Finish: Nickel plated, White Mat, Black, Brown, Anthracite



GENERAL HARDWARE



FOLDING DINING TABLE

- Space saving solution for a fold-away dining table with special release knob feature that folds the table when not in use.
- Sizes Available - 600, 750, 900 & 1200mm.
- Max. load: 70kgs.
- Finish: Anthracite

01 TABLE BRACKET / TABLE BRACKET MINI



02 TABLE BRACKET RECESSED



03 FOLDING TABLE MOUNT



Open



Folded

04 MULTI UTILITY FOLDING BRACKET



05 AC MOUNTING BRACKET



09 CABINET STAY



10 CABINET STAY - HEAVY



06 TABLE LIFT - 200 TABLE LIFT - 200 WITH DAMPER



07 PRO-LIFT / PRO LIFT PROGRESSIVE

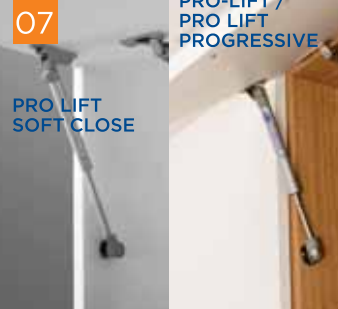

PRO LIFT
SOFT CLOSE

11 LID STAY



08 PRO LIFT HEAVY DUTY

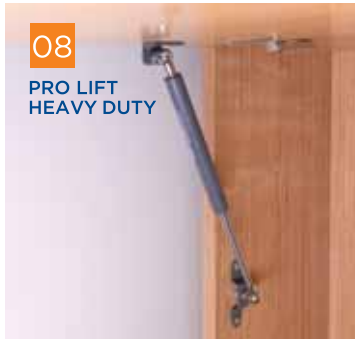

12 FLAP STAY



01 - Size: 300, 400, 500, 600mm. Max. load: 300/400/500mm - 100kgs, 600mm - 150kgs. Finish: Anthracite/Brown/White Matt. **02** - Size: 300, 400, 500mm. Max. Load: 100 kgs. Finish: Anthracite/Brown/White Matt. **03** - Size: Ø76mm, 154 x 154mm. Finish: Black. **04** - Size: 340mm - 500mm. Max. Load: 120 kgs. Finish: Black. **05** - Size: 500mm. Max. Load: 120 kgs. Finish: White Texture. **06** - Load Capacity 11 kgs. max. Recommended Table Size: 4 x 2 feet. Lift up by 200mm. Finish: Table Lift 200- Black/Anthracite. Table Lift 200 with Damper - Anthracite. **07** - Force: 60N, 80N, 100N, 120N, 150N. Pro-Lift/Pro-Lift Progressive available in 200N & 250N as well **08** - Finish: Anthracite. Force: 250N, 300N, 350N **09** - Max. Load: 4kgs with one stay. 7kgs with 2 stays. Finish: Nickel Plated. **10** - Max. Load: 6kg/each. Finish: Nickel Plated. **11** - Finish: SS304 **12** - Size: Regular/Large/Ex-Large. Finish: Plated/ Brown. Load: 12kgs

PLINTH BASE - ADJUSTABLE



FURN FELT



CABINET SHELF SUPPORT / CABINET SHELF SUPPORT-ECO



15

FURNITURE BASE LEVELLER



GLASS SHELF SUPPORT & GLASS SHELF SUPPORT (SCREW)



Plinth Screw - BB



Plinth Screw

16

SOFA BASE 332 & 282

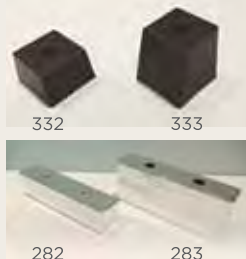

PIN SHELF SUPPORT

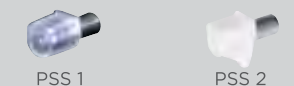

18

ADJUSTABLE GLASS SHELF SUPPORT



13

BALL HEAD PLINTH SCREW



14

BASE PLINTH



17

PEDESTAL CASTOR/ PEDESTAL CASTOR RECESSED



19

GLASS SHELF BRACKET



PLINTH BUSH



PLINTH BUSH WITH PIN



PLINTH PIN



13 - Load Capacity: 800kgs/ piece

14 - Load Capacity: BP 16 - 1000kgs / piece, BP 1418 - 1200kgs / piece

15 - Size: Ø53, Ht 23mm to 33mm. Finish: Black/Silver

16 - Easy to mount foot base for sofas and cabinets. Size: SB 332: 70x70x45mm, SB 333: 70x70x75mm, Finish: Brown. SB282: 45x200x25. Finish: Chrome Plated. SB282: 45x200x75. Finish: Silver Plated. Load Capacity: 500kg/pc

17 - Load Capacity: Static - 500kgs, Dynamic - 300kgs. Set Height: 28mm (PC28), 10mm (PCR60). Finish: Black

18 - Size: 6mm - 12mm. Finish: Silver/Nickel Plated

19 - Size: 8mm, 10mm, 12mm. Finish: Nickel Plated Satin



GENERAL HARDWARE

SMART KEY BOX



Combination Locks specifications:

- Keyless Operation
- Up to 10,000 combinations
- Code setting without tools
- Code finding from the front by recovery key
- Anti-Bacterial Plastic Key Cap with Microban® Technology inhibits bacterial growth by 99%
- Can hold 20Keys
- Ideal application in Office, Residences, Clubs, Gyms, Wallet Parking etc.
- Key box Dimension: 200x160x75.5mm
- Finish: Anthracite / White



CAR SERVICE



OFFICE

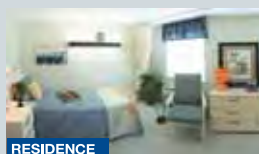

RESIDENCE



LOCKER ROOM

27

VENTILATION GRILL - DIA 40MM



28

VENTILATION GRILL - RECTANGULAR

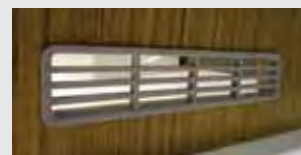

20

WALL SHELF ROD - HD



23

GLASS CORNER HOLDER / GLASS CORNER HOLDER - ECO



29

CUPBOARD LATCH



Latch - Straight

Latch - Cranked

21

WALL SHELF ROD



22

WALL SHELF ROD ADJUSTABLE



24

GLASS SIDE HOLDER



25

GLASS CLAMP



30

TONGUE HANDLE



31

GLASS HANDLE



20 - These are heavy duty, plastic cover moulded, built in with plug and with better grip. **Size:** Ø10 x 100, Ø10 x 145, Ø 14 x 140. **Finish:** Brown.
21 - **Size:** 100mm,150mm. **Finish:** Zinc Plated Yellow. **22** - **Size:** 150, 200, 250mm. **Finish:** Zinc Plated White. **23** - **Size:** 4mm. **Finish:** Ivory/Clear.
24 - **Size:** 4mm. **Finish:** Ivory/Clear. **25** - **Size:** 4mm. **Finish:** Clear.
26 - **Max. Shutter Size:** Cabinet: 850x550mm (34"x22"), Cupboard: 2000x750mm (80"x30") **Finish:** Zinc Plated White. **27** - **Finish:** Black/Grey/White. **28** - **Size:** 34 X 168mm. **Finish:** Black/Grey/White.
29 - **Size:** 56, 96, 150mm. **Finish:** Zinc Plated Black & White/SS304. **30** - **Finish:** Black/Brown/Silver/ White Matt. **31** - **Finish:** Chrome Plated.
Glass Shutter Thickness: 4-6mm

26

SPRING CLIP



Cabinet

Cupboard

BOTTOM PANEL SUPPORT - 6MM



CABINET HANGER CONCEALED



- Heavy duty cabinet hanger.
- Ideal for kitchen cabinets (base unit & wall units)
- Bathroom vanity units & similar applications.
- Size: 141x 21mm.
- Load Capacity: 300kgs./pair.
- Min. Panel Thickness: 18mm.
- Finish: Mocha.
- Slides in for easy storage.

32

BAG HOOK

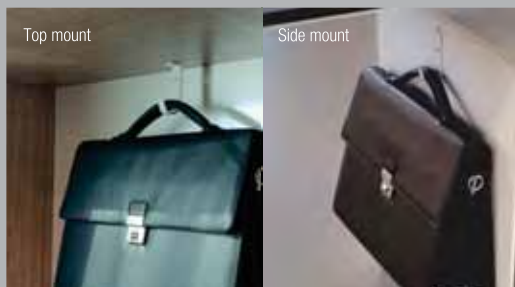

33

HANGER BRACKET



34

HANGER / HANGER PLATE



35

ADJUSTABLE CORNER BRACKET



BUMPERS



SAFETY CORNER
BUMPER S
SCB-S 35
Size: 35X35X25mm

SAFETY CORNER
BUMPER R
SCB-R 41
Size: 41X41X15mm

SAFETY DOOR
SPACER
SDS 2560
Size: 88X70X22mm

36

DOOR SEAL PROFILE

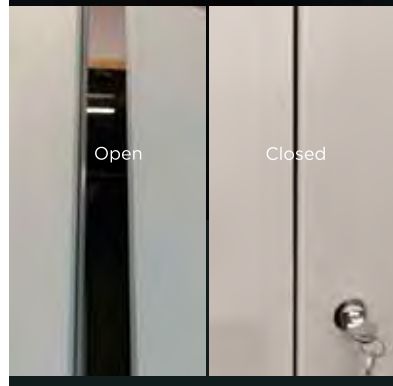

37

MIRROR HOLDER



32 - Ideal for hanging bags, helmets etc. beneath the table. Easy to mount under or on the side wall of desk.
Size: 100x20x3mm. Finish: White

33 - Size: Regular/ Mini. Load Capacity: 45kgs (Regular), 30kgs (Mini). Finish: Black/Silver.

34 - Size: Hanger - 60mm, 80mm, 100mm. Load Capacity: Hanger - 80 kgs/piece. Finish: Zinc Plated White

35 - Load Capacity: 60 kgs/piece. Finish: Plated / White

36 - Finish: Silver/Anthracite

37 - Glass Thickness: 4 to 8mm. Finish: SS304.



GENERAL HARDWARE

38

DOOR STIFFNER



42

CUPBOARD PULL-OUT



44

CORNER CLAMP



POZI SCREWDRIVER BIT (MAGNETIC)

Two Way

Two Way-Magnetic



CARBIDE STANDARD SHANK



39

DOOR STIFFNER HD



WARDROBE LATCH



45

MULTI CORNER BRACKET



48

PUSH OPEN FITTING - MAGNETIC



40

COVER FOR DOOR STIFFNER



43

BED CLAMP



46

BED CROSSBAR CLAMP / BED CROSSBAR TELESCOPE

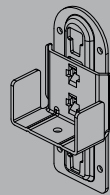

49

DOOR WEDGE



50

MAGNETIC CATCH- DOT

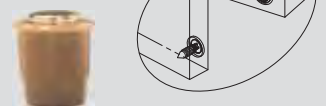

41

SLIDING CABINET SHUTTER FITTING



AUTO BOLT LATCH



51

MAGNETIC CATCH- ULTRA SLIM

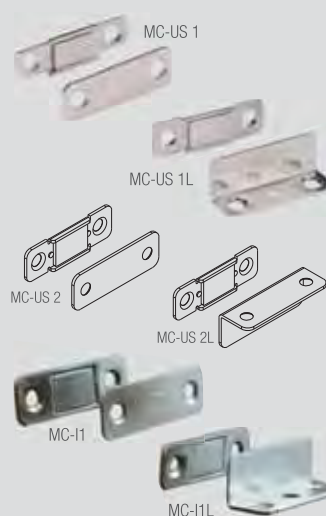

38 - Size: 2010mm. Finish: Aluminium/ Black. **39** - Size: 2010 mm. **40** - Size: 6mm. Finish: Opaline/ Silver. **41** - Finish: White/Brown. **42** - Size: 500mm. Load Capacity: 170 kgs. Finish: Powder Coated. **43** - Size: 4" and 6". Load/Set: 1200kgs. Finish: Zinc Plated Yellow. **44** - Size: 38x 38x 38mm. **45** - Size: 165 x 165x 35mm. Finish: Black/White Matt/Anthracite. **46** - Bed Crossbar Clamp Size: 140x64mm. Finish: Zinc Plated Yellow. Bed Crossbar Telescope Size: 850-1400 & 1400-1900. Finish: Anthracite. Finish: Glossy White. **47** - Size: 100, 150, 200mm. Load Capacity: 50 kgs,75 kgs, 100 kgs. **48** - Stroke: 12mm/ 40mm. Push force/ Piece: 3.5kgs (12mm), 3kgs (40mm). Finish: Grey. **49** - Size: 98 X 40mm. Finish: Brown. **50** - Size: Ø8 x 10mm. Catch Plate provided. Pull force: 750gms. Finish: White / Mocha. **51** - Pull force: MC-US 1 - 2.25kgs, MC-US 1L - 3.25kgs, MC-US 2 - 5kgs, MC-US 2L - 5.50kgs, MC- I1 - 2.50kgs, MC- I1L - 2.75kgs.

47

TURN TABLE MECHANISM





HIGH PRECISION FASTENERS

- Ideal furniture fastener providing high pull-out resistance.
- Manufacture to international specifications and standards.
- Choice of diameters & lengths ensure proper selection for each application.
- Material: C-1022 steel heat treated case hardened or SS304 grade stainless steel.



Pozi Recess CSK Head Chipboard Screw



Pozi Recess CSK Head Screw with Saw-Thread



SS304 Pozi Recess Head Chipboard Screw



Pozi Recess PAN Head Chipboard Screw



Phil Recess CSK Head Drill Screw



Phil Recess PAN Head Drill Screw



M6 Allen Socket CSK Head Screw



M4 Handle Fitting Screw

STEEL FIX AND MINI FIX



- New Steelfix Housing made out of MS is very strong & usable with existing ebco mini fix screws.

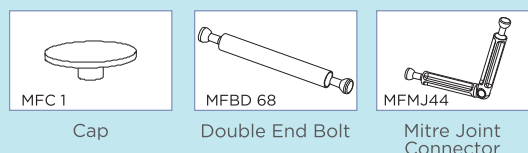
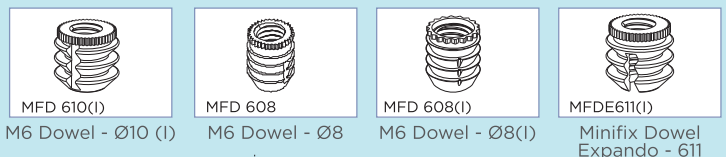
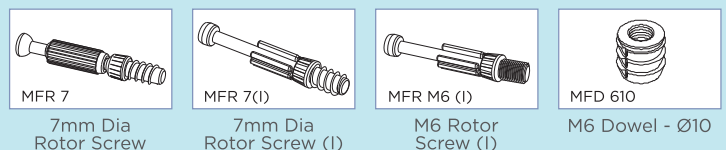
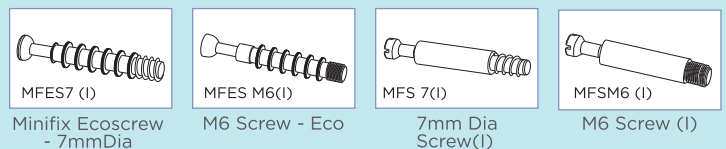
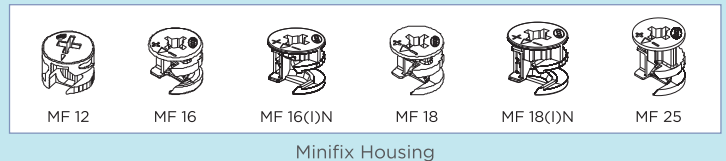
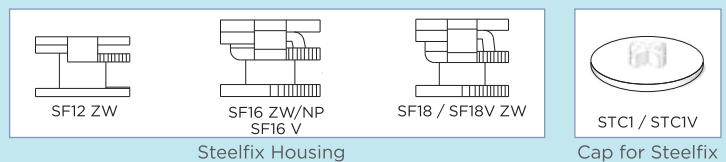



JOINERY FITTINGS & SCREWS

**SELF TAPPING
SCREWS (FLAT TIP)**



**CROSS NUT /
BARREL NUT / SLEEVE NUT**



04

**ANCHOR PLUG
WITH SCREW
HEX HD/CSK HD**



09

RIGHT ANGLE BLOCK



15

**BLOCK CONNECTOR
FITTINGS**



DOWEL FIX



**MODULAR
FURNITURE SCREW
Allen Head /
Phillips Head**



10

RIGHT ANGLE BLOCK - ECO



16

DOWELS



SELF TAPPING INSERTS



**M10 PHILIPS HEAD
SCREW & CAP**



05

MAXI CONNECTOR



11

**M4 SLEEVE CONNECTING
SCREW**



17

MODULAR CLIP



01

RIVET NUTS



06

TABLE CONNECTOR



12

**M4 CONNECTING SCREW-
ONE WAY**



18

SHELF CAM



02

**WALL PLUG/
WALL PLUG 630**



03

WALL PLUG 535



07

RIGHT ANGLE BRACKET



13

**Ø5MM INSERT SCREW /
INSERT SCREW KNURLED**



19

**CONCEALED SHELF
SUPPORT**



01 - Size: M3x8, M4x10, M5x11, M6x14, M8x15. Finish: Zinc Plated White. **02** - Size: 10x50, 6x30. Finish: Grey. **03** - Size: 5x35. Finish: White. **04** - Size: M10x100/120/140. Finish: Blue. **05** - Bolt Length: 65, 100, 150mm. Nuts Length: 10 & 17mm Finish: Zinc White. **06** - Finish: Zinc Plated Black. **07** - Sizes: 20x20, 40x40, 60x60, 80x80, 100x100, 20x40, 80x26. Finish: Zinc Plated White, SS304. **08** - Sizes: 20x20, 40x40, 25x35. Finish: Zinc Plated White. **09** - Finish: Ivory. **10** - Finish: Black. **11** - Finish: Nickel Plated. **12** - Finish: Nickel Plated. **13** - Finish: Opaline. **14** - Plug: Finish: White/ Brown, Insert: Finish: White. **15** - Finish: White. **16** - Finish: Wooden. **17** - Finish: Zinc Plated White. **18** - Finish: Frosty White. **19** - Finish: Frosty White. **20** - Finish: Zinc Plated White.

08

RIGHT ANGLE CONNECTOR



14

**Ø 5 MM PLUG /
Ø5MM INSERT**



20

PUSH FIX





FURNITURE LOCKS

PREMIUM SERIES



Special Features of Premium Locks

MASTER KEY SYSTEM:

Each batch of locks can have master key which can open every different lock from the same batch.

CORE REMOVAL SYSTEM:

Also known as 'Service Key' The core can be removed from a lock and is interchangeable with any type of locks from the premium series.

SET LOCKS:

Has a possibility of providing set locks (several locks with same key no.) in same or different type of locks from the premium series.

FOLDING KEY



FLIP KEY

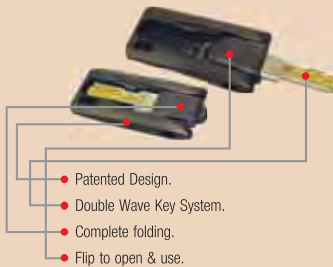

5000 COMBINATIONS



Premium Locks with "Active Pin System"



The Active Pin elevates the level of security to another level. It works instantaneously on unauthorised insertion of a different numbered key.

01

MULTI PURPOSE LOCK - ROUND



Straight



Cranked

02

SQUARE LOCK



Straight



Extended Bolt

03

FRONT MULTI DRAWER LOCK

Wooden Drawer



Steel Drawer



01 - Size: 22mm.

02 - Size : 22mm & 32mm.
Extended bolt: Extension: 21.5mm & Width-19.5mm.

03 - Size: 22mm. Height: 480mm & 580mm. Pedestal lock with locking strip available for wood and steel furniture.

STEEL FURNITURE LOCKS



FURNITURE LOCKS

PREMIUM SERIES

04

CAM LOCK



Standard



Threaded ||

09

AUTO LATCH LOCK



LOCK CORE
WITH 2 KEYS /3 KEYS



05

CAM LATCH -
STEEL FURNITURE ||



07

PEDESTAL LOCK



Wooden Drawer

Steel Drawer ||

10

PUSH & TURN LOCK



LOCK KNOB ADAPTOR /
LOCK KNOB ADAPTOR DUMMY



06

CAM LATCH - WOOD 18-20



08

GLASS DOOR LOCK



Single

Double

11

PUSH LOCK



12

WARDROBE LOCK -
3 POINT



STORAGE LOCK - 2 POINT (INSET) 1200mm

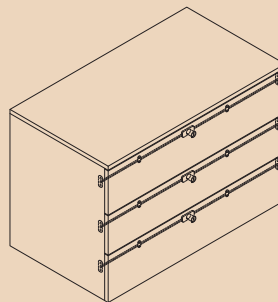

13

WARDROBE LOCK -
2 POINT INSET / OVERLAY



04 - Size: Standard 22mm & Threaded 25 / 30mm. 05 - Size: 20mm.
06 - Size: Padlock shackle. Diameter: Min. 4mm - Max. 6mm. For 18 to 20mm
board. 07 - Size: 22mm. 08 - Sizes: 9mm & 12mm. 09 - Size: 22mm. 10 - Size:
22mm. 11 - Size: 22mm. 12 - Size: 22mm & 32mm. 13 - Size: 22mm & 32mm.

|| STEEL FURNITURE LOCKS

Secutek LOCKS

- Upto 200 combinations.
- Size: 20mm
- Option of Master Key system.
- Option of set locks.
- Die cast Body.

CAM LOCK - STEEL FURNITURE ||



Size: 0.6 - 0.9mm

KEYS FOR SECUTEK LOCKS



NEW

25

SQUARE LOCK



Metal Key

29

MORTISE LOCK FOR SLIDING DOOR



14

MULTI PURPOSE LOCK - ROUND



Cranked

Straight
(Set of 12)

18

PUSH LOCK



22 23

LOCK RECEIVER PLATE BRACKET FOR BOTTOM MOUNTING DR. SLIDE & FULL PANEL DR. SLIDE



FRONT MULTI DRAWER LOCK (480MM & 580MM)



Metal Key

Size: 480, 580mm

KEYS FOR TARGET LOCKS



15

SQUARE LOCK



(Set of 12)

19

PEDESTAL LOCK



- Up to 200 combinations
- Click action mechanism
- Option of set locks
- Sheet Metal body
- Options of metal key/key with plastic cap

26

CAM LOCK



Standard



Threaded ||

16

FRONT MULTI DRAWER LOCK



20

MORTISE LOCK FOR SLIDING DOOR



24

MULTI PURPOSE LOCK - ROUND

Straight



Cranked



Metal Key

27

PUSH LOCK



17

CAM LOCK



Standard Threaded ||

21

CUPBOARD LOCK



28

PEDESTAL LOCK



Metal Key

14 - Size: 22mm. Available with Metal Key.

15 - Size : 22mm / 32mm. Available with Metal Key & Poly Carbonate Key.

16 - Size: 22mm. Height: 480mm & 580mm.

17 - Size: Standard 22mm and Threaded (16 / 25 / 30mm).

18 - Size: 22mm.

19 - Size: 22mm. Available with metal key.

20 - Size: 22mm.

21 - Available with longer key.

22 - Finish: Nickel Plated.

23 - Finish: Ivory.

24 - Size: 22mm.

25 - Size : 22mm & 32mm.

26 - Size : Standard 22mm & Threaded (16 / 25 / 30mm).

27 - Size: 22mm.

28 - Size: 20mm.

29 - Size: 22mm.



FURNITURE LOCKS

SPECIALITY LOCKS & STEEL FURNITURE LOCKS

30 SecuRite CUPBOARD LOCK



STEEL CABINET HANDLE/ STEEL CABINET LOCK CUM HANDLE



31 SecuRite DRAWER LOCK



CUPBOARD LOCK FOR - STEEL CABINET - 2



32 SLIDING WARDROBE LOCK



SLIDING DOOR LOCK || FOR STEEL CABINET (WITH HANDLE SET OF 2 NOS)



CUPBOARD LOCK - STEEL CABINET ||



30 - Size: *20mm, 23mm, *25mm, 29mm, *32mm and 35mm.

31 - Size: *16mm, *20mm, 23mm, *25mm and 29mm.

32 - Size: 19mm & 25mm

*Available in brass key only

SLIDING WARDROBE LOCK (SIDE MOUNT) L/R

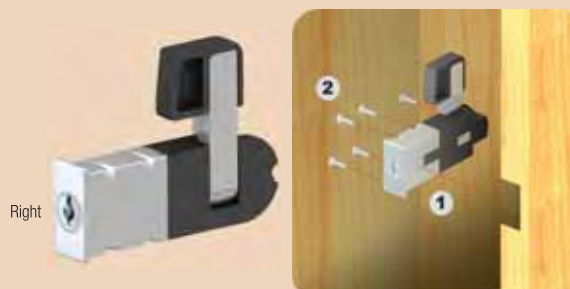

|| STEEL FURNITURE LOCKS

4 DIGIT COMBINATION LOCKS

- Four digit combination lock for keyless operation.
- Ideal Applications:
 - Corporate Office, BPOs, Banks.
 - Home Furniture - Wardrobe, Kitchen, etc.
 - Lockers - Club, Gym, Hostel, Factory, etc.
 - Retail Showrooms.
 - Display Units - Watches, Jewellery, Gadgets, etc.

- Replace any standard furniture lock to get instant keyless access.
- Once unlocked, the housing doubles as a knob; just rotate 90° to unlatch.
- The combination can be reset to any four digit number, providing up to 10000 possible combinations.
- Two levels of code setting: Combi-Public and Combi-Personal.
- Resolve forgotten secret code easily & rapidly with secret code retriever key.

4 DIGIT COMBINATION LOCK - WOOD ||



4 DIGIT COMBINATION LOCK - PEDESTAL (L/R) ||



4 DIGIT COMBINATION LOCK - STEEL CUPBOARD ||



4 DIGIT COMBINATION LOCK - WARDROBE 2 POINT INSET/OVERLAY



4 DIGIT COMBINATION LOCK - 2 POINT SWING (WITH ROD)



4 DIGIT COMBINATION LOCK - WOOD (VERTICAL) ||



4 DIGIT COMBINATION LOCK - STEEL CABINET WITH HANDLE (VERTICAL) ||



4 DIGIT COMBINATION LOCK - ZINC WOOD



4 DIGIT COMBINATION LOCK - ZINC SINGLE GLASS DOOR/ 4 DIGIT COMBINATION LOCK - ZINC DOUBLE GLASS DOOR

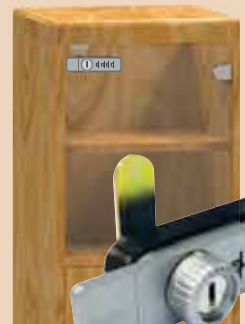

TOUCH PAD COMBINATION LOCK (WOOD / PEDESTAL) **NEW**





FURNITURE LOCKS

SPECIALITY LOCKS & STEEL FURNITURE LOCKS

OPERATING & CODE SETTING STEPS

OPERATING INSTRUCTIONS COMBI-PUBLIC

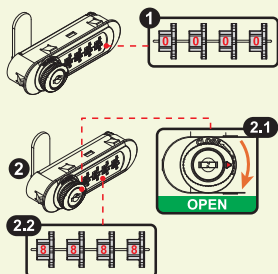

1. The preset factory code is 0-0-0-0
2. To change the secret code,
 - 2.1 Rotate the knob to **OPEN** position.
 - 2.2 The new secret code can be reset, e.g. 8-8-8-8. The process is complete.

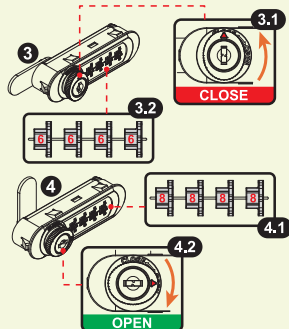

3. In order to **LOCK**
 - 3.1 Rotate the knob to **CLOSE** position.
 - 3.2 Turn the dials to any number for locking.
4. In order to **UNLOCK**
 - 4.1 Turn the dials to the previously set secret code, e.g. 8-8-8-8
 - 4.2 Rotate the knob to **OPEN** position.

Remark : The secret code for **COMBI-PUBLIC** can be reset when the lock is in **OPEN** position.



(L-BRACKET)
For 4-digit combination lock - wood

FOR METAL CABINET



FOR WOODEN CABINET



OPERATING INSTRUCTIONS COMBI-PERSONAL

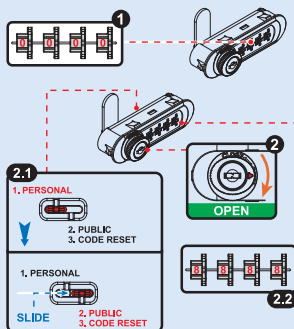

1. The preset factory code is 0-0-0-0
2. To change the secret code, rotate the knob to **OPEN** position.
 - 2.1 Slide the swap button to **3, CODE RESET**
 - 2.2 The new secret code can be reset, e.g. 8-8-8-8

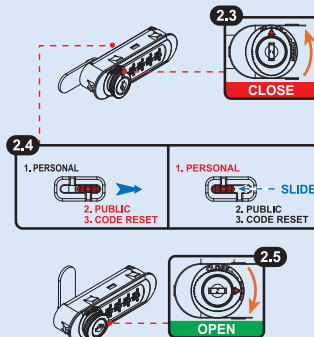

- 2.3 Rotate the knob to **CLOSE** position.
- 2.4 Slide the swap button to **1, PERSONAL**
- 2.5 Rotate the knob back to **OPEN** position to complete the process.

Remark : For Step 2, remove the cam should it obstruct the swap button.

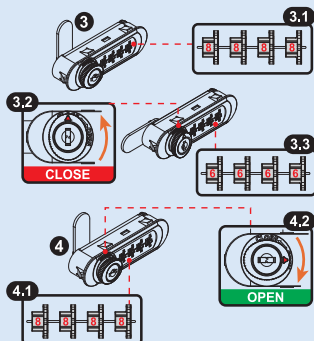

3. In order to **LOCK**
 - 3.1 Turn the dials to the set code, e.g. 8-8-8-8
 - 3.2 Rotate the knob to **CLOSE** position.
 - 3.3 Turn the dials to any number for locking.
4. In order to **UNLOCK**
 - 4.1 Turn the dials to the previously set secret code, e.g. 8-8-8-8
 - 4.2 Rotate the knob to **OPEN** position.

CODE RECOVERY STEPS

TO RECOVER THE SECRET CODE COMBI-PERSONAL

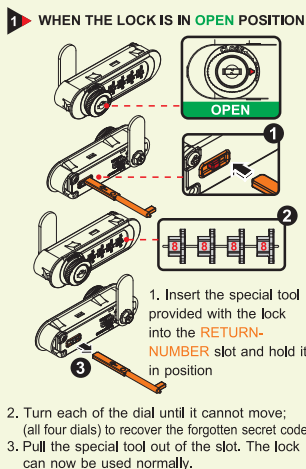

1. Insert the special tool provided with the lock into the **RETURN-NUMBER** slot and hold it in position
2. Turn each of the dial until it cannot move; (all four dials) to recover the forgotten secret code.
3. Pull the special tool out of the slot. The lock can now be used normally.

2. WHEN THE LOCK IS IN LOCK POSITION

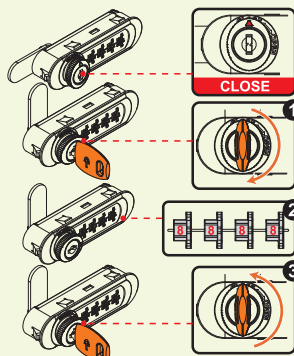

1. Insert the key into the knob and rotate it clockwise until stop.
2. Turn each of the dial until it cannot move; (all four dials) to recover the forgotten secret code.
3. Rotate the key counter-clockwise until stop and pull the key out. The lock can now be used normally.

TO RECOVER THE SECRET CODE COMBI-PUBLIC

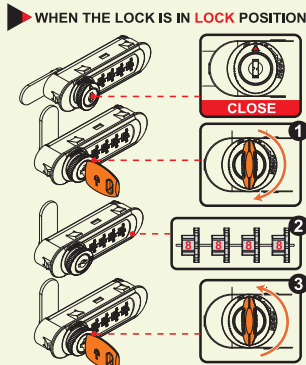

1. Insert the key into the knob and rotate it clockwise until stop.
2. Turn each of the dial until it cannot move; (all four dials) to recover the forgotten secret code.
3. Rotate the key counter-clockwise until stop and pull the key out. The lock can now be used normally.

FROM TO COMBI-PERSONAL COMBI-PUBLIC

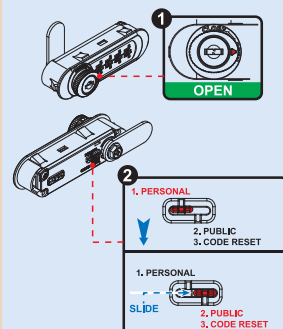

1. The lock is in **OPEN** position.
2. Slide the swap button to **2, PUBLIC** to change the function to **COMBI-PUBLIC**

Remark : For Step 2, remove the cam should it obstruct the swap button.

FROM TO COMBI-PUBLIC COMBI-PERSONAL

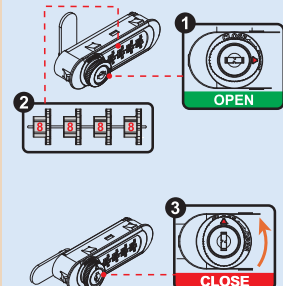

1. The lock is in **OPEN** position.
2. The secret code can be reset right away, e.g. 8-8-8-8
3. Rotate the knob to **CLOSE** position.

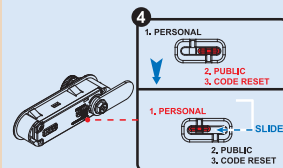

4. Slide the swap button to **1, PERSONAL**
5. Rotate the knob to **OPEN** position to change the function to **COMBI-PERSONAL**

Remark : For Step 4, remove the cam should it obstruct the swap button.



POLE SHELVING SYSTEM

FEATURES

- This versatile Display System is equally suited for brand retail stores (Clothing, Apparels, Department) as well as walk-in wardrobes at home.
- It's highly flexible design enables to change the combination / layout of display without actually removing the pole systems installed.
- Multiple Adapter brackets can be chosen for Hangers, Shelves, Cabinets, Tilting Shelves, etc as per your desired application.
- Aluminium sections and die cast parts ensures strength and stability.
- Flexibility to mount the pole from floor to wall / ceiling as per the design requirement.

POLE SHELVING SYSTEM



Right Angle Connector



Small Shelf Support



Oval Rail Support

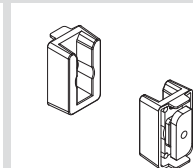

Rectangular Rail Support



Big Shelf Support



Tilting Shelf Bracket



Aluminium Section



Height Adjustable Plinth



End Connector Set

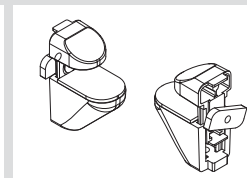

Adjustable Glass Shelf Support for Pole Shelving System

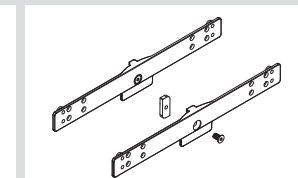

Concealed Slide Adaptor for Pole Shelving System

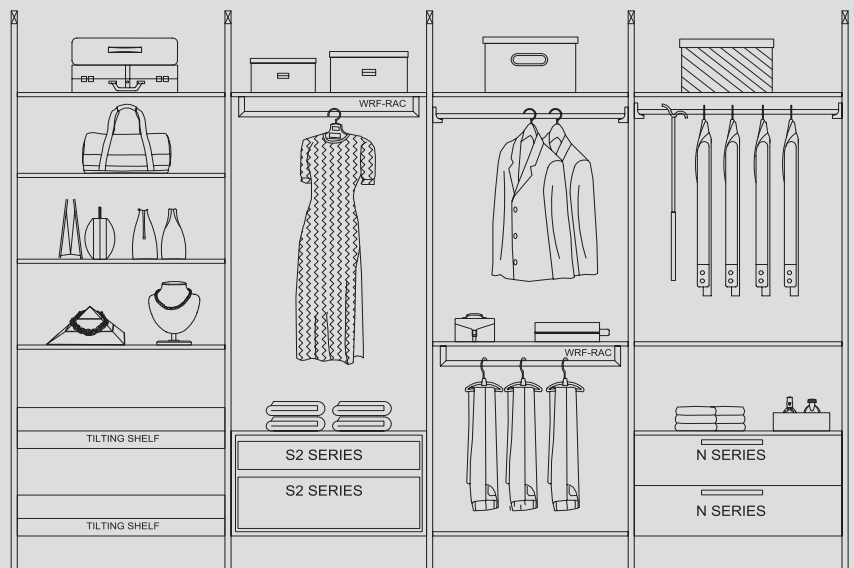



RETAIL DISPLAY SYSTEMS

DISPLAY SHELVING SYSTEM - VERTICAL

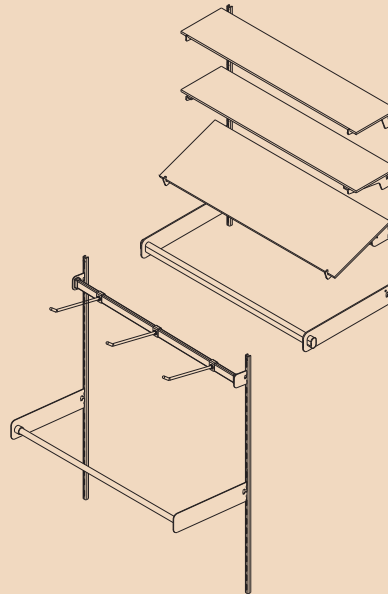

- Elegantly designed to suit different needs.
- Available in a variety of models and sizes.
- It is ideal if you have different items to display from time to time.
- Specially designed to impart maximum strength and to eliminate play.
- A unique stabilizer screw and nut holds the shelf in place.
- Available with an Aluminium Track for light weight load and Steel Track for heavy load.
- The tracks which support the shelves are screwed on to the wall, so that they blend well with the decor.
- Available for glass, wood shelves and hanger systems.
- Track, Wood Shelf Bracket, Glass Shelf Bracket, Hanger Holder Brackets, Hanger Rack, Rod Bracket and Glass Shelf Support with Screw & Nut are also available in SS304.

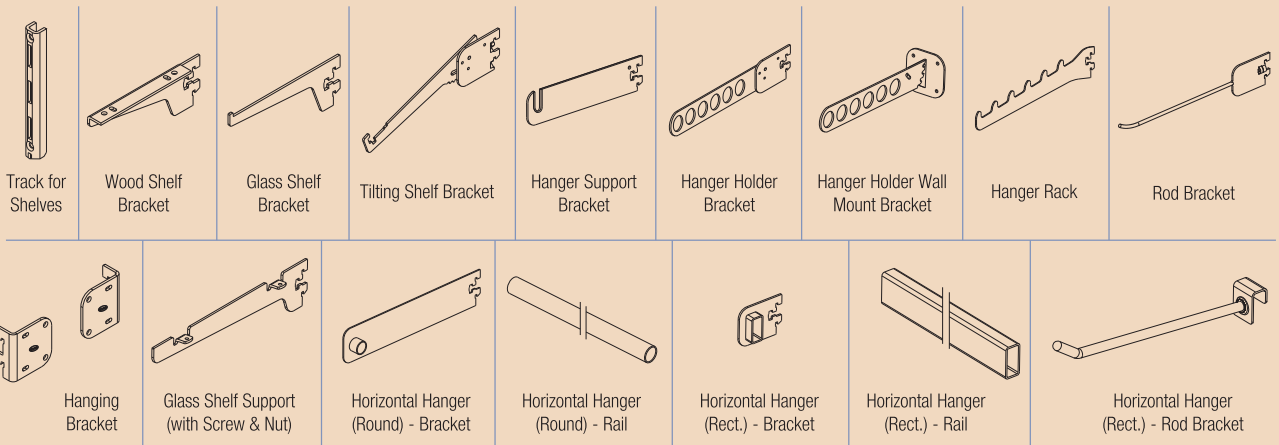

DISPLAY SHELVING SYSTEM - HORIZONTAL

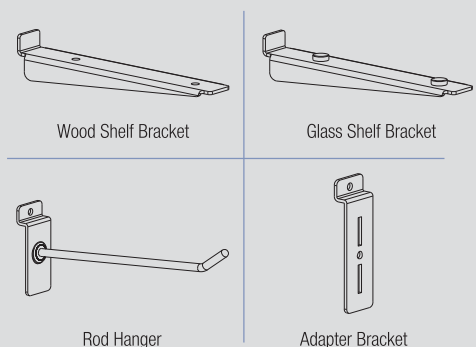

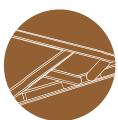

01 FRICTION STAY - HI LOAD (SS304)



FEATURES

- Made of AISI 304 stainless steel.
- Pressure adjustable brake for stopping.
- Can be used for side hung horizontal axis opening ventilators, as well as top hung vertical axis opening windows.
- Stack Height - 15mm
- Applicable in wooden, aluminium or UPVC windows.
- Self cleaning design.
- Also available in independent left and right hand working for better closing and alignment.
- Load capacity: 21-30Kg

02 FRICTION STAY SS304



Load Capacity: 10-40 kg.
Stack Height: 8": 15mm,
16"-28": 18mm

03 FRICTION STAY 2221 FRICTION STAY 2221 (Bevelled) (SS304)



Load Capacity:
12" - 25kg, 14" - 30kg
Stack Height: 21mm.

04 FRICTION STAY 1319 (SS304)



Load Capacity:
10" - 18kg, 12" - 22kg,
14" - 25kg
Stack Height: 19mm.

05 CONCEALED CORNER HINGE 80 / 120



Load Capacity: 80/120 kg.
Stack Height: 20mm

06 FRICTION STAY HEAVY DUTY (SS304)



Load Capacity: 80 kg.
Stack Height: 16.5mm

07 FRICTION CATCH (SS304)



10 WINDOW HANDLE



08 WINDOW HANDLE - EURO



11 WINDOW HANDLE - HEAVY



09 EURO HANDLE - 4 HOLE



01 - Size: 10", 12", 14" **02** - Size : 8", 16", 20", 24", 28" **03** - Size : 12", 14" **04** - Size : 10", 12", 14". **05** - Load : 80/120 Kgs. **06** - Size : 20", 24", 28". **07** - Size : 8", 10", 12". **08** - Finish: Brown/Black/Window White/ Silver/White Matt/ Champagne Gold. **09** - Finish: Brown/ Black/Window White/ Silver/White Matt/ Champagne Gold. **10** - Finish: Brown/ Black/Window White/ Silver/White Mat/ Champagne Gold. **11** - Finish: White/ Black.

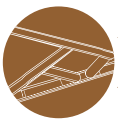

WINDOW, DOOR & GLASS HARDWARE

12 ALUMINIUM WINDOW HANDLE - DELUXE



13 ALUMINIUM WINDOW HANDLE - DELUXE 2



14 WINDOW-DOOR HANDLE WITH PUSH LATCH



15 RECESSED MORTISE HANDLE



12 - Finish: White/Silver/ **13** - Finish: White/ Black. **14** - Finish: White/ Black. **15** - Finish: White/ Black. **16** - Finish: White/Black. **17** - Finish: Black. **18** - Finish: White/ Black. **19** - Finish: White/ Black. **20** - Finish: White/ Black. **21** - Size: Big-36mm x 13.5mm thk. Small-22mm x 10.4mm thk. **22** - Finish: White/ Black. **23** - Finish: White/Brown/Grey/Black. **24** - Finish: Brown/Black/ Window White/Silver/Champagne Gold. **25** - Finish: Window White/ Black/ Champagne/Brown. **26** - Finish: Window White/Black/ Champagne/ Brown. **27** - Finish: Brown/Black/ Window White/ Silver/Champagne Gold.

16 MORTISE WINDOW HANDLE -3



17 MORTISE WINDOW HANDLE WITH LOCK



18 MORTISE WINDOW HANDLE WITH LOCK 3



19 MORTISE WINDOW HANDLE - SHORT NECK



20 ALUMINIUM DOOR HANDLE



21 ALUMINIUM CORNER CLEAT



TRANSMISSION LOCK STRIP FOR SWING DOORS / SLIDING DOORS



For Swing Doors For Sliding Doors

- Available in three lengths with two & four locking points.
- Can be used for both left & right hand locking windows.
- Compatible with ebco Mortise Window Handle with Lock (AWH-DML1)

CONNECTOR ROPE FITTING



CRESCENT LATCH



22 CRESCENT LATCH 3



23 SLIDING WINDOW LOCK 1925



SLIDING WINDOW LATCH CATCHES

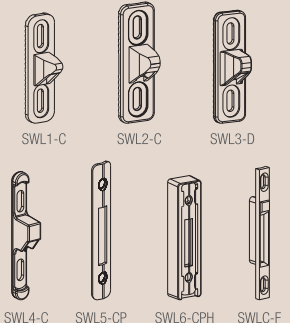

24 SLIDING WINDOW LATCH



25 SLIDING WINDOW LATCH - CLICK FIT



26 SLIDING WINDOW LATCH - CLICK FIT LONG



27 SLIDING WINDOW LATCH - EASY



PRESTO - DOOR KNOB LOCK PRESTO



AVAILABLE FINISHES



AT



CP



NS

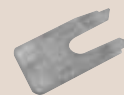

Opening Tool



TO OPEN:
SIMPLY PRESS DOWN
ON THE TOP CAP



TO CLOSE:
LET GO OF THE TOP CAP

BORING KIT FOR PRESTO LOCK



Size : 23mm & 42mm

- Door knob with push button locking.
- Press button to latch from inside until unlocked by key or by inside knob.
- Separate opening tool available for unlocking.
- Dimpled keys.
- For 30-45mm door thickness.
- 1,00,000 cycles tested.
- Available in Anthracite, Chrome Plated, Nickel Plated Satin, Antique Brass & Brushed Steel.

MORTISE DOOR LOCK SET / SET2 - ECO



- Keyless for (Bathroom) and One Side Key for (Bedroom) version.
- Easy reversible latch. Key can be removed easily in locked and unlocked position.
- Suitable for swing door, wood and metal doors.
- Steel Handle Case.



Unlocked

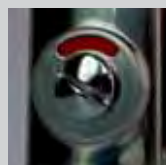

Locked

SLIDING DOOR LOCK - WOOD, ALUMINIUM -
1 WAY KEY, 2 WAY KEY.
SWING DOOR LOCK - WOOD, ALUMINIUM.



Sliding Door Lock



Swing Door Lock

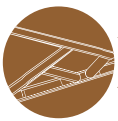

SLIDING DOOR FITTING

WOOD SLIDING FOLDING FITTING

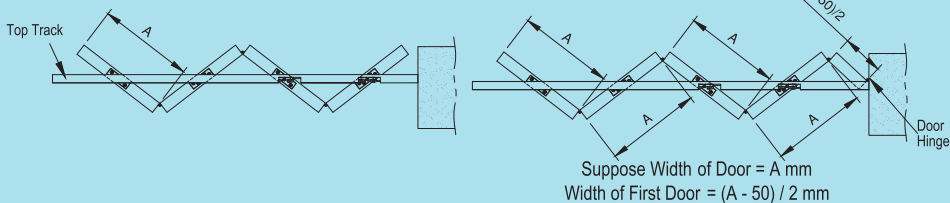
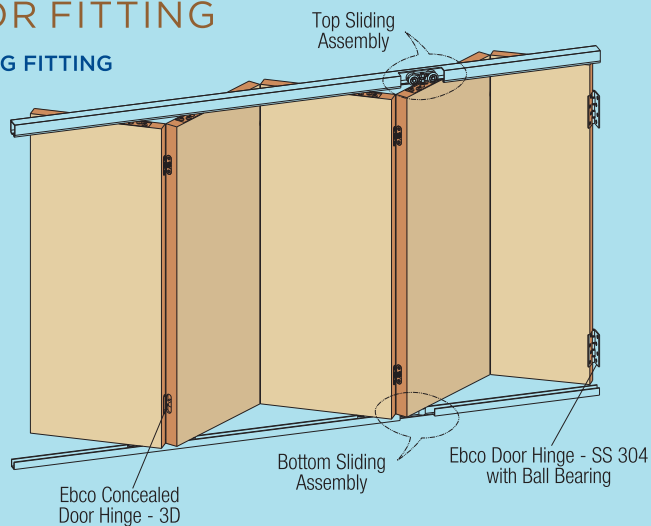
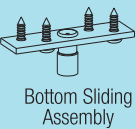
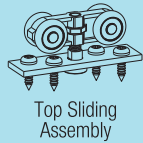

SLIDING DOOR FITTING 100 SOFT CLOSE



SLIDING DOOR FITTING 60 SOFT CLOSE & AUTO RETURN



SECURITY DOOR LATCH



DOOR LATCH SS 304



TURN LATCH



SECURITY DOOR LATCH

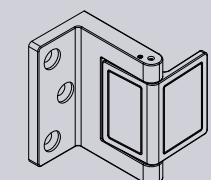

SLIDING DOOR FITTINGS - STANDARD

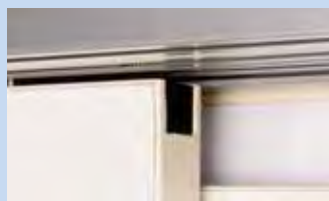

SLIDING DOOR FITTINGS - FLUSH



SLIDING DOOR FITTINGS - GLASS



SOFT CLOSE KIT FOR SDF 125

- 28** • Made out of SS304, the hinges are designed with precision ball bearings.
- Built for long life and smooth working.
- Suitable for doors of different sizes and weight.
- 29** • Ideal for flush wooden door applications.
- 3-dimensional adjustment function allows vertical, horizontal and depth adjustment after hinge is installed.
- 300,000 cycles tested.
- Cover hides all screw for aesthetic looks.
- Max door weight (for 2 hinges) - 40/80/120/80 Kgs
- Min door thick - 35/40/45/40 mm
- Max Door Width-850/1000/1400/1000 mm

28 DOOR HINGES - SS 304



29 CONCEALED HINGE - 3D & 2D



Models-CH3D-40/CH3D-80/
CH3D-120/CH2D-80WD

- Single slide with bi-directional soft closing /automatic door closing function.
- Quick fit door installation and release.
- Adjustable soft closing speed and travel according to the door weight.
- Maximum soft closing travel: 115mm.
- Weight Capacity: 100kg (SDF 100 SC) & 30-60kg (SDF 60 SC AR)
- Door Thickness: Min. 30mm.
- Door Height Adjustment: ± 3 mm with Quick Release Base.

FLOOR SPRING & ACCESSORIES

FLOOR SPRING - 84

- 10,00,000 cycle tested
- Universal Application – Load Adjustment From: 80kg -100kg (For DFS 84-100C model) and 100kg - 130kg (For DFS 84-130C model)
- Max. Door Width: 1000mm (For DFS 84-100) and 1100mm (For DFS 84-130).
- Max. Opening Angle - 130°
- 90° Hold Open Angle

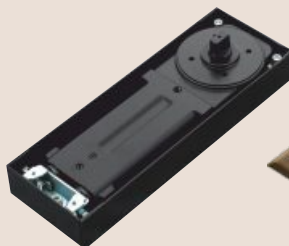

DFS 84-100C



DFS 84-130C



FLOOR SPRING - 75V

- 5,00,000 cycles tested
- Universal application - Load adjustment from 60 kg to 150 kg
- Door Width - 600 - 1100mm
- Max opening angle - 360°
- Hold Open function at any point between 90° to 105° and -90° to -105°



30 FLOOR SPRING - 60



31 FLOOR SPRING - 90



32 FLOOR SPRING - 250



FLOOR SPRING DOOR ACCESSORIES DFS-A1

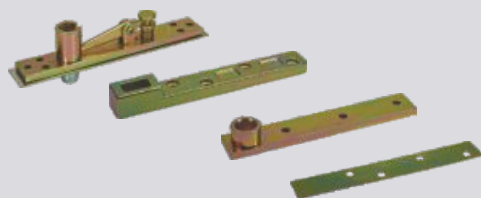

FLOOR SPRING DOOR ACCESSORIES DFS-A2



33

BOTTOM PIVOT



34

TOP PIVOT



30 - 5,00,000 cycle tested. Max. open angle : 116°. Hold open angle: 90° Max. Door Width : 700mm. Max. Door Weight: 60 kgs. **31** - 5,00,000 cycle tested. Max. open angle : 116°. Max. open angle: 90° Max. Door Width : 1000mm. Max. Door Weight : 90 kgs. **32** - 5,00,000 cycle tested. Door Width : 1200mm. Max. open angle : 130°. Hold open angle: 90° **33** - To be used directly on the floor without floor spring. **34** - Top receiver pivot for wooden or ceiling installation.

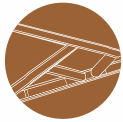

WINDOW, DOOR & GLASS HARDWARE

DOOR CLOSERS



35 DOOR CLOSER - DC 101
DOOR CLOSER - DC 101-B



36 DOOR CLOSER - DC 201
DOOR CLOSER - DC 201-B
DOOR CLOSER - DC 201-C

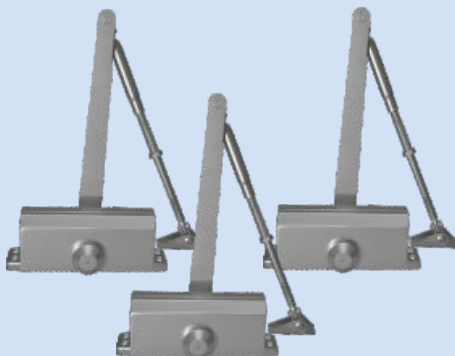

DC 201-C



37 DOOR CLOSER - DC 301
DOOR CLOSER - DC 301-B



38 DOOR CLOSER - PELMET ARM



39 DOOR CLOSER - DC 1001



40 DOOR CLOSER - DC 1002



35 - DC 101 Door Width : 600-850 mm. Door Weight : 65 kgs. Type : Hold Open. Opening Angle : 180°. **DC 101-B** Door Width : 600-800 mm. Door Weight : 45 kgs. Type : Without Hold Open. Opening Angle : 180°. **36** - **DC 201** Door Width : 800-1050mm. Door Weight : 85 kgs. Type : Hold Open. Opening Angle : 180°. **DC 201-B** Door Width : 600-900mm. Door Weight : 65 kgs. Type : Without Hold Open. Opening Angle : 180°. **DC 201-C** Door Width : 1050mm. Door Weight : 85 kgs. Type : Without Hold Open. Opening Angle : 180°. **37** - **DC 301** Door Width : 900-1200mm. Door Weight : 105 kgs. Type : Hold Open. Opening Angle : 180°. **DC 301-B** Door Width : 1000mm. Door Weight : 85 kgs. Type : Without Hold Open. Opening Angle : 180°. **38** - Door Width : 500 - 1000mm. Door Load Capacity: 30 - 80 kgs. Type : Hold Open. Opening Angle : 130°. 3,00,000 cycle tested. **39** - Door Width : Up to 850mm. Door Weight : 65 kgs. Type : Hold Open. Opening Angle : 180°. **40** - Door Width : Up to 1000mm. Door Weight : 85 kgs. Type : Hold Open. Opening Angle : 150°.

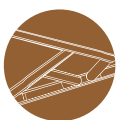

WINDOW, DOOR & GLASS HARDWARE

PATCH FITTINGS (SS 304)

Glass Thickness: 8 - 12mm
Finish: Brushed Steel

BOTTOM CORNER PATCH

DPF1-01



TOP CORNER PATCH

DPF1-02



CORNER 'L' PATCH WITH PIVOT

DPF1-04



CENTRE LOCK

DPF2-01



STRIKE PATCH FOR CENTRE LOCK

DPF2-02



SINGLE CONNECTOR PATCH

DPF3-01



CORNER 'L' PATCH WITHOUT PIVOT

DPF3-02



PATCH FITTINGS

Finish: Brushed Steel

OVER PANEL PATCH WITH PLATE

DPF1-03



QUAD CONNECTOR PATCH

DPF3-03



DOUBLE CORNER PATCH

DPF3-04



AUTO CLOSING PATCH

DACP1-100



GLASS DOOR LOCKS (SS 304)

Finish: Brushed Steel
Glass Thickness: 10mm -12mm

OPENABLE GLASS DOOR LOCK - GLASS TO WOOD - SS304



OPENABLE GLASS DOOR LOCK - GLASS TO GLASS - SS304



OPENABLE GLASS DOOR LOCK - GLASS TO GLASS - SS304 - KNOB



SLIDING GLASS DOOR LOCK - GLASS TO WOOD - SS304



SLIDING GLASS DOOR LOCK - GLASS TO GLASS - SS304



SHOWER HINGES (SS 304)

Glass Thickness: 8 - 12mm
Max. Load: 54kgs.
Finish: Brushed Steel/ Polished SS

SHOWER HINGE 90° (WALL TO GLASS) - T TYPE



SHOWER HINGE 90° (WALL TO GLASS) - L TYPE



SHOWER HINGE 135° GLASS TO GLASS



SHOWER HINGE 180° GLASS TO GLASS



SHOWER HINGE 90° GLASS TO GLASS



GLASS DOOR HANDLES (SS 304)

Finish: Brushed Steel

41 DOOR HANDLE - D



42 DOOR HANDLE - H



41 Sizes		Hole to hole
ØDia(mm)		ØDistance(mm)

Ø19mm	X	250mm
Ø22mm	X	300mm
Ø25mm	X	450mm
Ø32mm	X	600mm

42 Sizes		Hole to hole
ØDia(mm)		ØDistance(mm)

Ø22mm	X	150mm
Ø25mm	X	200mm
Ø25mm	X	300mm
Ø32mm	X	450mm
Ø32mm	X	750mm

SHOWER FITTINGS Finish: Brushed Steel/SSS/ Polished SS

**WALL TO TUBE
CONNECTOR -
19MM**



**TUBE TO GLASS
CONNECTOR -
19MM**



**TUBE TO TUBE
CONNECTOR -
19MM**



**SHOWER ROD
Ø 32 X 24**



**SHOWER
DOOR
KNOB**



**DOOR HANDLE -
DIA 19MM X 150MM X
450MM**



**DOOR
STOPPER**



PLASTIC SEALS

43

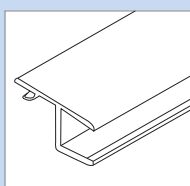

**PVC SEAL
BPS1-10**

44

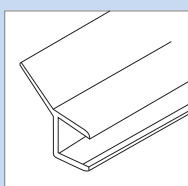

**PVC SEAL
BPS2-08/10/12mm**

45

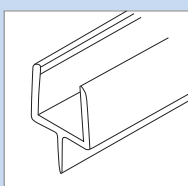

**BOTTOM PVC SEAL
BPS3-08/10/12mm**

46

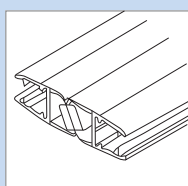

**180° MAGNETIC SEAL
BPS6-M08/M10/M12mm**

47

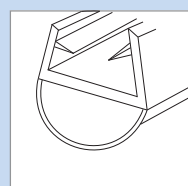

**PVC SEAL
BPS7-S08/S10/S12mm**

48

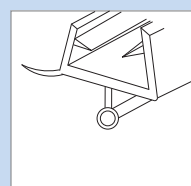

**PVC SEAL
BPS8-D08/D10**

SHOWER SLIDING FITTINGS - RECTANGULAR

- Made out of SS304
- Max. load - 60kgs.
- Suitable for 8mm to 10mm glass thickness .
- Max. installation length 2 mtrs.
- Glass to be toughened after making the holes.



SLIDING GLASS DOOR HANDLE

49

**SLIDING GLASS DOOR
HANDLE - SS304**



SGD1 BS/PS

50

**SLIDING GLASS DOOR
HANDLE - ALUMINIUM**



SGD2 AP



SGD3 AP

- 43** - BPS1-10mm. Glass Thickness: 10mm.
44 - BPS2-08/10/12mm. Glass Thickness: 8mm - 12mm. **45** - BPS3-08/10/12mm. Glass Thickness: 8mm -12mm. **46** - BPS6-M08/M10/M12. Glass Thickness: 8mm -12mm. **47** - BPS7-S08/S10/S12. Glass Thickness: 8mm -12mm. **48** - BPS8-D08/D10. Glass Thickness: 8mm -10mm. **49** - Glass Thickness: 8mm -12mm. Finish: Brushed Steel/Polished SS. **50** - Glass Thickness: 8mm - 12mm. Finish: Aluminium Polished.

DISTRIBUTION NETWORK

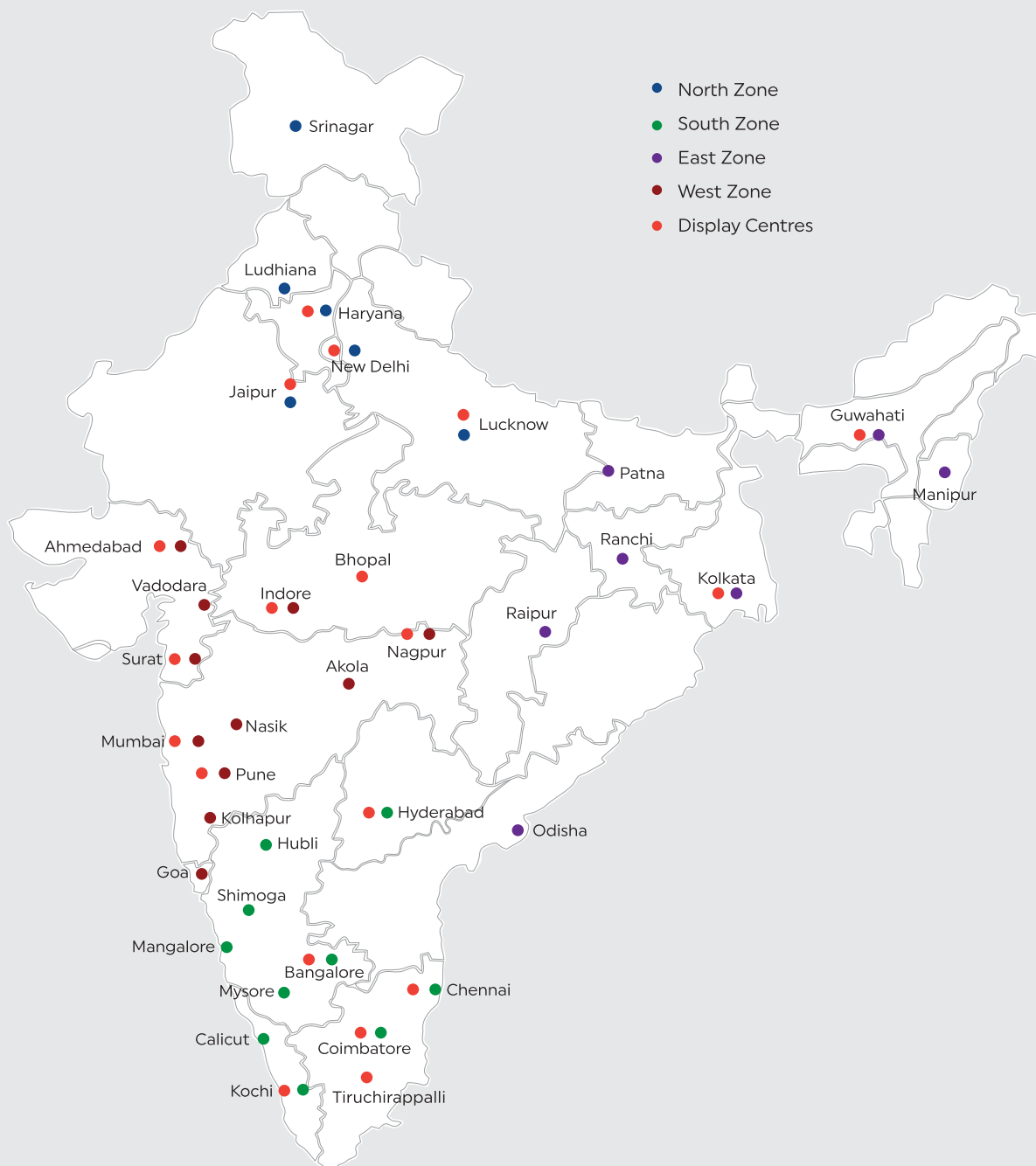

EBCO Pvt. Ltd.

402 - 403 / 502, Hyde Park, Saki Vihar Road, Mumbai - 400072, India. Tel.: +91-22 67837777 | Fax: +91-22 66920700 | Email: info@ebco.in

National Display Centres: **Ahmedabad:** 079-26880478 | **Bangalore:** 080-25503372 | **Chennai:** 044-24611937 | **Cochin:** 0484-2333394 | **Coimbatore:** 0422-2548316 | **Delhi:** (Moti Nagar) 011-49843306, (Okhla) 011-29834285 | **Guwahati:** 09435111409 | **Hyderabad:** 040-23557252 | **Indore:** 06262875491 | **Jaipur:** 0141-2390773 | **Kolkata:** 033-46034171/72 | **Lucknow:** 09506464066 | **Mumbai:** 022-67837700 | **Nagpur:** 0712-2221637 | **Pune:** 020-26456787 | **Surat:** 0261-2234677.