

ESmart Digital Lock - Cabinet 1P - RFID Code: ESDL-C1P-R

CARD INTRODUCTION

MANAGEMENT CARD (NEED TO SET IT UP FIRSTLY):



Each lock can set up one management card only. It is mainly for authorizing to set up, delete user card and switch mode. This card can only be used to unlock the door as emergency use when it is under the public mode.

USER CARD (THE KEY OF THE CARD):

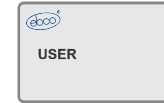

The user card is to lock or unlock. It is capable for storing 49 user cards per lock.

BUTTON INTRODUCTION

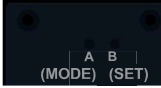

BUTTON A/MODE: Mode switch button (Swipe the management card first and then short press button "A" to switch the mode.)

BUTTON B/SET: Replace management card and set up the new user card

MODE INTRODUCTION

- **MANUAL-LOCK MODE ("BEEP" SOUND):** Door will stay unlock until user card touch the sensor.
- **AUTO-LOCK MODE ("BEEP BEEP" SOUND):** Door will be locked after 6 seconds.
- **PUBLIC LOCKER MODE (ONE-TIME USE MODE "BEEP BEEP BEEP" SOUND):** When a card is swiped and detect with the card, the door will stay locked until the same card swipes again to unlock. The locker will be available for the next user. Once the management card is swiped to unlock, the registered card will be disable and erased at the same time.

LOW VOLTAGE ALARM

- When the voltage is down to 3.8V, there are red light flash 3 seconds and "beep beep beep beep" warning sound. Swipe the card to unlock the door and still have the alarm sound every hour. Please change new batteries immediately.
- When power is gone, the door latch will not retract automatically. Please take external power supply for emergency use



WARNING

- PLEASE TEST THE LOCK IF IT CAN WORK BEFORE CLOSE THE DOOR
- PLEASE USE NEW AAA ALKALINE BATTERIES
- VOLTAGE INPUT CANNOT BE MORE THAN 6.5V

USER INSTRUCTION ** Please keep door open when set up/ delete the card ** Do not use management card to lock or unlock

SET UP / REPLACE MANAGEMENT CARD



SET UP A USER CARD

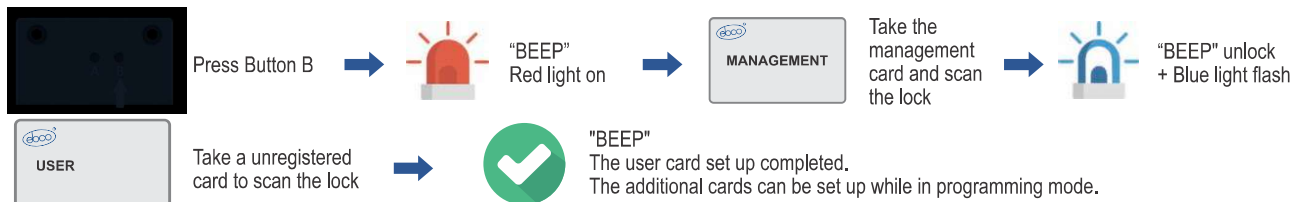

DELETE AN INDIVIDUAL USER CARD

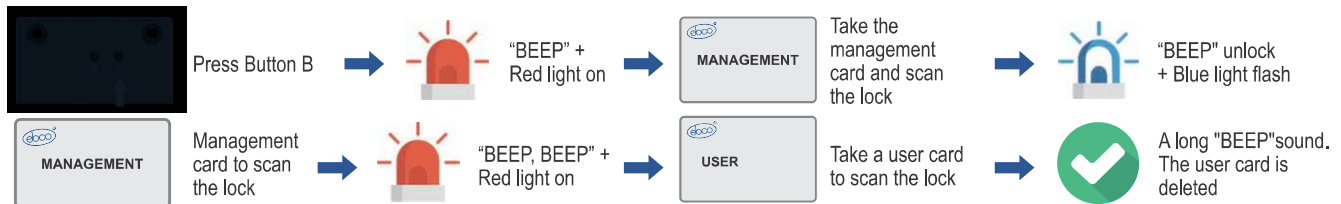

DELETE ALL USER CARDS

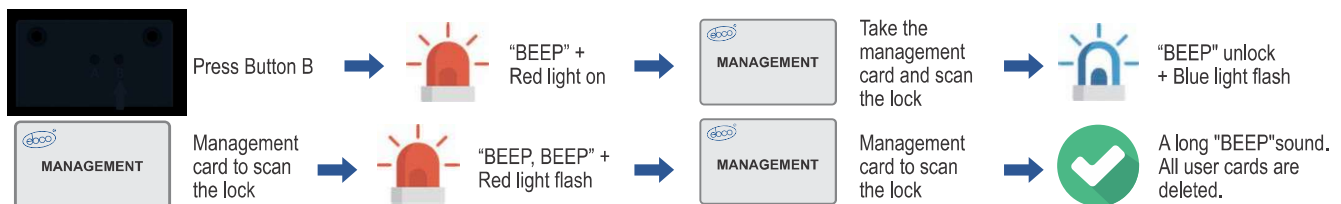

UNLOCK



LOCK

